





**WARNING**



ENTERED BY  
UNAUTHORIZED PERSONS

IN MEMORY OF  
RICHARD M. PROCTER  
1915 - 1941



THIS CHANCEL IS ERECTED TO THE GLORY OF  
GOD AND IN MEMORY OF RICHARD WADDELL  
ESQUIRE, OF RYLSTONE, WHO BECAME AID TO THE  
SUM OF £1000, TOWARDS THE REPAIRS OF  
THIS CHURCH.   
HE DIED 19<sup>TH</sup> MARCH, 1850. 

TO THE GLORY OF GOD  
AND IN LOVING MEMORY OF  
CHARLES HENRY LOWE, M.A.  
RECTOR OF RYLSTONE 1891-1932.  
CANON OF ST WILFRID IN BRADFORD CATHEDRAL.  
RURAL DEAN OF SKIPTON FROM 1923.  
BORN AUGUST 10<sup>TH</sup> 1863, DIED MAY 27<sup>TH</sup> 1932,  
BURIED AT STAMFORD, LINCS.

*I thank my God upon every remembrance of you. PHIL.1.13.*

1/2 BDR RICHARD...  
DRIVER CURTIS WALKER: R.A.S.C.

Communion

This Part is called the  
HALL QUIRE  
and is repaired by the  
DUKE of DEVONSHIRE

VESTRY

PORCH

THE STEEPLE



HILARY CHAPEL  
1798  
Containing Three Bells

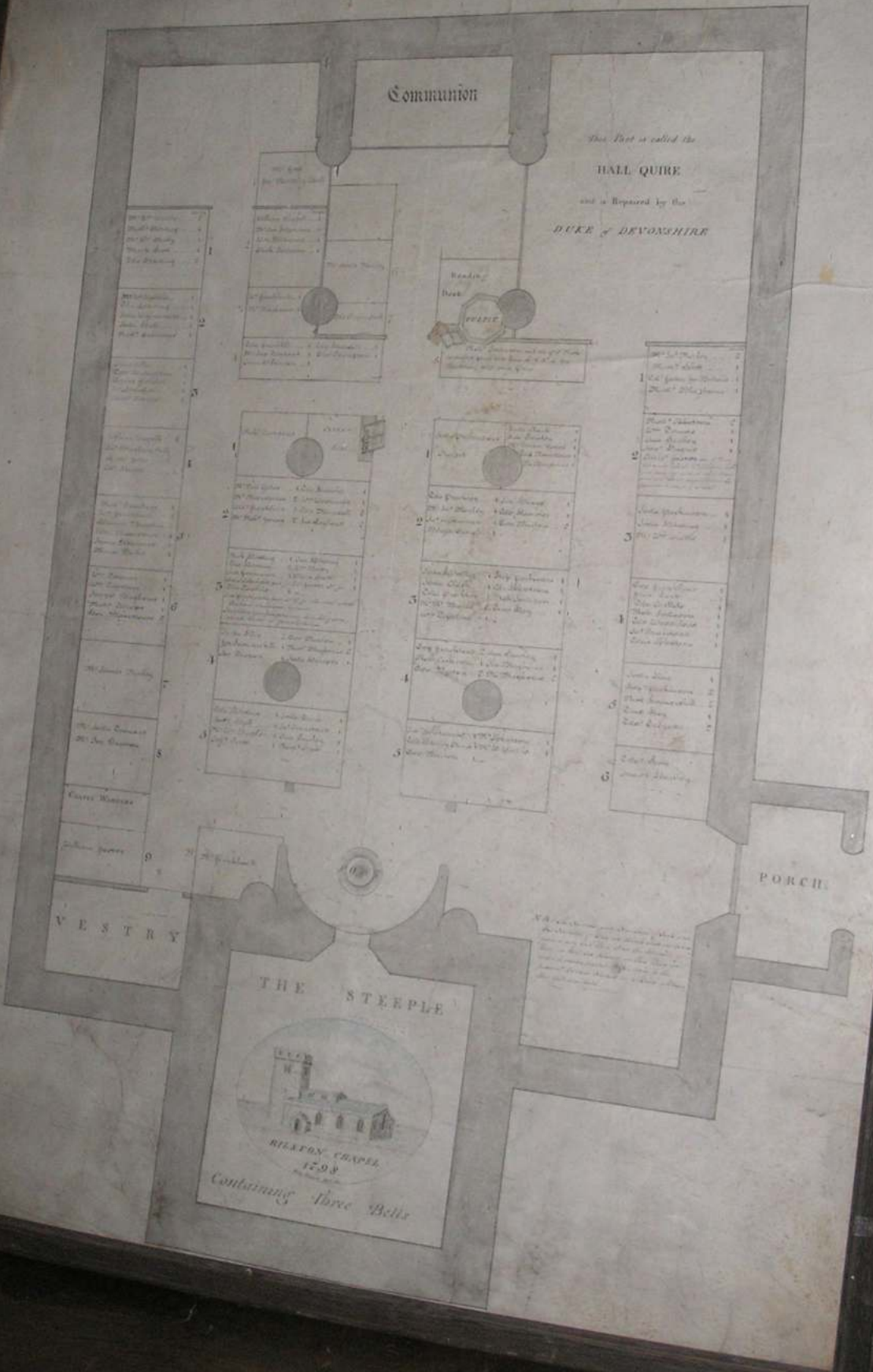

IN MEMORY OF

ELIZABETH PROCTER

Wife of Robert Procter of  
Wardley and Daughter of  
James Parkinson of Newton  
who departed this life  
the 8 Day of September  
1803 Aged 61 Years.

Also the above Robert  
Procter who departed this  
life the 25 Day of August  
1812 Aged 74 Years.

Here  
lies the Body  
of M<sup>r</sup> Susanna  
Yates wife of M<sup>r</sup>  
David Yates who  
Departed this life  
March the 7<sup>th</sup> day  
in y<sup>e</sup> 35<sup>th</sup> Year of ar  
her Age Anno  
Dom 1733

lyeth the Body  
of M<sup>r</sup> David Ya  
tes of Lainger  
house who De  
parted this Life  
Feb<sup>r</sup>y the 20<sup>th</sup>  
day in y<sup>e</sup> 35<sup>th</sup>  
Year of his Age  
Anno Dom 1733

Here  
lyeth the Body of  
Mrs Sarah Yates  
Daughter to Mr  
David and Mrs  
Sufanna Yates of  
Lainger house who  
Departed this life  
March the 29<sup>th</sup> day  
Anno Dom 1742

Mrs MARY  
WABETH  
Wife of Robt  
Boar-dley a  
James Park  
who depa  
the 8 Day  
1803 Nov  
at 80 the  
of 60 the  
Wife the  
181



Communion

This Part is called the  
**HALL QUIRE**  
and is Regard'd by the  
**DUKE of DEVONSHIRE**

- 1. Mr. [Name]
- 2. Mr. [Name]
- 3. Mr. [Name]
- 4. Mr. [Name]
- 5. Mr. [Name]
- 6. Mr. [Name]
- 7. Mr. [Name]
- 8. Mr. [Name]
- 9. Mr. [Name]



- 1. Mr. [Name]
- 2. Mr. [Name]
- 3. Mr. [Name]
- 4. Mr. [Name]
- 5. Mr. [Name]
- 6. Mr. [Name]

PORCH

VESTRY

THE STEEPLE







Several notices and posters are pinned to the bulletin board. One is orange and white, another is white with black text, and a third is blue and white.

It's still wise to follow Jesus

PROTECTED PROPERTY  
WARNING

To make public, all property in  
the church has been marked  
with the signs. The Security  
Waking Service

THIEVES BEWARE -  
YOU WILL BE CAUGHT

Thank you  
THANK YOU TO  
THANK YOU TO  
THANK YOU TO

