

1965.

AEC 1673

old

AEC 1673

Bill Lane Cottage

old Jack Taylor says his Greendane
Barn is one of Carlisle's also
the one he has near Montpelier
Hilton Lodge. Jack called it old
Marriotts because some people of
that name used to live at Hilton
Lodge.

Well, Joel

July 12th 1976

- 1 Is it a well, this was found when digging in the yard
- 2 It has water in
- 3 It to be pumped out tomorrow
- 4 Then it is to be inspected.
- 5 found today when they were cleaning up the yard.

They had filled in the old Sheep Dip Place.

It's not a well but the old Soar Tank, from the farm building that is being converted into a House

They had the Bull Doser in the yard and they pulled the concrete lid off it the hole is quite large. Then they dug a drain out to the Road.

Patrick House
conn

Kenneths
Bungalow

This they are to fill with stones for the Rain water to soak away in

This was broken a Clay Drain Pipe with a bit and you could see iron pipe in what is this

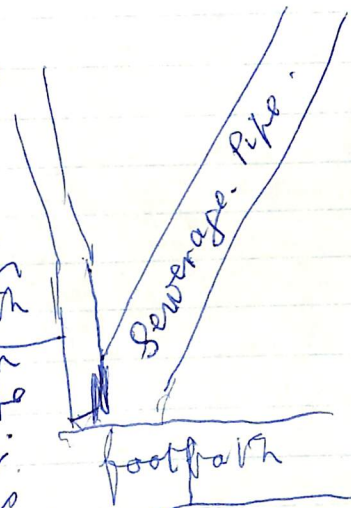

Oct. 22nd
this money

Oct 22,

The Painters are in, it's fairly getting
on now Eric and David laying
gravel for the paving in front of house
yesterday. Bulldozer brought a mountain
of soil from up the back. They
gave $\$$ some more wood.

Dec 7th ["] This week 1976

Patrick's came reset door
Dec 7th the men are strong
doing the Big wall in front of the house
and some men are busy with
the Barn at the Top making a
Garage. Last week they tar-maced
the Road down the croft which
they have been making these
last weeks. They let us
have some soil which they
brought from Sutton, Sam got
some as well.

a bit later on.
They put up a Standard Lamp so they
can see down the back.

Gill Church.

The Present Church stands upon the bank of a deep glen whence it has obtained the name of Gill Church.

The Choir from its long lancet (early English) windows three of which occupy their original position in the east end together with its slender buttresses, which run out beneath the square seems to be the identical building by which the monks replaced their own

work of havoc about the Reign of Henry III, but it has been raised and the stalls within repaired at a much later period on the northeast end of the stalls are carved

the arms of Kirkstall viz 3 swords in fess. The steeple which is strong and handsome and from its elevated situation a good

object on every side has the following date CCCC^oXXIIII intended for 1524. and

the only instance I ever observed in which the millenary numeral is omitted

but the omission was designed for the stone is evidently entire. The tower contains three

bells, the first has the legend Peace and good Neighbourhood) the second. Render therefore

Gill Church Norman Period					Whitaker History of Craven
Pages	5-8-9	11-14			
56	75	85	86	89	
94	119	224	581		

4000 years | 'nobody lives that long.

So ~~do~~ it go on till all the

family dies out or is it just
or their heir a form of speech.

It looks as if they can sign em over
to somebody else for a sum of
Money agreed on. and pay in one

Case 3 $\frac{1}{2}$ of 6 Lord of the Fees &

and knock off the years as they
go. ✓

Furnace Abbey ^{owned}
a lot of
land in
Hetton.

Stäckhouse in Settle
and had an Extensive
Estate about Ribbleshead,
at the Dissolution of Birk
they possessed of Birk
with and long gill
valued at £6. 19 years -

This card is sold in aid of the Children's Society, Old Town Hall, Kennington,
London S.E. 11. The Society helps deprived children in Britain

With best wishes for

CHRISTMAS

and the

NEW YEAR

from

Betty John & Family

The Top any more and
then it found different
tides it left different
degrees of falls etc
Such as this
Ribble Aire Wharfe Nidd

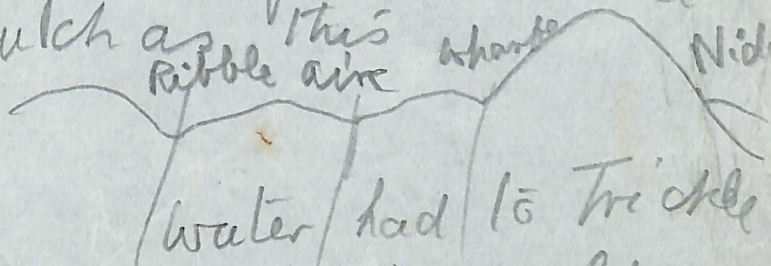

Water had to trickle
the best way it could
back to the sea thus,
it looks so to me.

Award

This is an Idea that came
to me on Feb 20, 1951.
I was thinking about the Sea
and an Island. Did
the Sea with its washings
back and two like this
form the Land from Sand
and what ever there is the
the water pile stuff

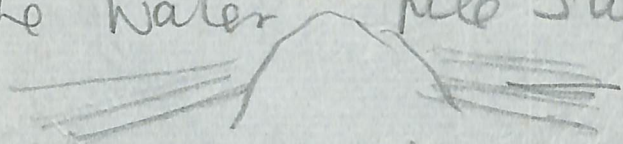

Up till it started peeling
out of the water and finally
the water couldn't reach

Smith came from
East Marston to Helton
When they returned they lived
at Rose Cottage before Harry
Reed days

Mrs Mac

Mrs Poff

Mrs Poff

Gilbert

Mary

Louise

Mary

Joe