

Note 1966

I just got a
Rough Small
Sketch of
the Past year's
Piece of Quern
Mentioned on
the Paper
with the Photo
on.

Mr Raper took
a Photo of
this last year.

Top side

The Piece of Quern
found in 1965

Knave Fell.

It fits onto the Piece found in 1966.

Read the other side first

Monday

Now what it was, there were various suggestions, I remember we saw a ~~few~~ Pond up there, so they wanted to know what a ~~few~~ Pond was, so I explained and then they went ^{up to} see what it was and how they worked, I must ask any? after they come back. yes it was a dew Pond as Raistrick said.

Whilst they were gone I thought now is the time to get a bit of drawing done, and it was nice and peaceful, and the cattle didn't come back any more I had stayed in camp to watch the stuff as the ^{young} cows are very nosy and keep coming to look at us and nibble at everything.

Monday. Aug. 1966.

We went down on to the site with Harry
in the Land Rover, and got the Rest of
our House cleaned up, ^{and} what we thought
was a hearth Stone, but ~~DR~~ decided
it was floor stone most of the
Stones were limestone, but two
beiggish ones and 1 small one
were gritstone see Drawings.
which may have been brought
from farther way. or from up the
fells higher up from the site.
When we had finished cleaning these
off, we had to get out so the
Measurers could get cracking.
After lunch, the cows all followed
the farmer down and were trampling
all in the stuff He talked to
Dr Raistrick for some time, and he
told him about a grit round
thing paved with stone he didn't

There
wasnt
any
sign
of it
have
been
seen

Monday

Great meetings up went on during the afternoon, I went for my walk after they got back, and then Mrs Raistrick, Kathy, and Mrs Waters

Came, and we had coffee

and continued to ReSoed; then we went back, and had tea I didn't bother to change till after the visitors had gone, so we could be with them

We went down and had a look at the seat they have made in memory of Paul, after we had shown them the Quem. Then I said

good day to them, and just after it threw a heavy shower, tho it had been a lovely day up till then, so

I went and got changed ready for dinner I did a bit of drawing till dinner time, The time fairly seems

to dance away, and always being the time to do something else when one has just got ^{enjoying} something ^{something}

Someone wanted to know what they wore for
shoes?

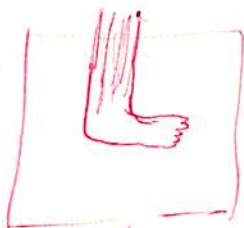

ans
Pieces of Leather
which they stood on
and wrapped round
their feet thus
and tied with a
strip of leather round
the ankle, they would
be quite comfy I
should think.

The Brothertons wished to be remembered
to you, and hope you have a
good time, ^{The} Invitation still stands for us.
Tell her we keep that piece of Calcite
on the window edge that we ^{got} at Cock-hill, that
day.

This seems to me to be the Worm Side. The Quern we left at the Field Centre with last years 2 Bits one of empty on to this one

1 side of the Quern Bottom Half

full of Quartz pebbles

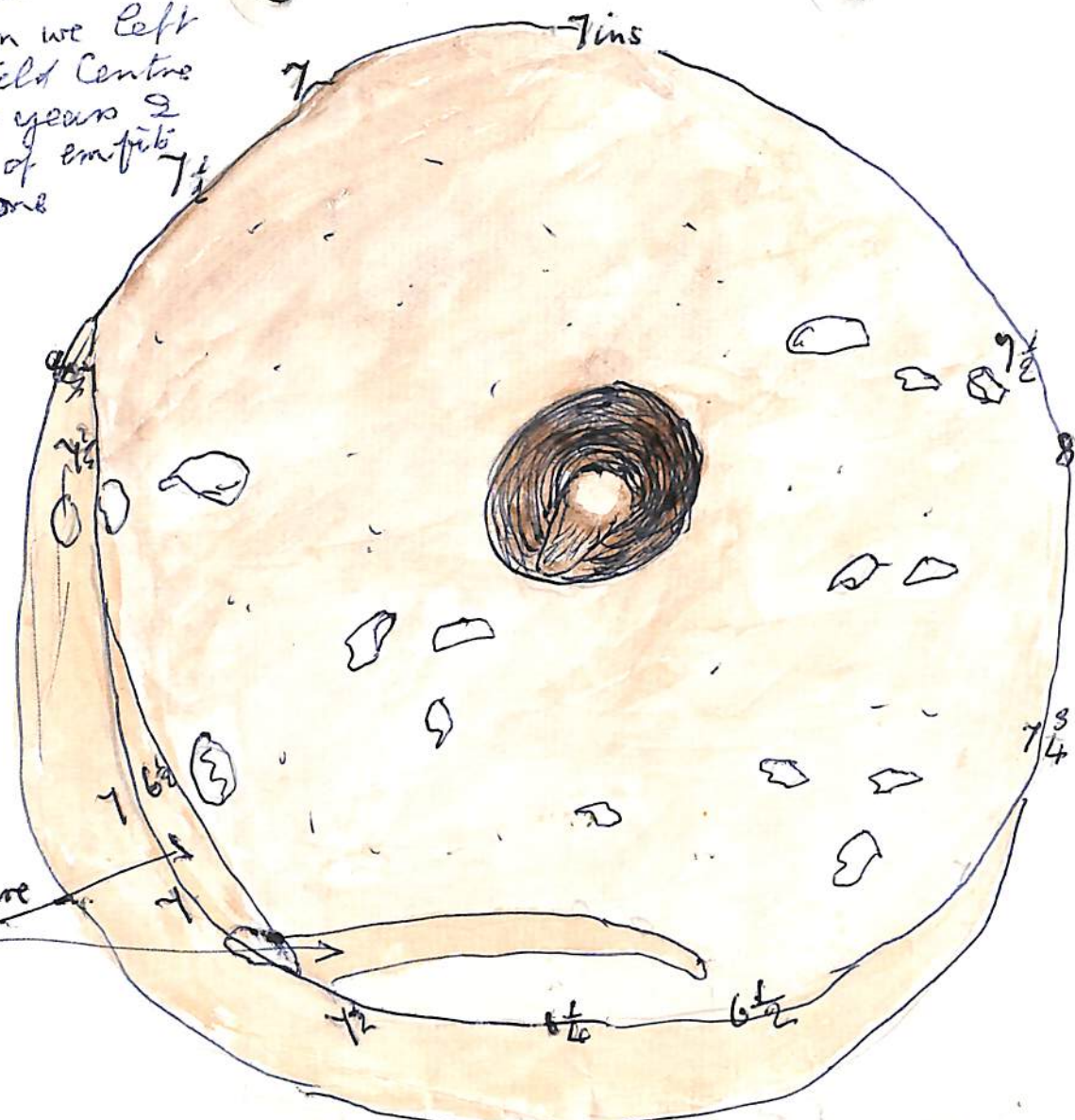

about 1 1/2 cm thick

Dents in here

Site 1

1966

The other side, to the Quern (from which I took found in Hut No. 1 the other catch) In this year's dig see drawing of Hut. Not so many pebbles showing on this side.

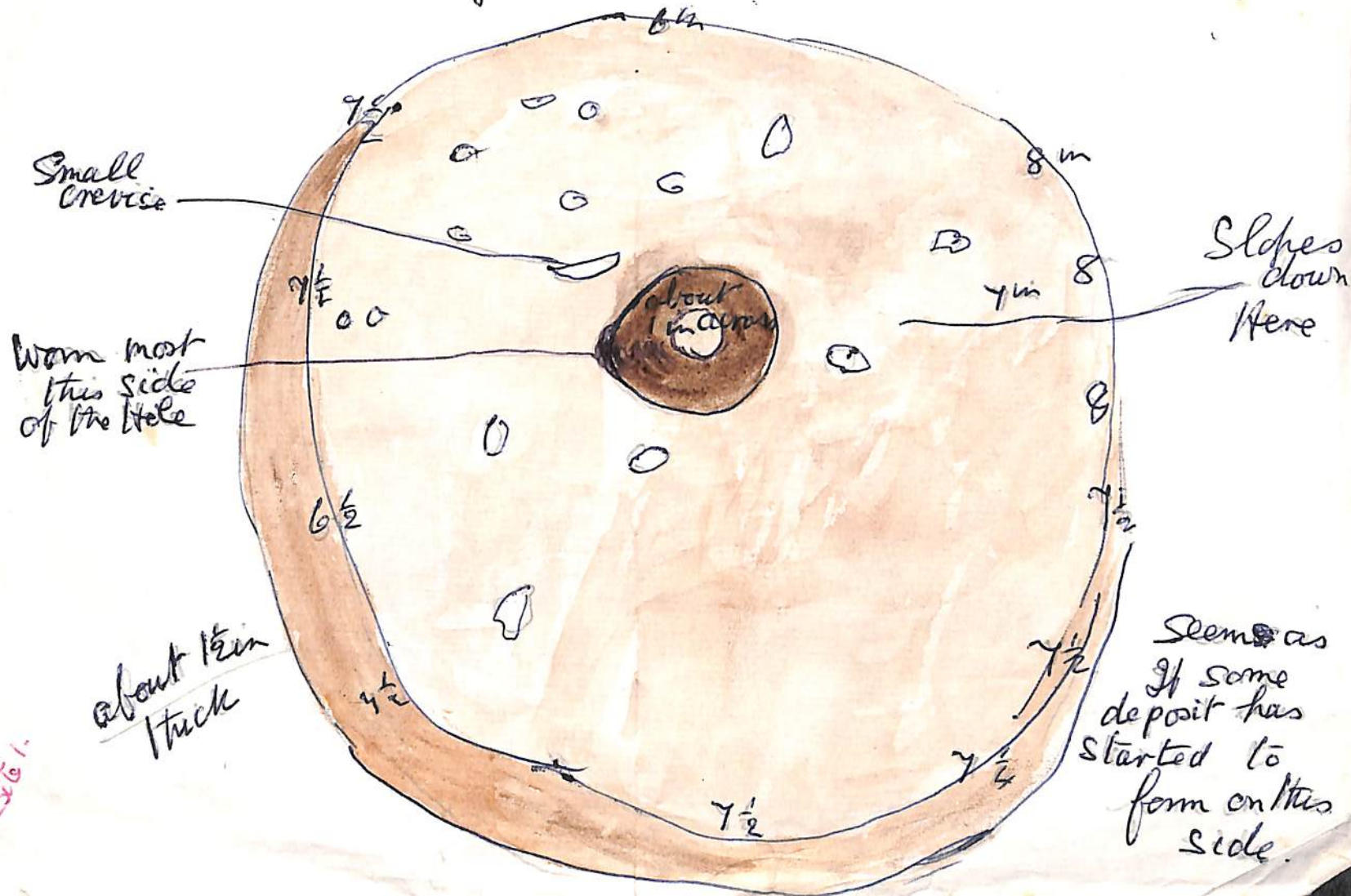

Small crevice

Warm most this side of the hole

about 1 1/2 in thick

about 1 in diam

Slopes down here

Seems as if some deposit has started to form on this side.

Fig. 1.

There are hundreds of Querns Dr R told us if they were all gathered to gether.

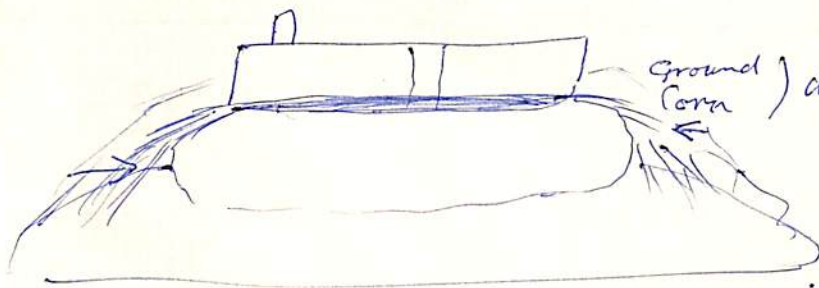

dropping outwards
they would stand
the Quern onto
a Skin very likely
they wouldn't want
Precious meal that

to waste any of the
had been ground by the Quern. Rotating
backwards and forwards by the use of the
Wooden Handle, which fits into a hole made
in the Grit Stone that is used for the Querns
Lime Stone gets to Smooth it would burn the
grain when it was ground.

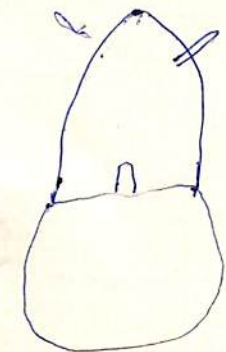

Brigantium Quern

2 Urns found at Shorkley hill
Quarried.

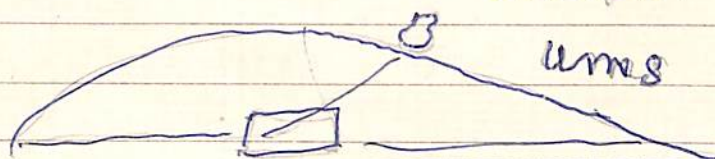

Burials
only about 5
known.

Middle Bronze age



only
about 3
known.

Iron age.

400 BC in this Country, Pastoral

Circular Hut and Craft
fairly
abundant.

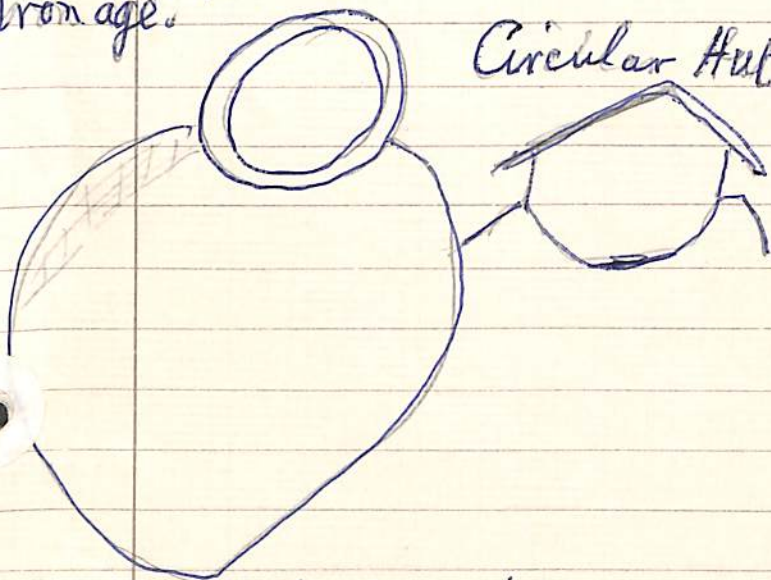

up to AD 1. Next Move was the
Bryant's hill top fort Almondbury

Bryant's

under
Caratacus

(Caratacus married Volutes) She deforced
him, and went over to the Romans
and married Volutes.

Romano British.

Archaeologists Survey; these he has been on with
with someone,?

450 AD Pottery.

from Dark Ages onwards.

Malham Tarn.

↑ Priest House · 400 AD ^{might be} 640.

Anglican.

Drawings in -

Peg Yard.

900 Norse.

Farm.

Prior Rigg 804 - 840 AD.



Pottery in Case.

Fountains Abbey took these over.

1200 - 500 BC. Late Bronze Age Farms.
 There are in South Wales. Many like ours

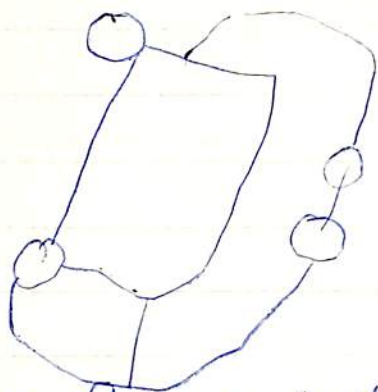

Iron Age. - end of 100 AD.
 Single Home Stead. widespread
 Population.



They are the Limestone Pasture
 They arnt on the wet land.

Where did these People live.

Huts, Structures have collapsed

and you can't really see until you dig the
 Little Soil. Frost Rain Long cold winters
 Cattle and Grain for food.

Weather
 has played
 a big
 part in
 there
 deterioration

Map the Banks
 Look for some
 sort of Pattern
 Strip Nettles
 or Turf lilyou
 get the ~~Base~~
 Surface of
 the original
 bottom Surface

Wall Passage's - we dont know What they

are

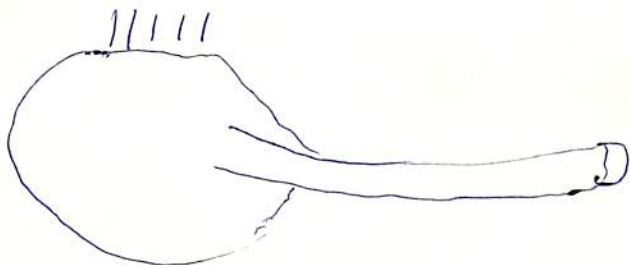

Wall Passage.

Paved. Entries.

Whetstone 2nd Century A.D.

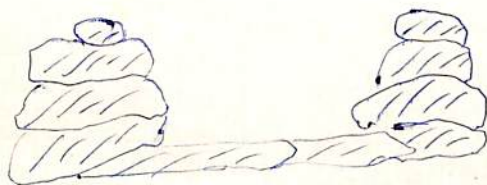
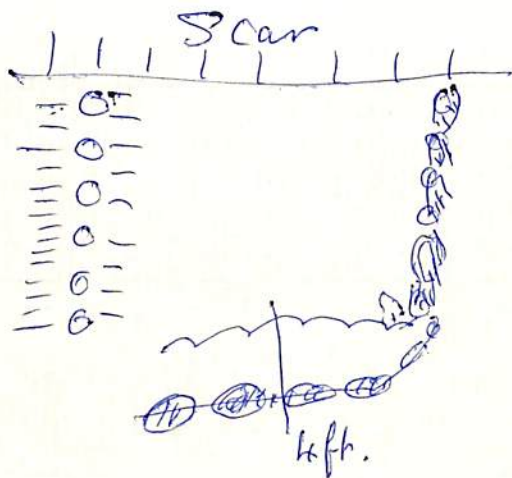

(entrance to the Wall Passage.)

ft in 2 or 2 1/2 or 2 9/16 at Most.

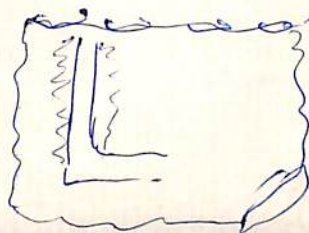

No. 1. Flint

I found this lovely little Scraper in Dwelling Place we uncovered.
No. 2 - ^{flint} also in the Dwelling ^{No. 2}. Hand 5 I found in Mole
hills quite near. these I left with the warden. I know
Some of the others found bits, but they kept em.

Piece of Flint (NO 2)

Knows Fell
Aug. 1965

Scraper

Mesolithic



underside.

Point

ii



Top



Top

2;



underside

Tool.

Top



3o



underside.

This one
had been
broken?



4o
Top



under
side

Knife Blade.



Top.

5.



Under
Side

Aug. 4-10th

Knowse Fell Dig

1966.

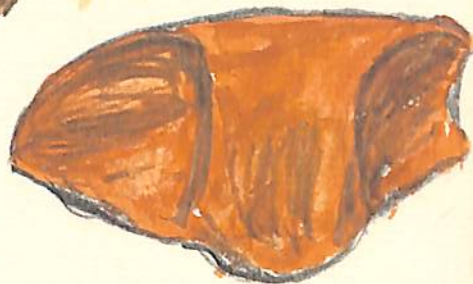

Pottery found in No 1 Site

Sites

NATIVE Quern.

These were made of local stone, they
may have copied the Roman ideas
that they would see. i.e. Gargrave Villa.

Knowe Fell 1966.

16 1/2 Diam

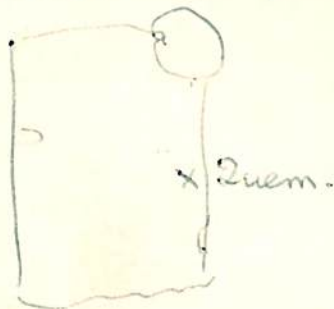

hole 1 1/4 in

Central Cross x 3/8

Coarse pebbly Grit. Slightly Convex. 2 in thick

2 4 6 8 10 12 16

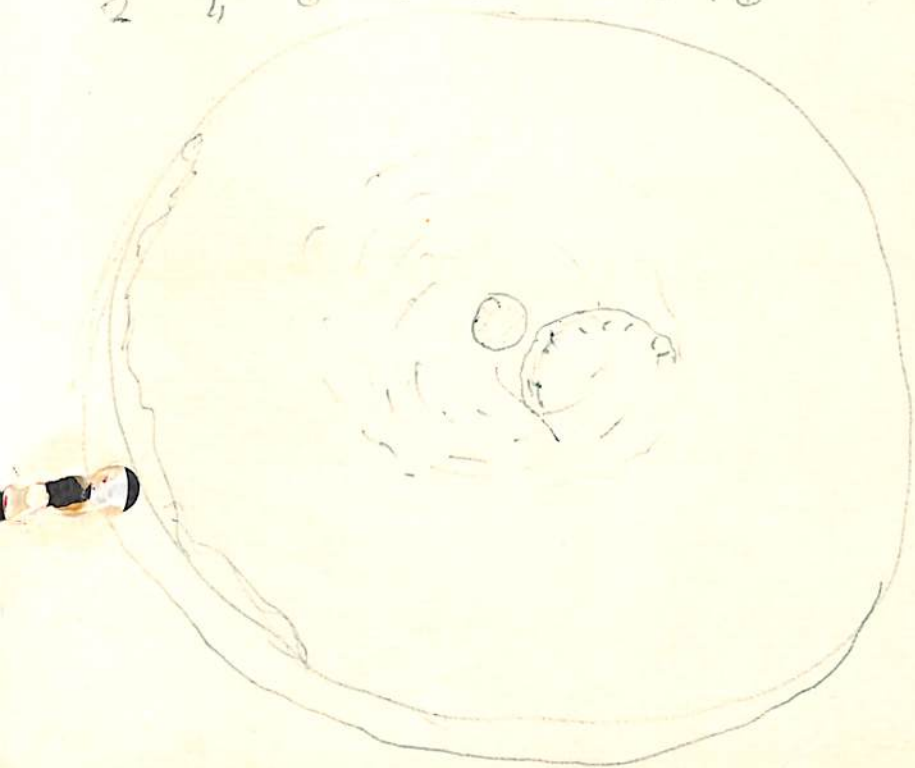

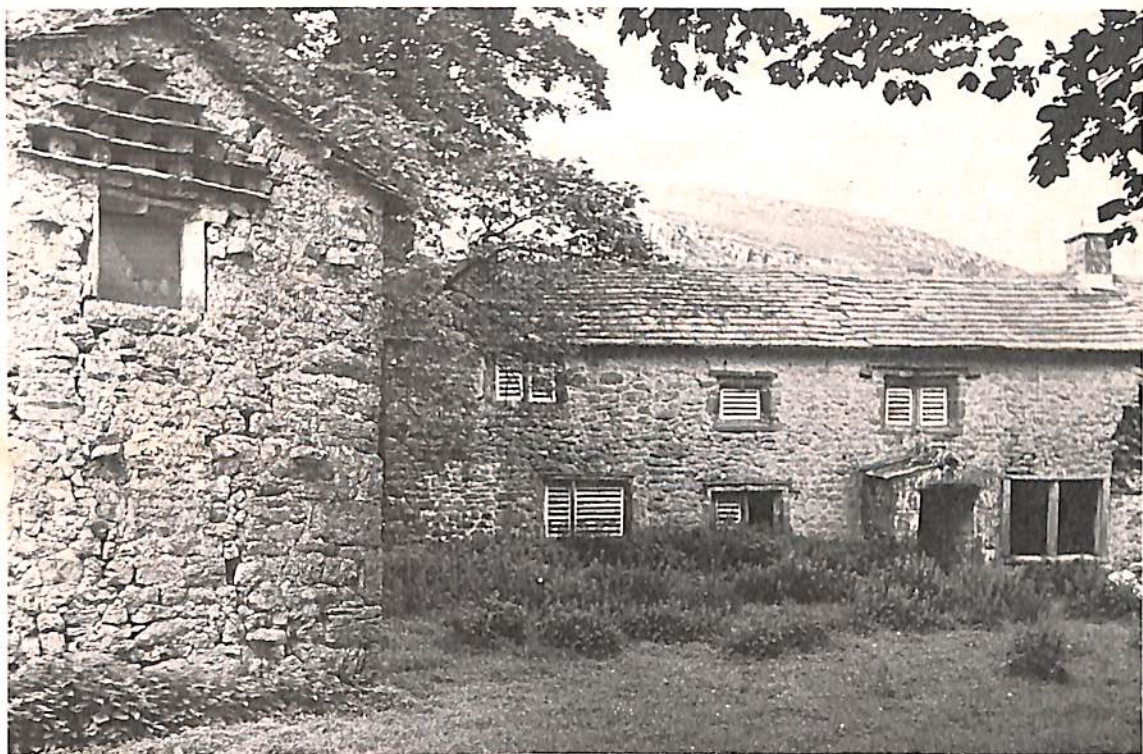

Middle House Farm, near Malham Tarn, Yorkshire. It is no longer a farm but relics of six centuries of farming remain, making it almost a museum piece of pastoral farming history. Photograph from Geoffrey N Wright, 89 Winsley Hill, Limpley Stoke, Bath, Avon.

We measured this up on Bank Holiday Monday. Dr R. said the Roads would be too busy for us to go up the Dale and did some Drawings.

SCIENCE

EXERCISE BOOK

1967-68



I found a ^{great} Chert Core - Close July 29 - 1967.

quite a bit more and
Chert I was pleased to see
? How did they make their flint tools

Pressure Flaking are Rippled.

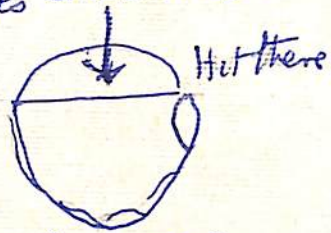

Bull of Percussion.

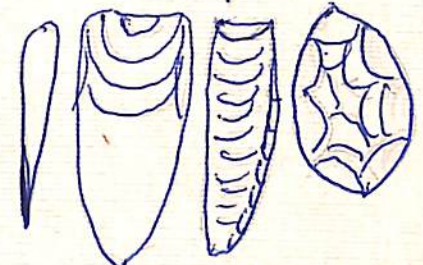
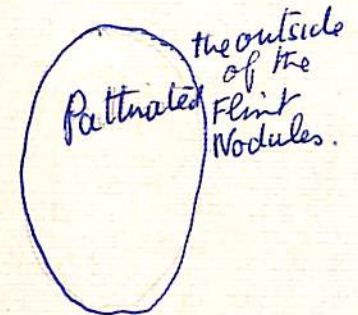

Chalk Formation) Deep Blue-Black,
Yellow-White.

East Coast Chalk - ^{ones} White

Exchanged or Bartered - Neolithic-Bronze age
Belgium, I found a piece in the Knowe Fell
was almost a Red Colour.

Chert from Local Places here in Limestone District



July - 1969.

Chert Core Great Close Planting

These I found in the evenings ^{on our} free time.



I found this one
on Haw Mine.
Neolithic Arrow
Head.

This was marked and Put in an
Envelope to leave with the other
things.

Dr Raistrick told us that all the
things found had to be kept

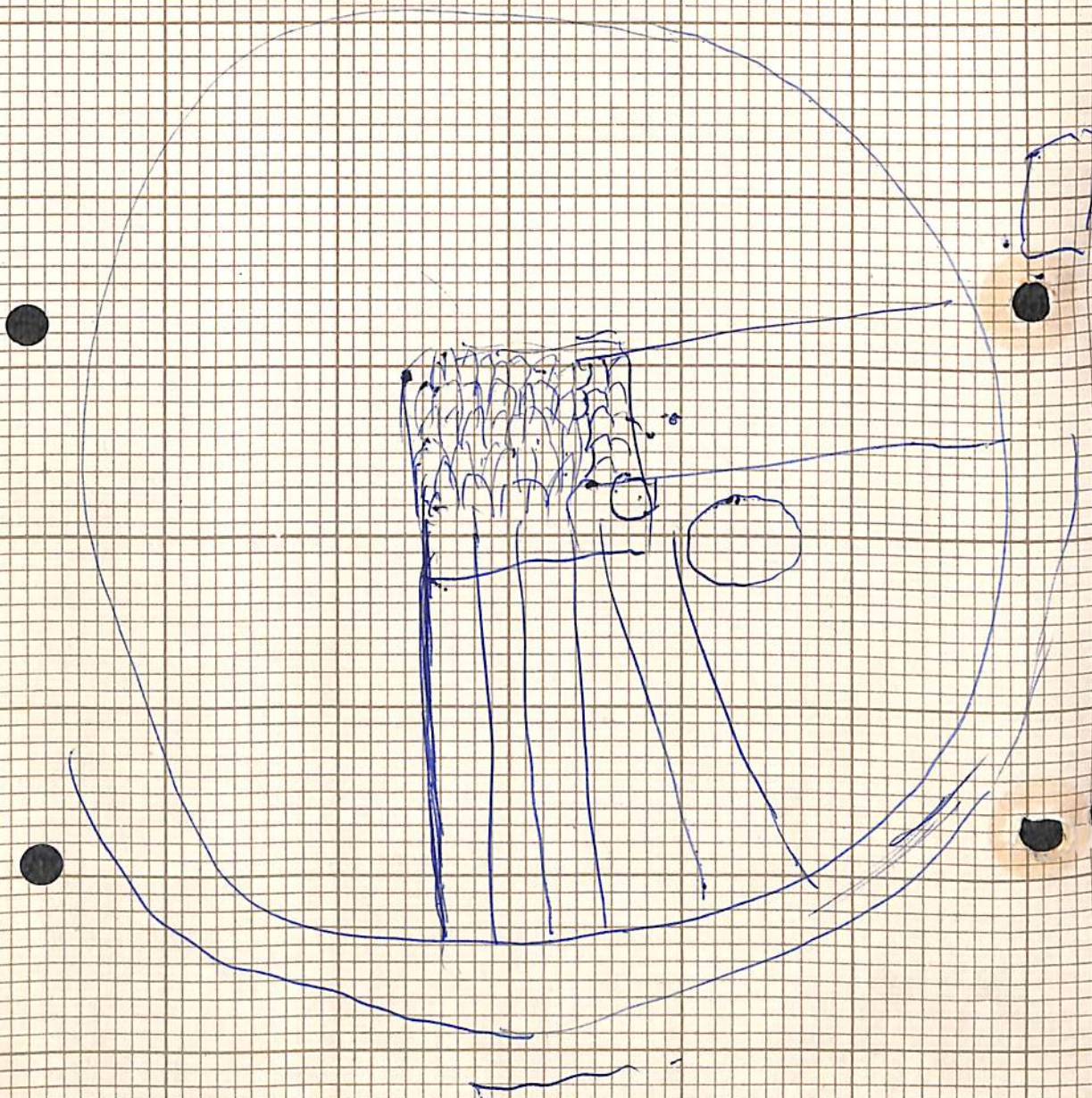

1964

Dig. - Site.

July 26⁶⁷

Barang, Iron, Medwala, until the 16th Cent.
Why we are continuing a dig we began
3 digs ago.

Thin Soils everywhere.

Result old Structure House etc they
have never been covered with soil.

Boulders set on edge. for Fences.

years.
5 or 6000
Sheep.

brost

etc
makes

past 200 years

years.
little.

them

Mess

fall out. like this a flattened

We have been looking at these
Collapsed Wall today July 24th.

Evidence of a Sound Corner.

2 things we have done today. the
big irregular bank,

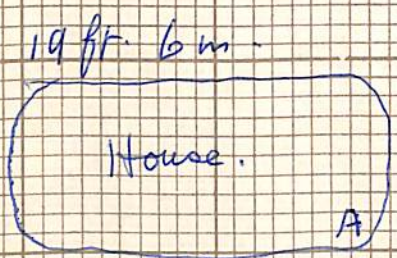

Typical Iron age Farm.
2nd Century AD.

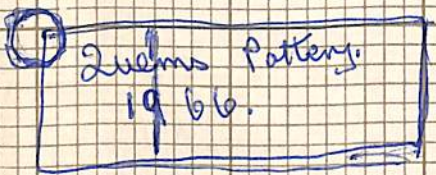

NO DOORS IN
These House.

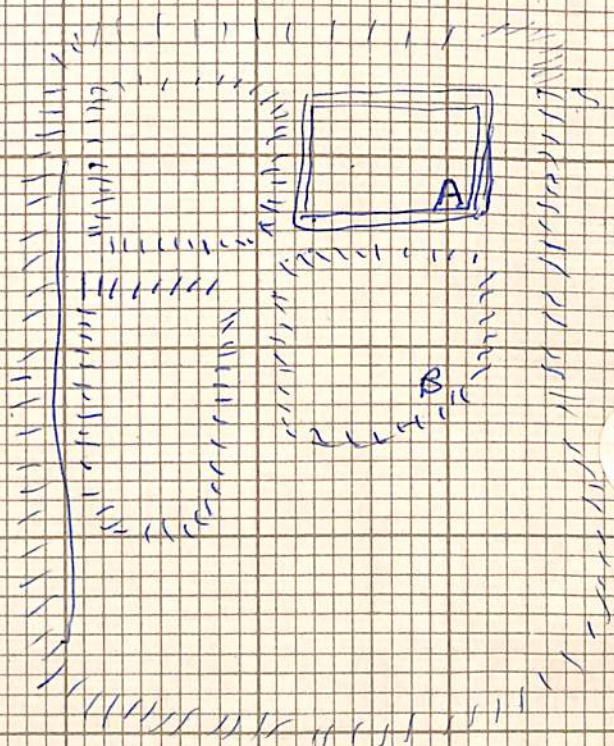

— Huts for the
Farm Men.
or Servs.

To BE MEASURED UP.

Romano British.) Celtic FARM.

They generally

1 House

In a house you get an irregular floor

If it is only a Cattle Pound there will not be a floor.

We concluded that the one we did wasn't a dwelling for Humans because it hadn't a floor, but clints here and there.

all the sites you find flints used by Bromy. Iron ~~can't~~ later they were used for 2000 years.

Can we guess anything already find the edge of the structure. 2 Rows of stones with in filling in the walls.

AD 4 Farmer became more Prosperous.

2 Pieces of.

Blooming Slag. we got today. Remnant of the Clay Iron Smelting.

in Shales Round Here

(Iron Carbonate) 30 Percent of Iron.

Moderate amount of Sulphur Charcoal fire 1100 Centigrade will smelt the Iron Carbonate



Charcoal.

Charcoal



and Iron Ore

Slag Forms

) Iron Forms

in little Pellets.

In the bottom of it the Temp.

This was told us at the Evening Lecture

Probably Someone stayed here who made them Selxes a tool of some sort out of it.

Top of the Great Scar Limestone

Dry Ground, Scrub but not heavily so, never been ploughed, but ^{for} Sheep - Walks. because of the extremely thin layer of Soil.

Bronze age and Successive Races.

Bronze age man, and Remains of

Scattered, in these areas Trade Route through the Aire - Ribble Valley.

one of the Richest in the Country

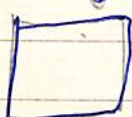
 4 ft thick with Round Corners.) well Exposed and you can see it.

In an air condition state

Early Bronze age. Seaty hill.

8 Notes of Flute found at Seaty Hill

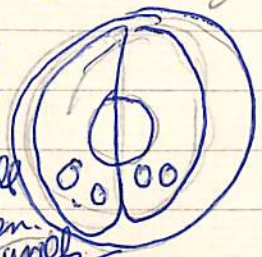

Skeleton and Cairn

13 Tokens Buried

Shallow depressions) Shallow

8 ft Diameter, Bodies were left for the birds to eat the flesh and then they buried the Bones.

July 29 -

Separator in Great Close Planting also Part Iron.

Site 2.

Sand Stone

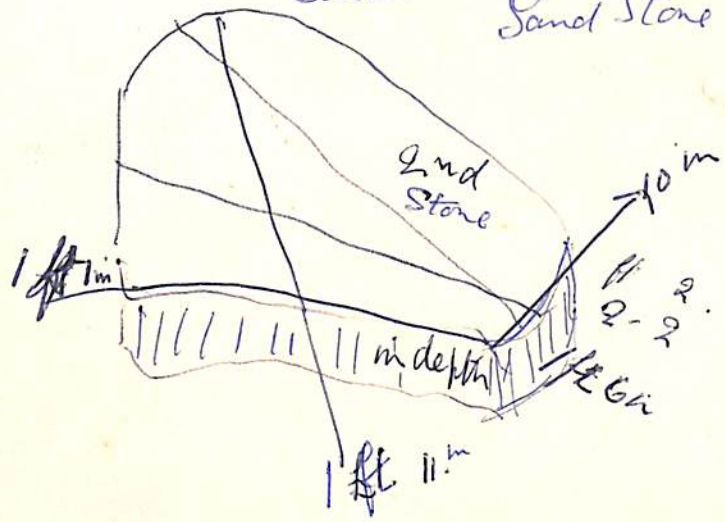

1 ft 3 in

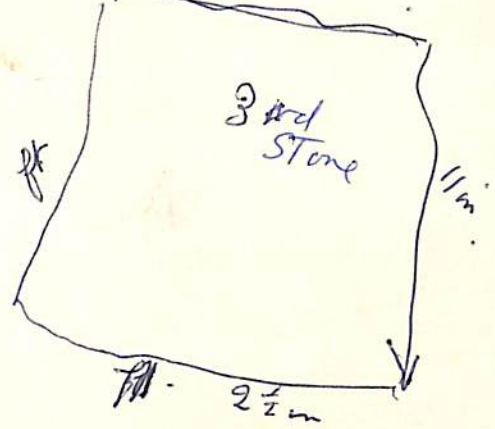

1 ft - 6 in

1 1/2 in Thick

Site 2.

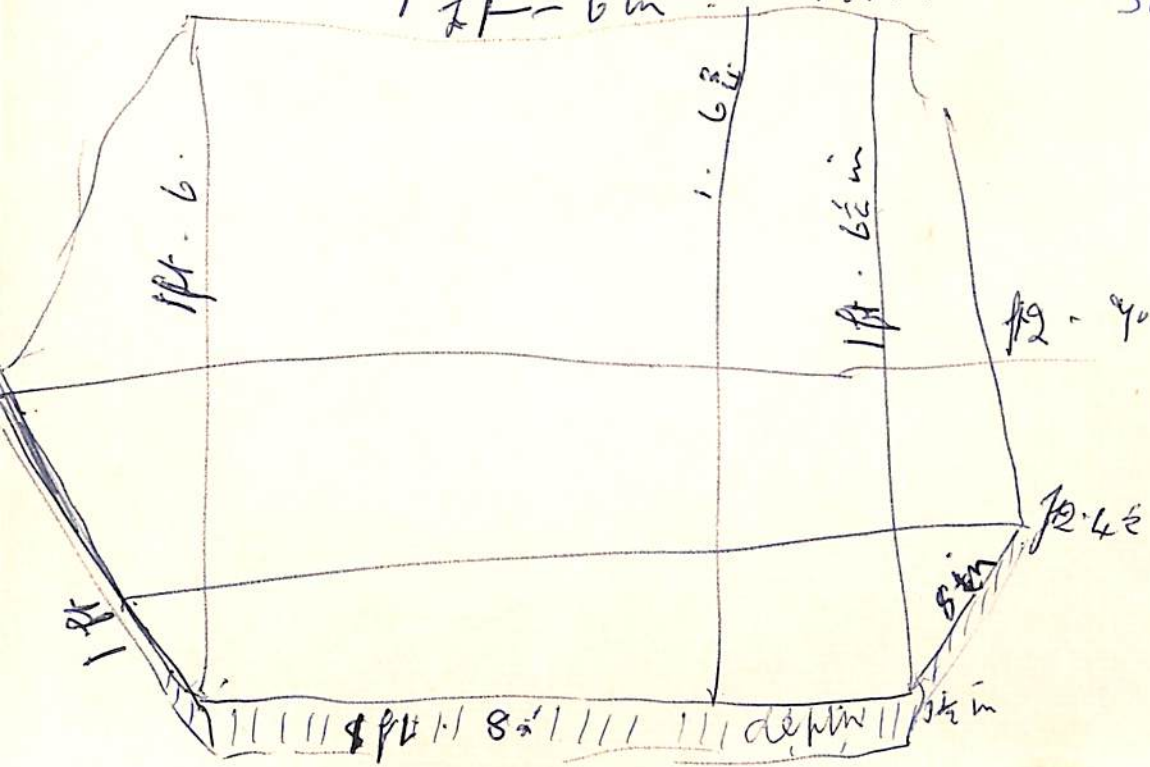

Site 2.

Big ↑
Corner Stones
1 ft. 2 in.

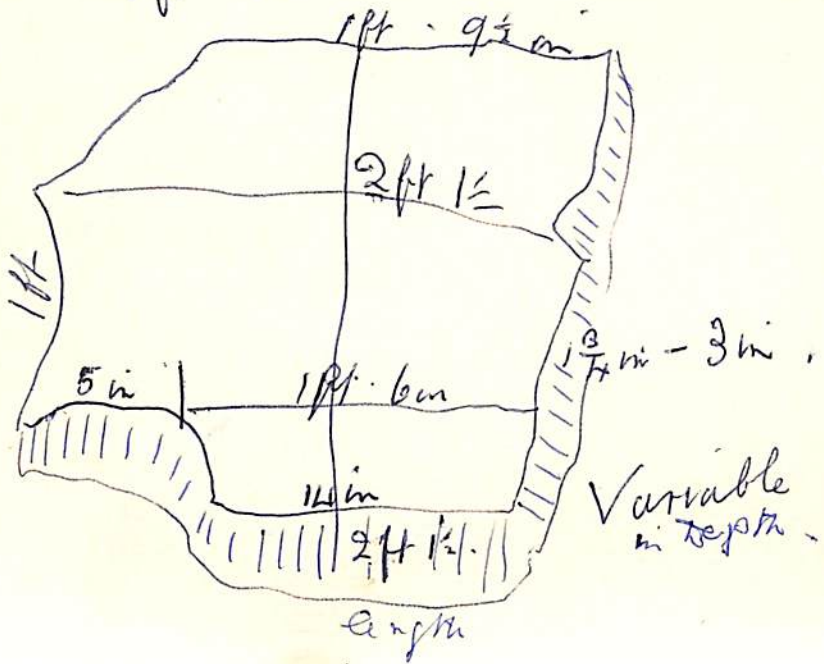

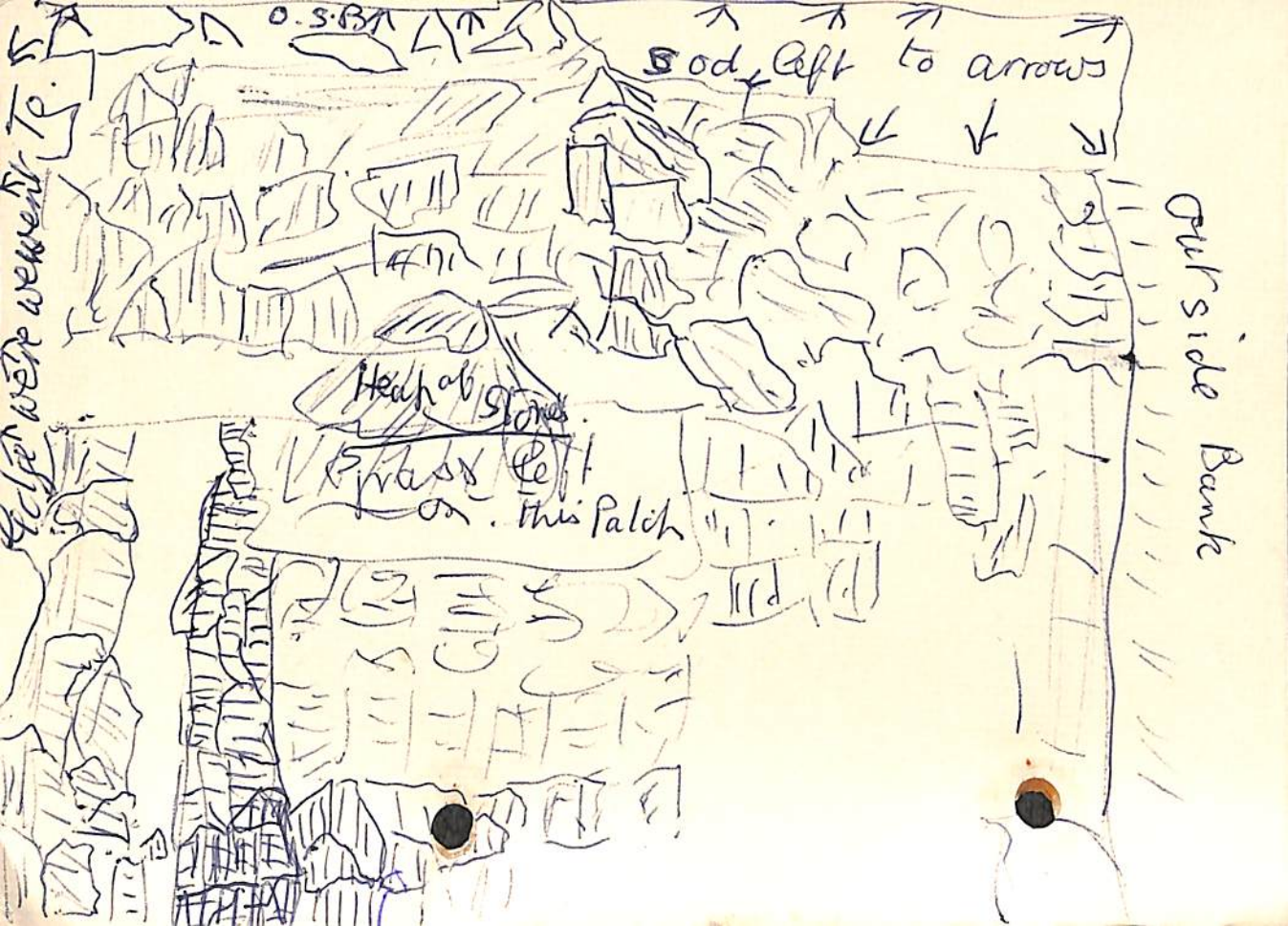

Help were went to

O.S.B.A.

God, left to arrows

Heap of Stones

Grass left on this patch

pur side Bank

Quite Muddy
Floor and
Stones

Limestone
Flag Floor



Mud

a Hole

a Hole

Small Stones

→
O
S
B



Site 2.

Lime Stone

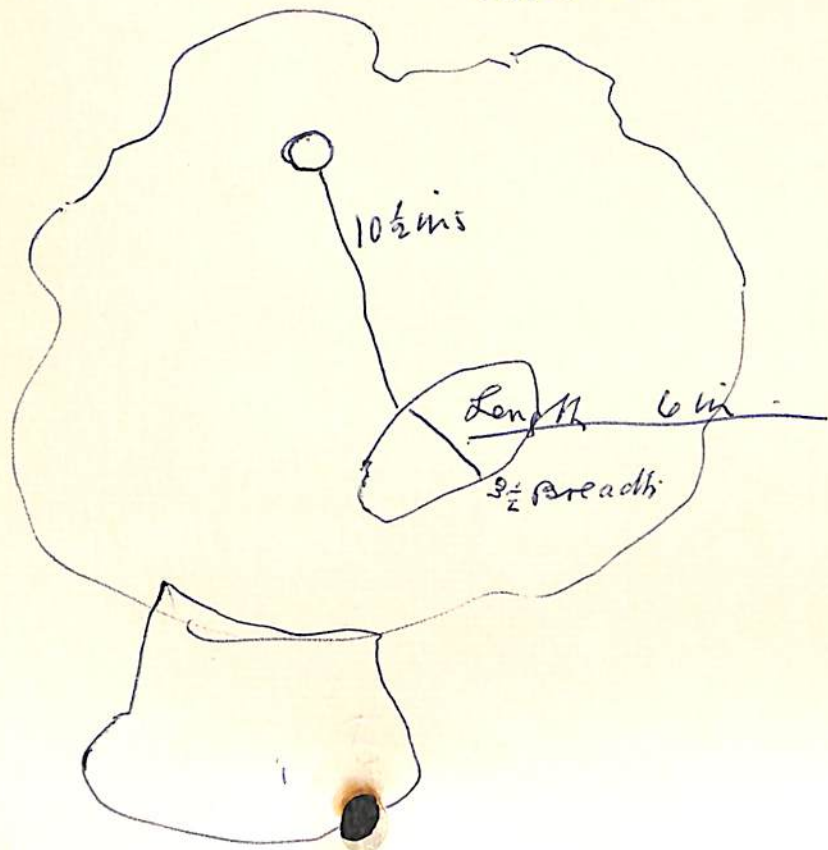

Grit Stone 18

? 14.

20

15 $\frac{3}{6}$

18 $\frac{2}{4}$

20 $\frac{1}{2}$

14 $\frac{1}{2}$

1 $\frac{1}{2}$

18 $\frac{1}{2}$

2 $\frac{1}{2}$

Depth

18 $\frac{1}{2}$

1-18ms

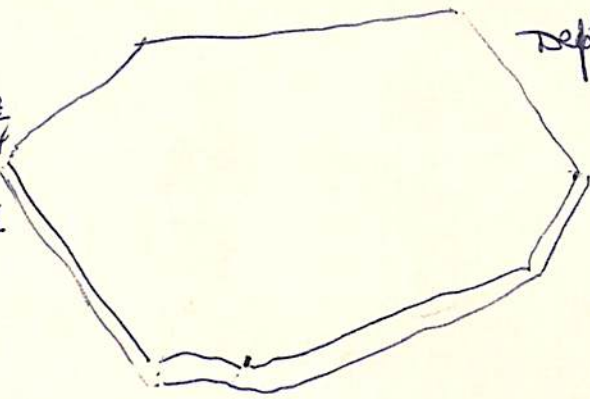
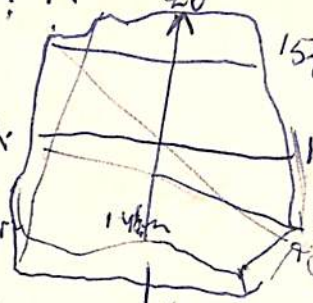

Friend of Museum Friends

Mr. Sidney Jackson, until two years ago Keeper of the Cartwright Hall Museum at Bradford, spoke to Friends of the Craven Museum on Monday. His audience filled the Petyt Room at the Public Library and Mrs. P. S. Baldwin presided.

A good friend of Craven over many years, Mr. Jackson founded and led an archaeology group linked with his museum, and edited a bulletin which was frequently commented upon in these columns. Among the topics which he brought into public consciousness are Celtic stone heads, corn-grinding querns, cruck barns, and ancient boulder walls.

On Monday Mr. Jackson told for the first time some of the secrets of his working methods, which enabled him to record every detail of each gift to the Museum, and to make his displays so attractive. Immediately an item came in, it was numbered, listed and card indexed. It was also drawn and photographed without delay and this is vital.

Once a unique and beautiful carved stone head, dating from Celtic times in Britain, was lent to the Cartwright Hall museum, and Mr. Jackson at once drew and photographed it. Unfortunately the loan became very temporary, for the owner received a tempting offer from a dealer and came to retrieve his head. Its whereabouts is now unknown, but the photographs remain.

Museums have much to learn from shop lay-outs. Speaking of how to display exhibits attractively, Mr. Jackson told of a mute swan which had been prominently displayed for many years. Yet a regular visitor to the museum

Points Knives
Knowe Fell.

ALL THESE ON Here, THESE DR. RAIBOLD MARKED AND LEFT AT THE ' (Field Centre).



Portion of 2 Romano
British

2 items.

Knowe Fell Site

1965

Miscellaneous Flints

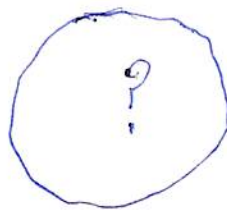

Looks like
Iron.

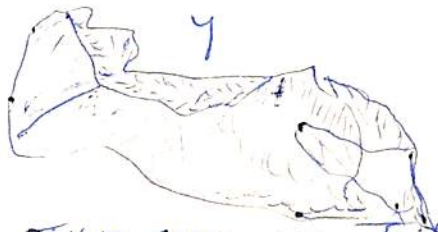

THIS ONE WAS FOUND IN THE SITE

BUT HAVE NO BEARING ON THE DATE of (The Site).

MALHAM TARN
1966 out Dig

Ancient Sheep Fens in the
Knowe Fell.



THE WELLS HOUSE

I wrote this as we went along so Louise could see what we had been up to, because she couldn't go this year owing to the family holiday falling during the same period.

20 varieties of Pottery have been found in the Grassington. So there must have been lots of Exchange or Bartering.