

- Wood Site: On the two Halls <sup>at 1000</sup> <sup>Jobs</sup> Aug. 4 - 10  
 workers
1. 2 John Fagg. <sup>1966</sup> wants to be an archaeologist had to attend to dig in Binchington. nr Margate, North & South <sup>Manchester</sup>
- 2! 2 Mr) Mrs, Brotherton <sup>Calcutta</sup>
- 3 1 ANAN Butterfield <sup>26</sup> <sup>from Peter Works</sup> Cockhill
- 4 1 Brian Goldard. <sup>21</sup> Grammar Sch.
- 5 2 Miss Green Shields. Teacher
- 6 1 Judy. ? College.
- 7 2 Mary. <sup>18</sup> - ?
- 8 2 Jane <sup>16</sup> Pritchard School.
- 9 2 Frances <sup>14</sup>
10. 1 Heather, <sup>15</sup> School
11. 1 Harriet, <sup>14</sup> School.
12. 2 Kathleen Wild. <sup>13</sup> Mother of 3. goes out to work. ?
13. 2 Sally Candy, <sup>12</sup> didn't find out. <sup>what she did</sup> works B.B.C.
14. 2 Florence Akst. <sup>11</sup>
15. 1 George Almy Smith <sup>10</sup> University
16. 1 Mrs Ethel - <sup>9</sup> House wife
17. 1 Mrs <sup>8</sup> House wife
18. 2 Me <sup>7</sup> House Keeper.
19. Dr Raistrick <sup>6</sup> Lecturer

Thus  
the Penning way, they were camping just  
above Stainforth it was ~~so~~ wet thro  
the day and they had been soaked  
they had been trying to dry out  
So had come for a walk to  
stretch their legs. I dont suppose  
we will ever hear how they  
got on.

Thurs we went up onto the Site on  
Knowe Fell.

Some new  
ones and  
Judith  
Allan were  
on this  
No 1  
Site

Some of us were put to Clean the bottom  
half of the Hut we dug last year to  
Clear off the Soil and Stones that we  
had put back, and then to find  
out about the rest of the piece which  
was still to dig they got this started  
and were Rained off. Allan Judy.  
George - Smith Heather - ~~Harriet~~ Mrs  
Mrs - -

Bank No 2  
Site



The others of us had to Start on the  
bank wall of the group of things  
supposed to be fields <sup>or</sup> pens John Fagg  
and I cleaned the Sods off the  
Bank, from Arrows to ARROWS it was  
Bad in Places and took Some time  
to Release them of their Strong grip.  
John was a good and Cheerful worker  
and took all the lifting of Sods whilst  
I cut them, there was a group of  
Cleaner off's following up after us  
then it Rained so hard after they came  
back from the little walk about 1.30 PM

Mrs Beldbrough  
me back and  
then came off for  
P.M. time

that we Packed up and came back  
every body was (sopping) or Sobbing  
as some People call it. So we had  
to Clean our selves up and then we  
had a Lecture for an hour before  
our tea. Very interesting see Notes on  
this, Dr R showed us many of his

3.15  
4.15

Her Drawings etc and told about various ones, I gave Vivian a copy of my three poems of last year to give to Douglas, I lent her a book of <sup>my</sup> Flower Paintings to see, afterwards she said she had enjoyed seeing them and what lovely colours I had got just like the flowers. I still painted all evening, we had to pay our fees after 5pm and this was a long time going on there seemed to be a queue for ages. After dinner <sup>over</sup> I to set the tables again with Mrs Brotherton this time, and her husband helped us, because we had another lecture, this was at 8.15. and Dr Racstrick talked about the Brigantes see notes on this it was still wet and windy at Bed time. Just as I was going across from the lecture there was 4 people standing outside our Lab they wanted to know what sort of things were studied etc so I said I would find the warden, he was lecturing at Skipton so the under warden came he gave em a programme of coming events etc and told em to write to the Centre if there was any thing they would like to join, a Lecturer a Teacher - 2 students they were going to walk

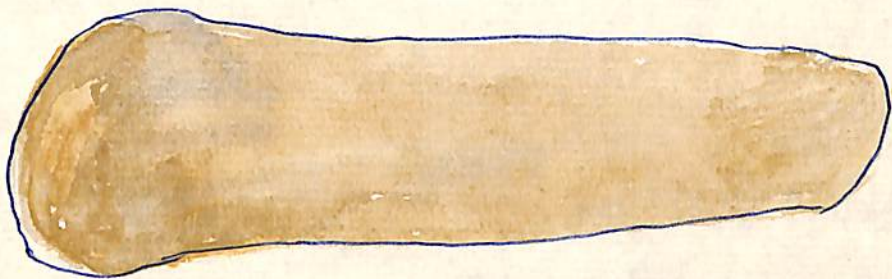

OX. BONE.

KNAWED BY Dog.  
?

I found this.

I threw it to Dr Raistrick to see  
then got ticked off about  
throwing any funds, how they can  
be our only specimens and be very  
trivial. <sup>and</sup> <sub>over</sub>

SU's know hell

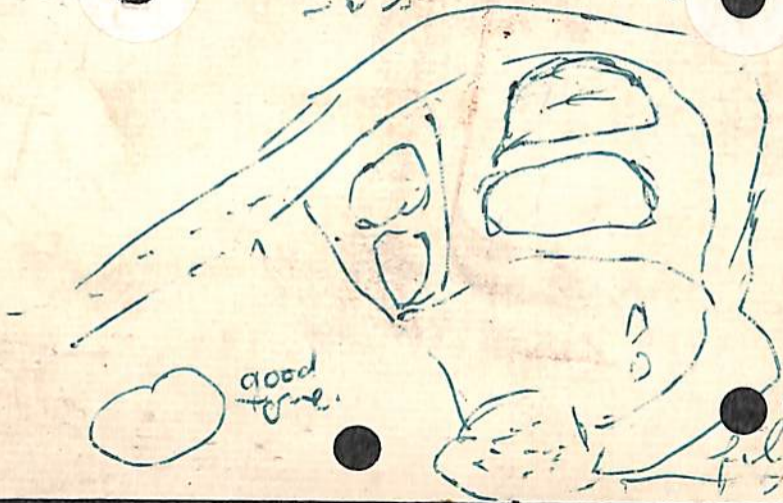

good  
to see!

fill  
7-30

High Mark. - Druids Altar  
 NR Bordley - Druids Circle

Great Close they held Cattle Fairs the Inn  
 supposed to have been a murder there the Man  
 who had been payed for his Cattle was  
 murdered for the Money.

our Mary told me when she was a girl there was  
 a Ruin of an old House, by the old Garden at  
 the Boat house, I remember the garden but  
 not the House.

also she said there was an old House  
 by the High Stables

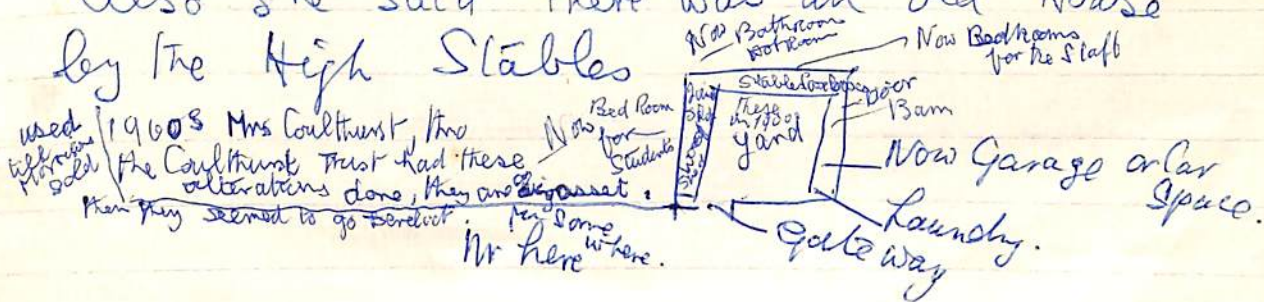

Rabbit Bones  
Stools

Sheep Bones

1 Rabbit Rib had been broken at some time  
and it had become  
quite a knob on it



Jordan Bank

Aug 1965

Wall Passage we had to clean up  
the farmer said he didn't know it was  
there he'd never seen it.

This didn't yield anything of value that  
I saw. we got a few animal bones  
Rabbits, Stools, Sheep etc. And what

they ~~passages~~ are for was argued, but  
the best suggestion that I heard  
was to store their valuables in  
such as ~~well~~, grain, tools etc  
and skins.

The Passage covered over with

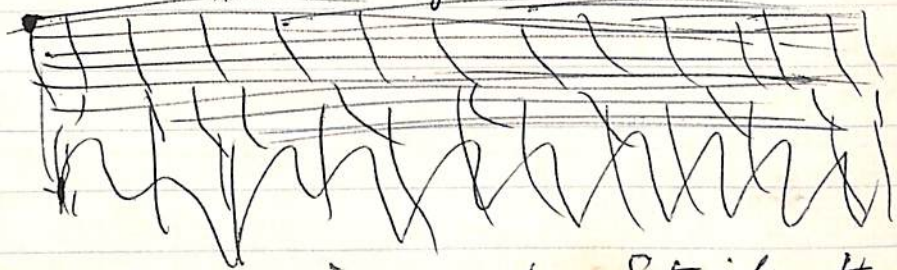

a covering of sticks then  
skins or wattle and daub?

sticks and clayey  
Mud?

The passage when we cleared it  
was paved with limestone at the wall  
end but the other part was rough  
and uneven I thought.

1 Rabbit Rib Bone had been  
broken and had a knob  
of Bone in the middle  
where it here

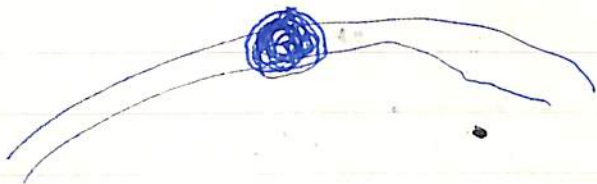

1966

Cave in Knowe Fell

Aug.

Dr Rastbach <sup>took me</sup> about a Strip of the floor <sup>being</sup>  
dug about 40 years ago; they found a  
few things Tot's Museum.

1st or 2nd Century A.D.  
House

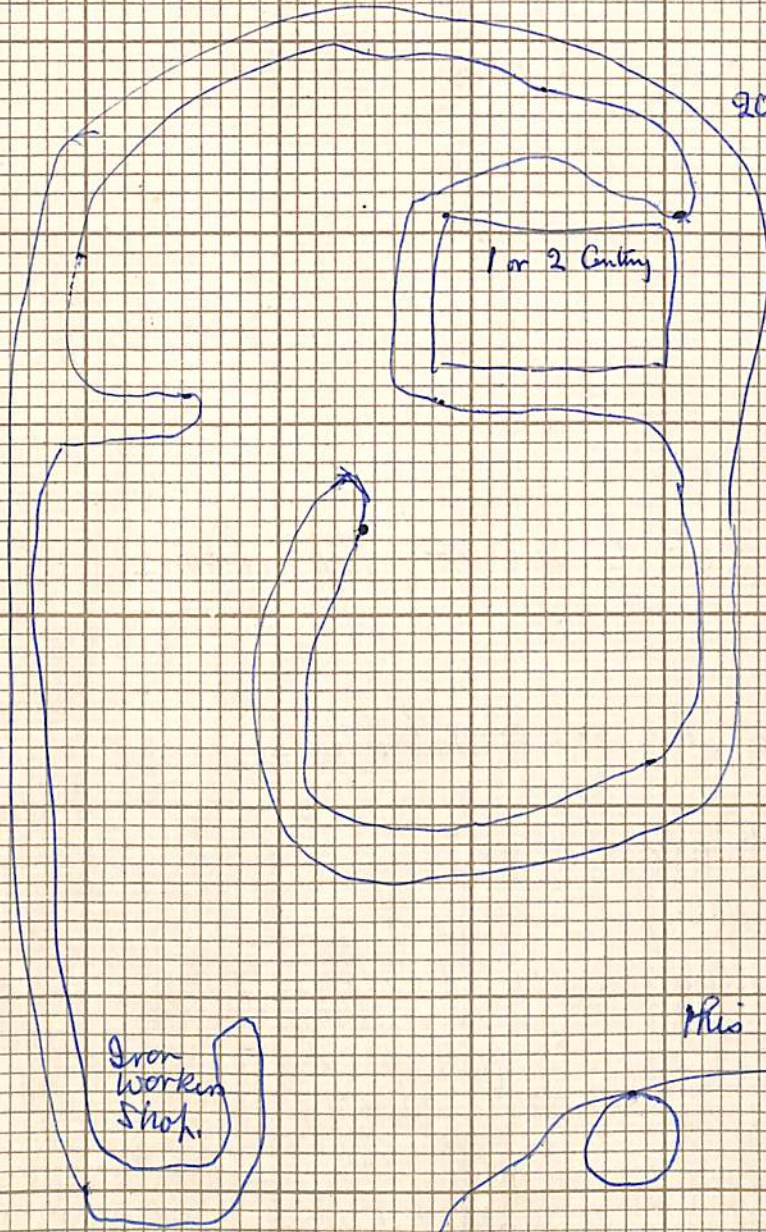

20 ft Squares

1 or 2 Century

Iron Working Shop

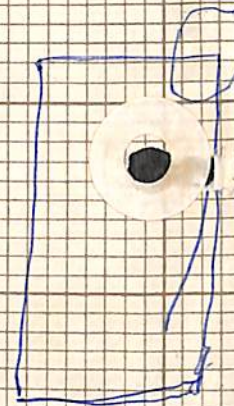

↑  
a finer building  
3rd Century

This is a kind of site  
there are  
scores

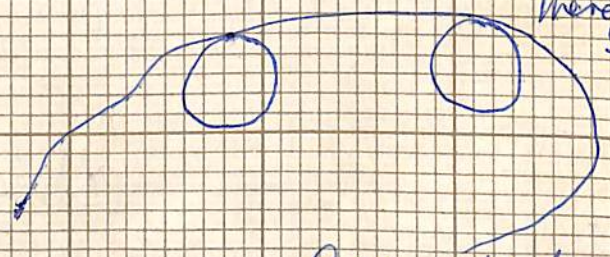

Linked Huts  
Irregular Banks

Late Bronze or Early Iron,

Vikings lived on top of Ingelborough.  
exchanged Skins Etc



What sort of Shoes had they

Dr R, said

Romans  
didn't come <sup>here</sup> over 300 acres at Grassington

Pure

Romano  
British about 15 houses at Middlehouse

AD  
5-7 Century Priest House,

Man Writing - Wilfred of Ripon  
Bentdale Ribblesdale  
Priest  
Living amongst  
them  
Airedale

9 Norse

10 Norse Irish <sup>Norse</sup> Viking Threshcross  
they conquered Ireland and  
came across over here.

It suggests that it is Bronze age  
 Neolithic to Early Bronze age.  
 Our dig. Chape Fell, 1964.

be If it was drawn Properly it would  
 be Circular or Saucer Shaped.

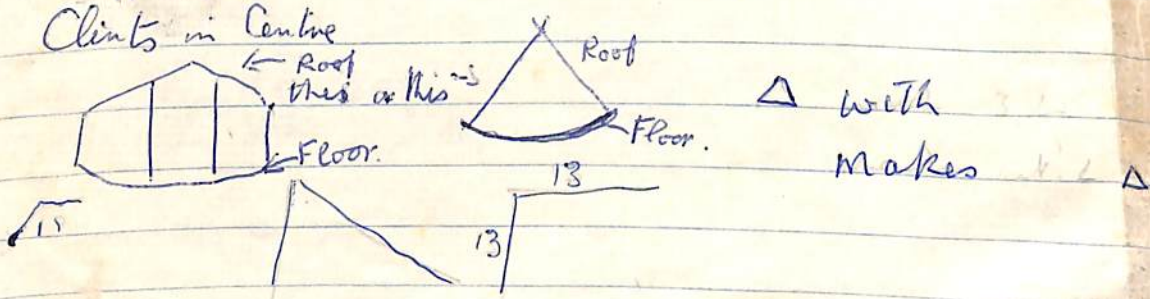
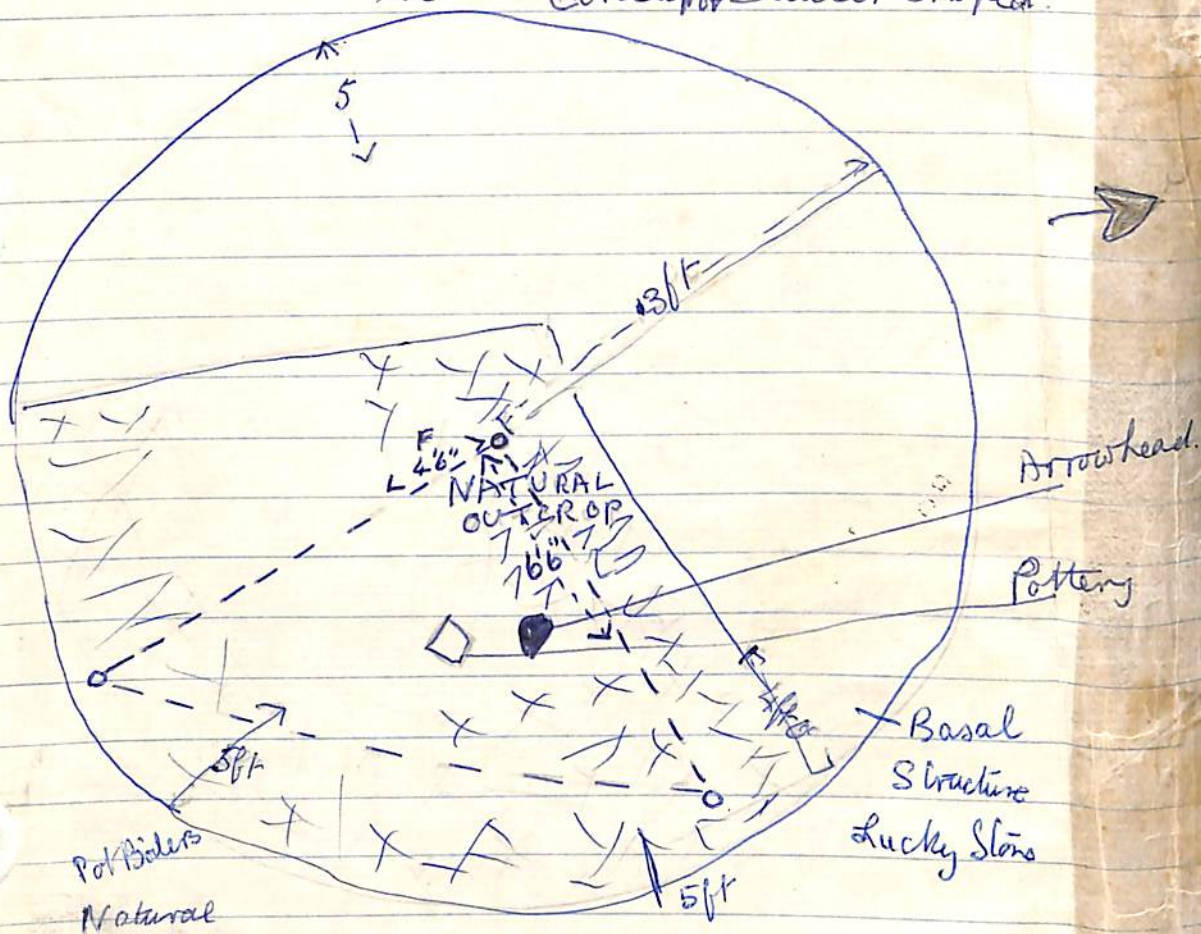

for Louise to see.

on Television on Thurs. Aug. 18<sup>1966</sup>

There was our friends at Duck  
Street getting Fluor Spa, Mr  
and his Son Jimmy a

Good Picture of em Jimmy

Kept his back to the camera  
and went on Picking out  
the Fluor up a high crevice.

then the camera went over  
to show us Fred Walker's Mine  
and some of his workers and

the Clay Cross Place. Some of  
these had Crash Helmets on, or they  
may have been Miners Helmets, I  
don't know which.

Early Iron age.



Iron age w

Iron was introduced. <sup>Hallstatt</sup>

Iron age A 500-300 BC Culture

● Iron age B 300-150 BC. <sup>La Tene</sup> Culture

Iron age C. 150 BC.-AD 43 BELGAE.

Hallstatt a continuation of Late Bronze age with Iron implements  
La Tene culture reflected Greek influence superior organization and art style.

Belgae a vigorous military and trading people.

Partly Romanized, bronze wheel made pottery and  
● Coins.

En Site Chapel Fall 1967.

This type  
is getting  
on into late  
Neolithic.

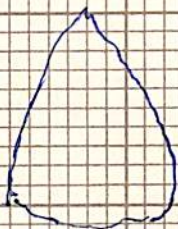

Neolithic arrowhead.



Flint

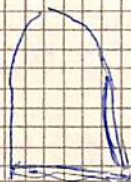

Pot Boiler

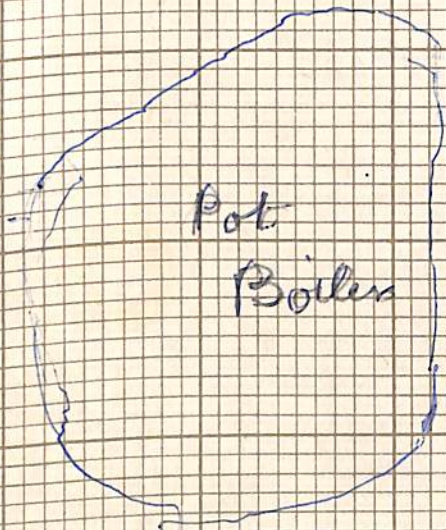

Pot  
Boiler

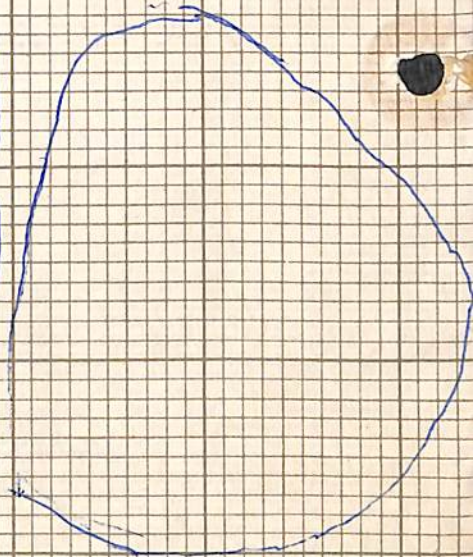
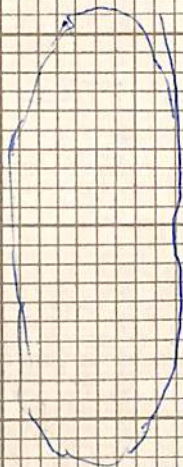

lived in a Cave at Settle he  
found a Piece of Slate and wrote  
his name on it } - in Settle Museum  
NOW.

Foundations  
high up

Sheep farmers.  
30 ft

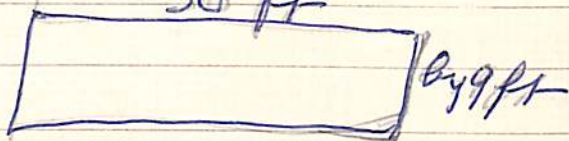

Marks

Cistercians Great Iron Workers  
they got the gift of these farms  
to Fountains Abbey.

1190] see his book.

New Middle House] site above.

Suggests.

✓ Knowe Fell

1965



I never noticed how they got into this. Must look some time.

1964 I found a small gate way and lots of gates down.

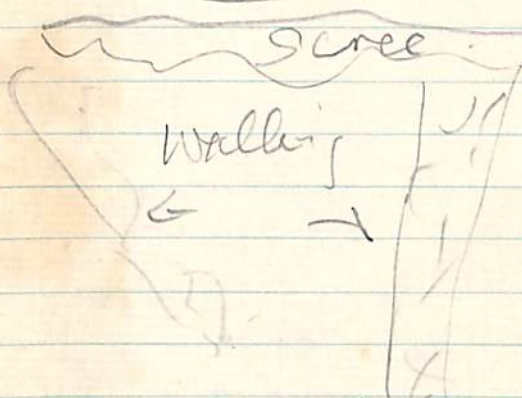

I found a piece of Belgian Flint in the above

• a few grit stones  
Spread about

These I have copied into my Keeping Book.

from the door end of  
Cory house Blackish

3 Bits of old Bone.  
Quern. Flint Metal Object  
1 Nail.

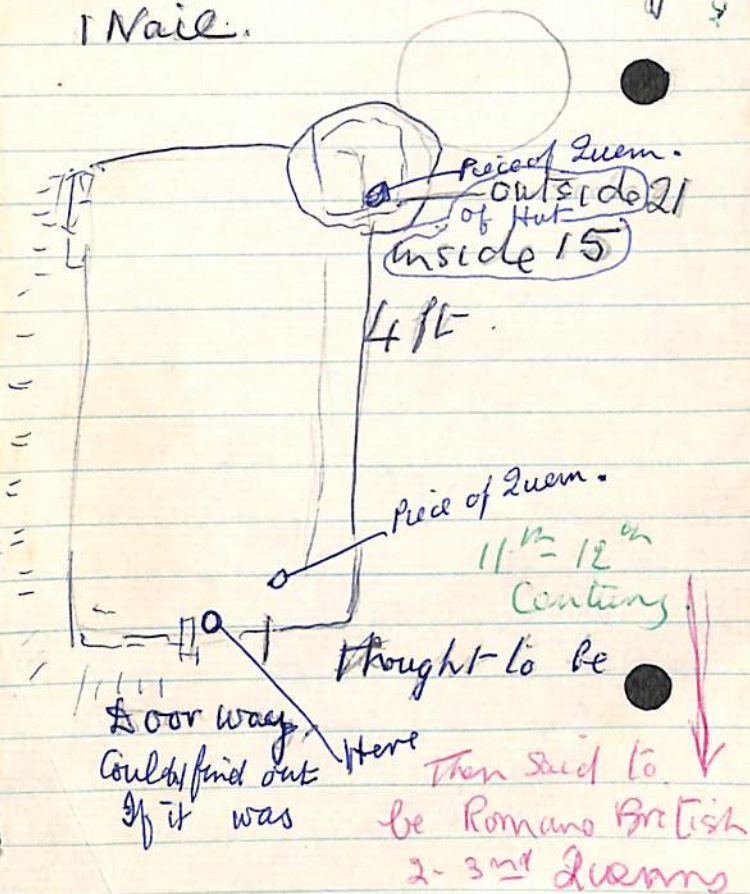

# Knowe Fell. 2

Good Quarry Behind  
Bang. little Quarries  
Here and there

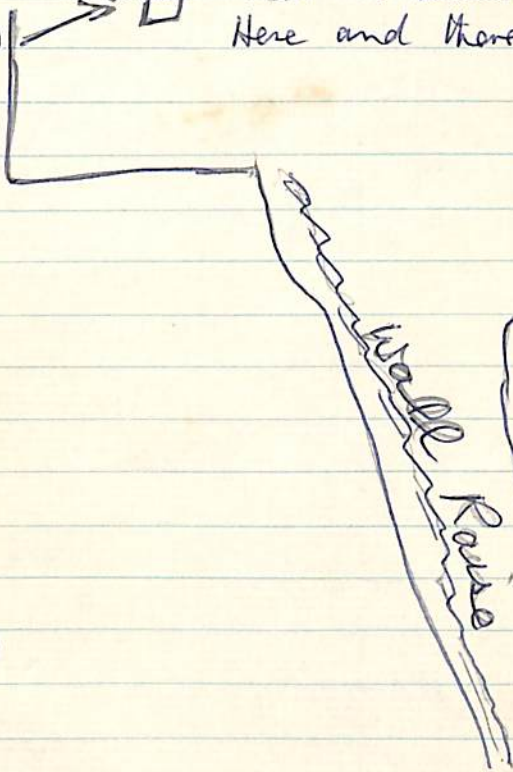

Waters  
Quarry

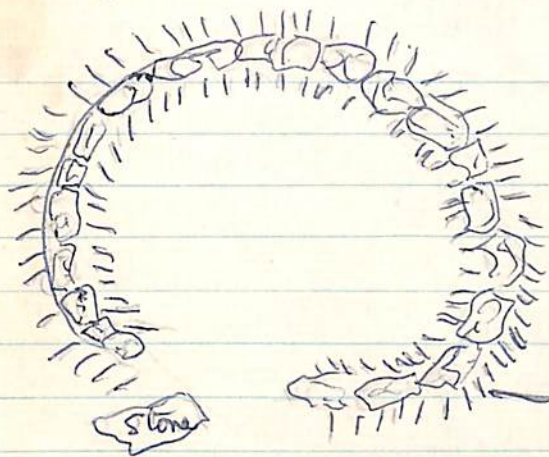

Stone

Gravel  
Banks



THE DIG -

# Note & Sketch

in  
**Book** *Edmore  
Fell*

NAME ... *H. Ward.* .....

DATE ... *Aug. -* ..... *19.6.6.* .....

*Chapel Fell*

see the name

it's the mark of value

**winfield**

## The Site. Knoupe Fell.

When we were talking about it afterwards he told us that Knoupe Forest was further up from the Site and there would be lots of wolves etc and their skins would be valuable and their sheep skins and meat and they would use for Grain and other food. Etc. Has they couldn't grow grain up there it is to near the Rocks etc.

When T.R. was talking about Pottery, He said there must have been lots of exchange and bartering in the Dales. Grassington had 20 Varieties of Pottery this was for example for us. to think about.

46  $\frac{3}{4}$  total length.

Bits of Bone (Animals)

● Piece of old wood.

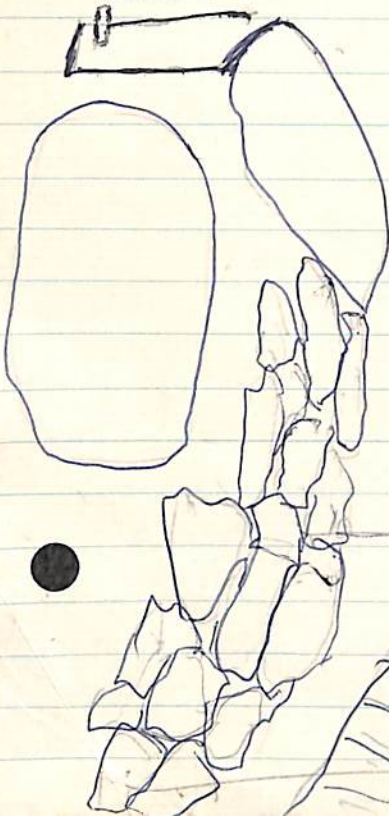

going to-wards  
Chapel Fell then 3

Two Scars of Squators  
Hut. ? 

● Has there been Mining.  
Looks like a Tumbled in  
Place

Nettles further on  
Sand Stones Big ones with  
one on Top. opposite  
Sandy Banks - a Gap in Scar.  
Water below. Looks as  
if there may have been  
a lake some time  
or is it a fault that

● makes the water stop -  
then we came back  
to the field system  
above the site a longish  
clearing and a small one  
just over the Top 

Nearly 50 years ago 1964

Horse Shoe in New Planting.

Malham Tam.



We used to sit  
in here and saw  
leaves together with  
Pine Needles and the fibres  
from Greater Plantain leaves.



Just to see if it  
could be done,  
(It couldn't be  
done) and we did it.

Oct 1963.

I've thought about this Place, when my  
Dad was a Lad, that is nearly  
90 years ago he said there  
was no trees and the field <sup>now</sup> above  
was unfenced right down to the <sup>called Tam</sup> close  
water. Do you think that  
Horse Shoe shape could have  
been an Iron age dwelling  
let us look at it sometime, -  
we can't dig without Permission.  
When I asked ~~Mr.~~ Well can't  
we get it?

# Bronze age Settlement

1. Big Family House. <sup>about</sup> 20P.  
for 2-3 Cent.

● Rather better built than Fell, <sup>knows</sup>  
2 Skins to the wall.

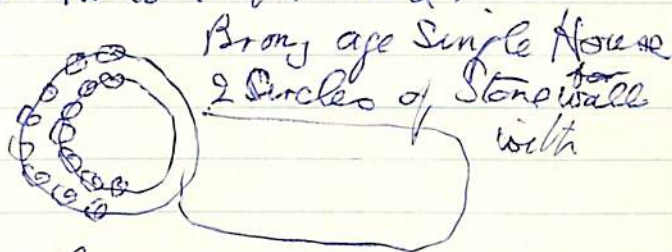

● Persisted thro the Iron age

Wall Passage  
we don't know what they  
are

1965  
Aug 4

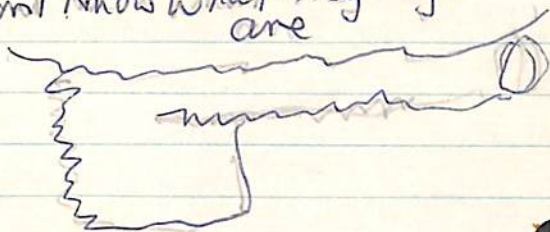

Paved Entries

Whetstone

2nd Century AD.

# Scar

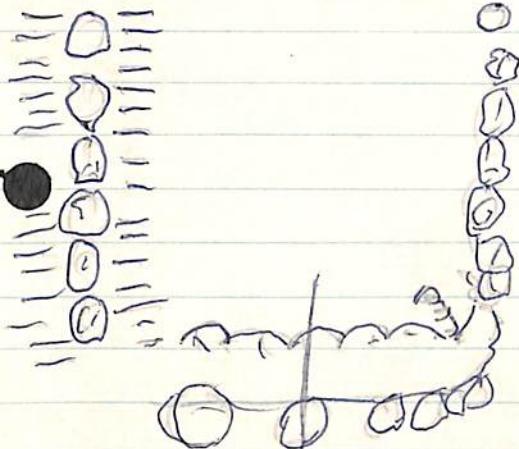

40

2<sup>m</sup> = 6<sup>1</sup>/<sub>2</sub>

or 2<sup>m</sup> q at Most

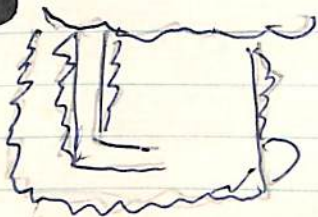

Rock face walled ? 4

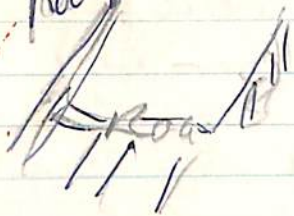

lots of Walling dropped in

I sat down here and

Looking across to a scar  
above the hill in our field  
one above high fell. There  
● looked as if there may  
be dwelling it was to far for  
me. Then dropping down the  
wall side there was some  
good cleaned up land between  
2 hills a Ring of Stones on  
the lower one nearest the  
Tarn.

14/1/65

7 Back Lane

Guiseley, Leeds.

Dear Miss Ward,

● I thought you would like to have this article which Dr. R. wrote for the Bradford Textile Society Journal in 1955. I could only manage to borrow a copy, so I made these prints on a machine we have at school - I hope it isn't copyright, but I don't suppose it matters if I give them away!

● Louise would like me, ask her to let me know and I will send her one with pleasure. I went to Malham last week and photographed the Bronze Age

House and one or two other things. It was a wonderful crisp sunny morning and the country round Malham looked at its best. The photos are just a little bit disappointing as the colours are not quite true, but they are not so bad!

Sincerely,

Michael

July. 1965. 1966. 1967

in

Knowe Fell

Loc marked with a Dot.

# MALHAM TARN

Field Centre



from <sup>pond</sup> Great Close Pasture.  
 The Haul Mill Chapel Fell over the other side  
 Loc marked with a Cross. 1964 - 1967.

Old Chapel  
 Etc See Notes } Dig Circle

High Trenchouse | Low Trenchouse | Tam Hall

Medd's  
House  
area

On this side  
of photo  
Jordan  
Scam where  
we  
cleaned  
a wall  
Passage  
in 1965,



Air View  
Q. 1900

MALHAM COVE AND TARN

C. H. WOOD  
(BRADFORD) LTD

Aug 6<sup>th</sup>

we had to Strip the Sods off the Collapsed Structure, We roughly Cleared the East End on the Thurs.



14 00 AD.

We stripped the sods off here. Whilst some were along the Banks.

a Significant;  
 Medwale Building  
 Brian and Jill Stapleton  
 cleared this corner  
 a big Stone this corner  
 there was quite a bit  
 of Pot Boiler this  
 was just outside  
 the little squatters dwelling  
 We had to dig and Re sod

Aug 8<sup>th</sup> again

This was a Hat Circle a very good one  
 and in good preservation and the sods  
 in the Bottom came away nice and  
 clean. and underneath were stones which may have  
 fallen from the outer edge. the sides had been built  
 into with graded stones to make it strong and firm  
 to hold the Rest. I found a fossil as I was  
 cleaning the face of the bank, which Dr Rowstrick  
 said was rare for these parts, he took it to identify  
 ? What was it.



good one  
the sods  
nice and

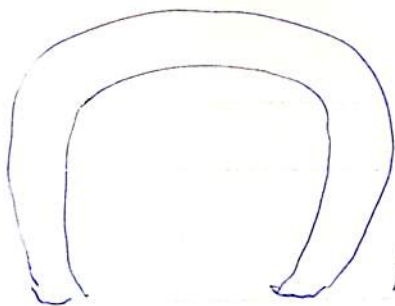

## Romano-British

1-2 AD ) Dr Raistrick told us and they would look like

this when in use. They would have skins layed over the sticks to keep wet and caldout:

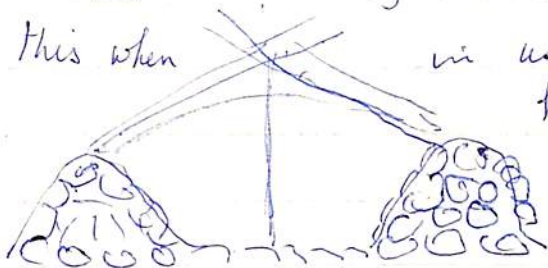

Probably Squatters made these Huts. When they had been driven out by the Romans, <sup>the Huts</sup> about 5ft High inside they would House 1 family.

These were the people who liked an Independent life.

? What did they live on. Corn, Gooseberries, Raspberries, great wealth of wild fruits, - old people and Independent ones liked these sites.