



The Kilnsey Project; vernacular buildings and dendrochronology

Upper Wharfedale Heritage Group

What evidence is there of the "great rebuilding"
or of the buildings that pre-date the rebuilding?

**New dendrochronology dates
for some Craven roof timbers**





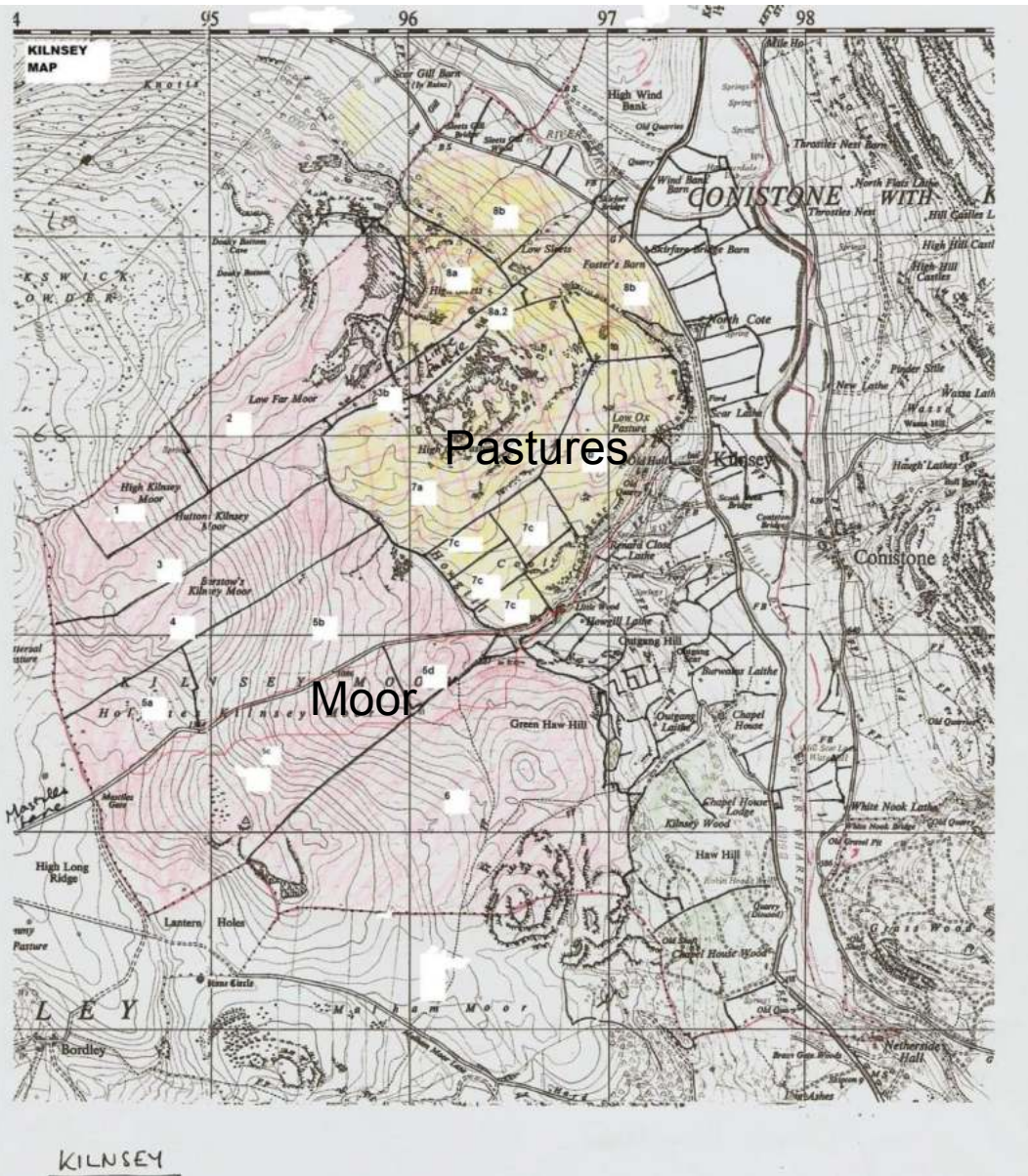

c1850



c1909

Timber roofs in Craven





Great Barn



Fold Farm

Fold Farm,
Kettlewell:
section of
hall
at truss III

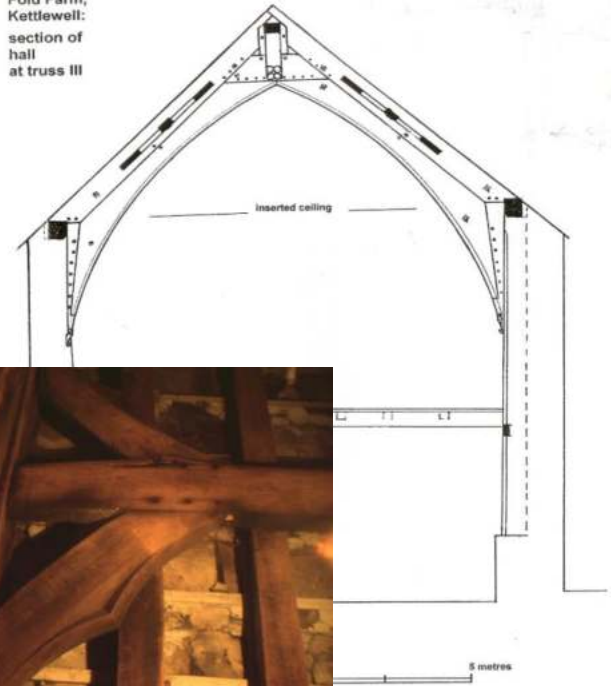

Re-used cruck timber in Craven of unknown date

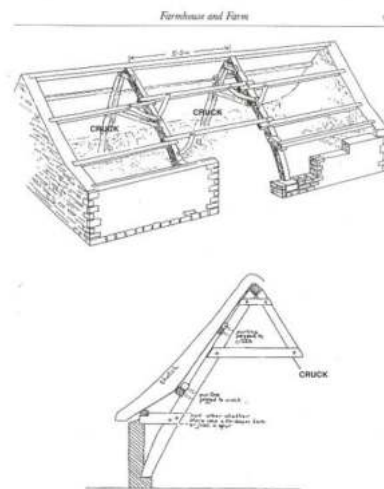
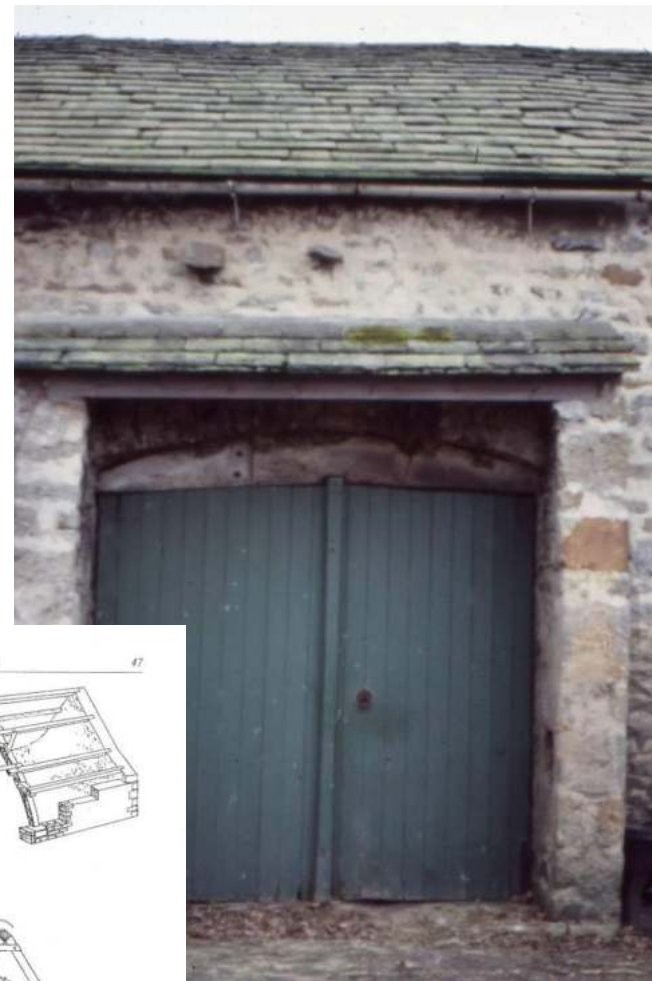

IVY HOUSE BARN, SMALLBANKS
This is the suggested reconstruction of an earlier barn on the site. The timbers drawn are all in the roof of the present barn with only wall plates and collars missing. The timbers making an 'X' are called crucks. Farmhouses, cottages and barns were usually built by this method used about 1500.
Designed by Alison Armstrong



Lancs

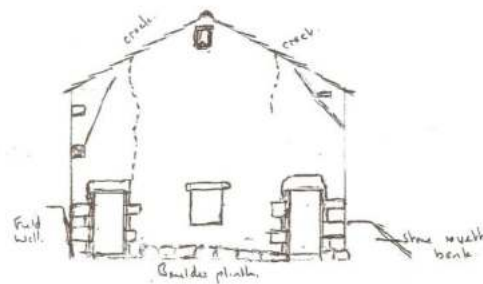

1/2 in
1/4 in
9/10 in



10m

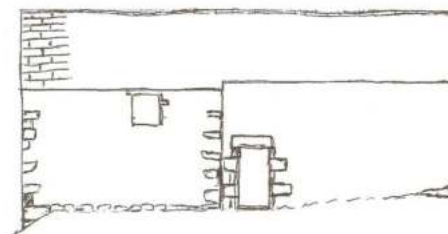
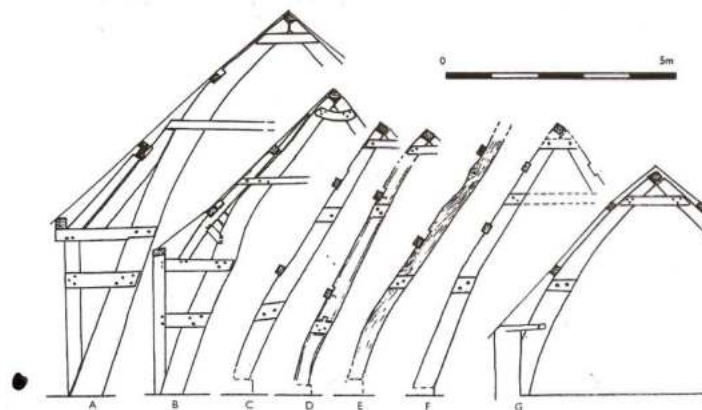

Figure 1: Crucks in Craven (and its Lancashire margin)

A comparison of crucks from standing buildings (A, B and G) with some reconstructed examples (C-F). All drawings are to the same approximate scale. Locations are: A, Stonyhurst, Lancs.; B, Hacking Hall, Lancs.; C, Small Banks, Addingham; D, Park House, Eastby; E, Cross Green, Lothersdale; F, Tithe Barn, Lothersdale; G, Dretley, Barden. (Drawings by Arnold Pacey)



DISTRIBUTION OF BUILDINGS DATED BY
DENDROCHRONOLOGY

The map shows no work has been done at all in the
Dales area.

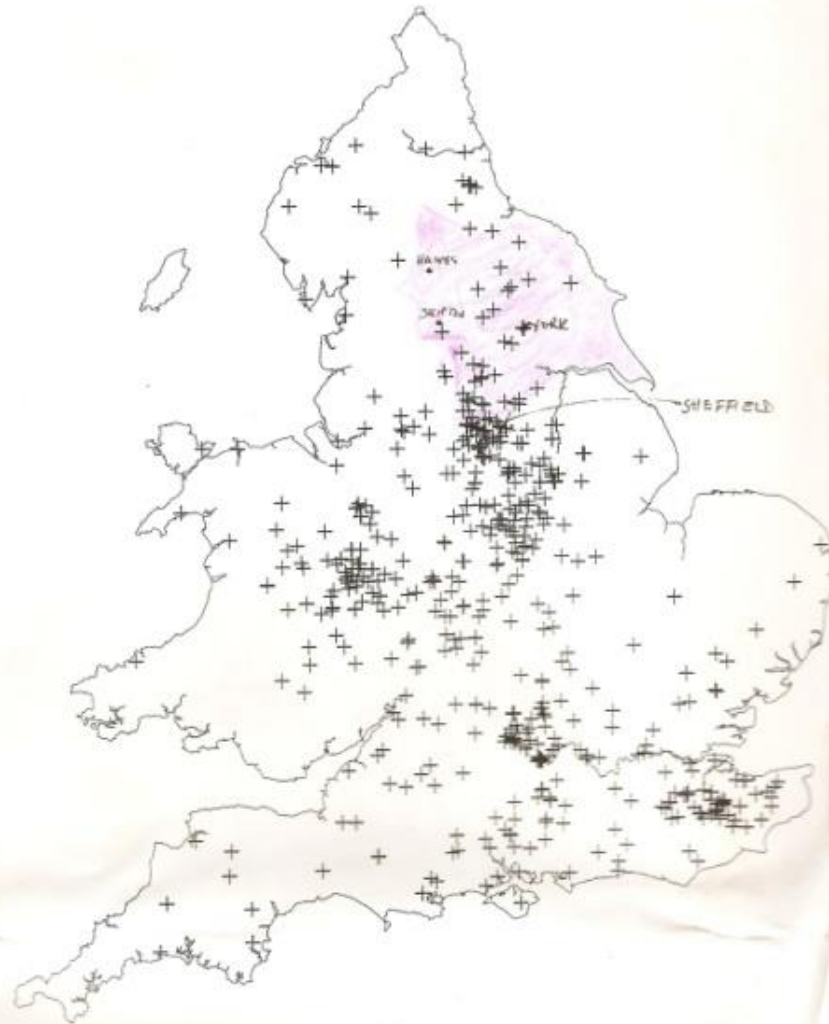
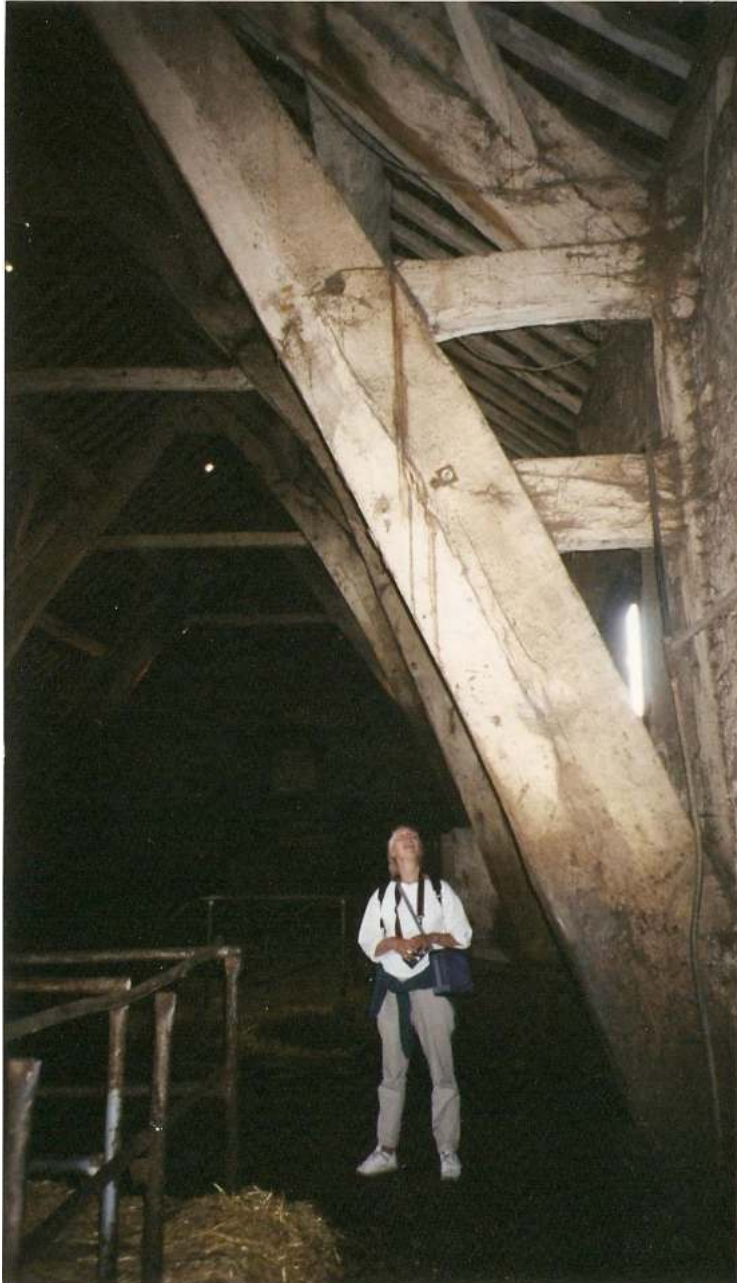

Figure 1

Map showing the location of dated buildings published in *Vernacular Architecture*, 1980-1996.

GB Coastline copyright Bartholomew Databank.

Cruck structures





Thoralby

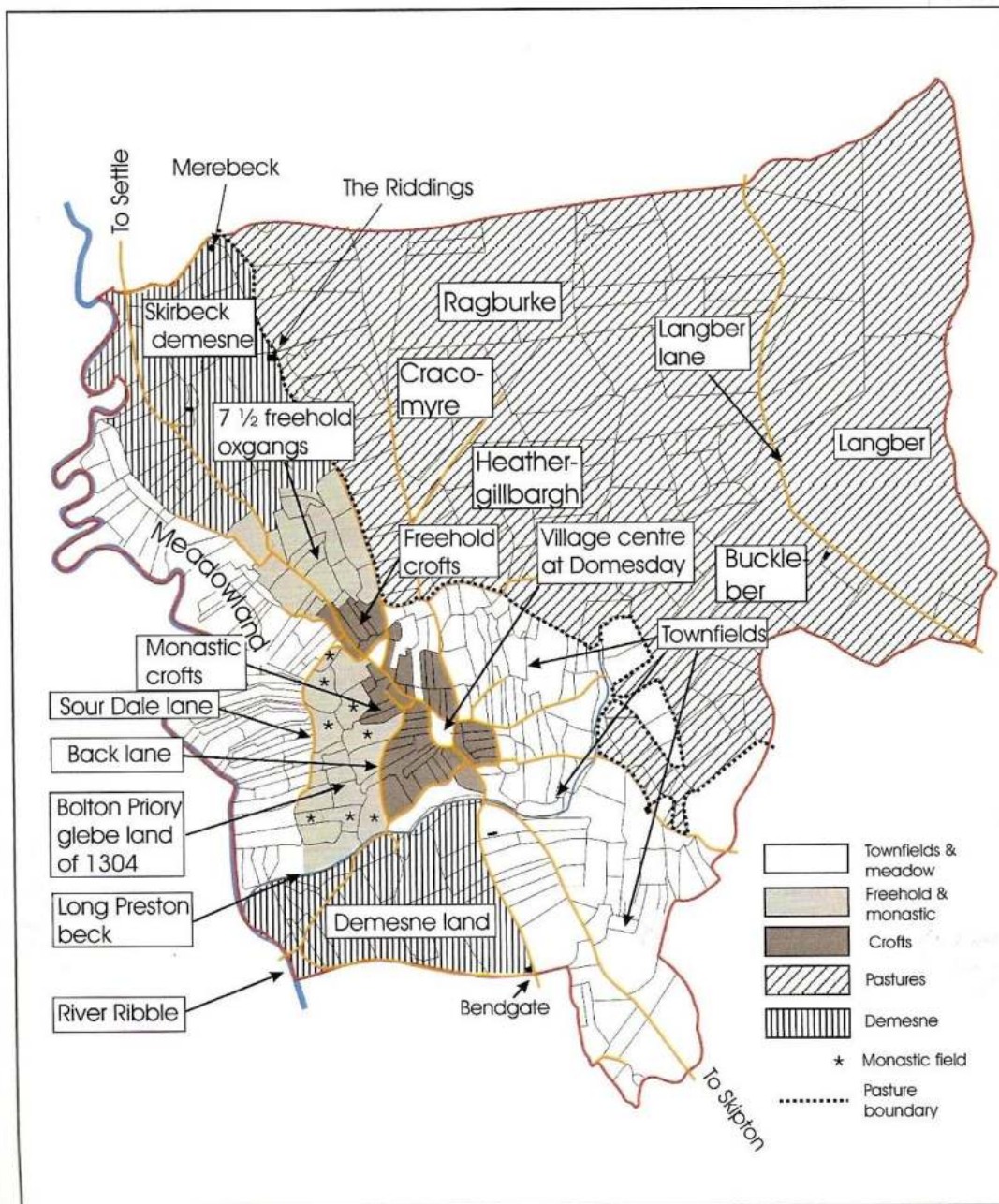

In 1304 Bolton Priory purchased 8 oxgangs for use as glebe land.

Glebe land gave the vicar of Long Preston church some land and income. By 1473 three crofts with barns and tenements of the monastic tenants were probably present by the roadside.

Map; Tony Stephens

Figure 3.1 The Long Preston crofts and field systems



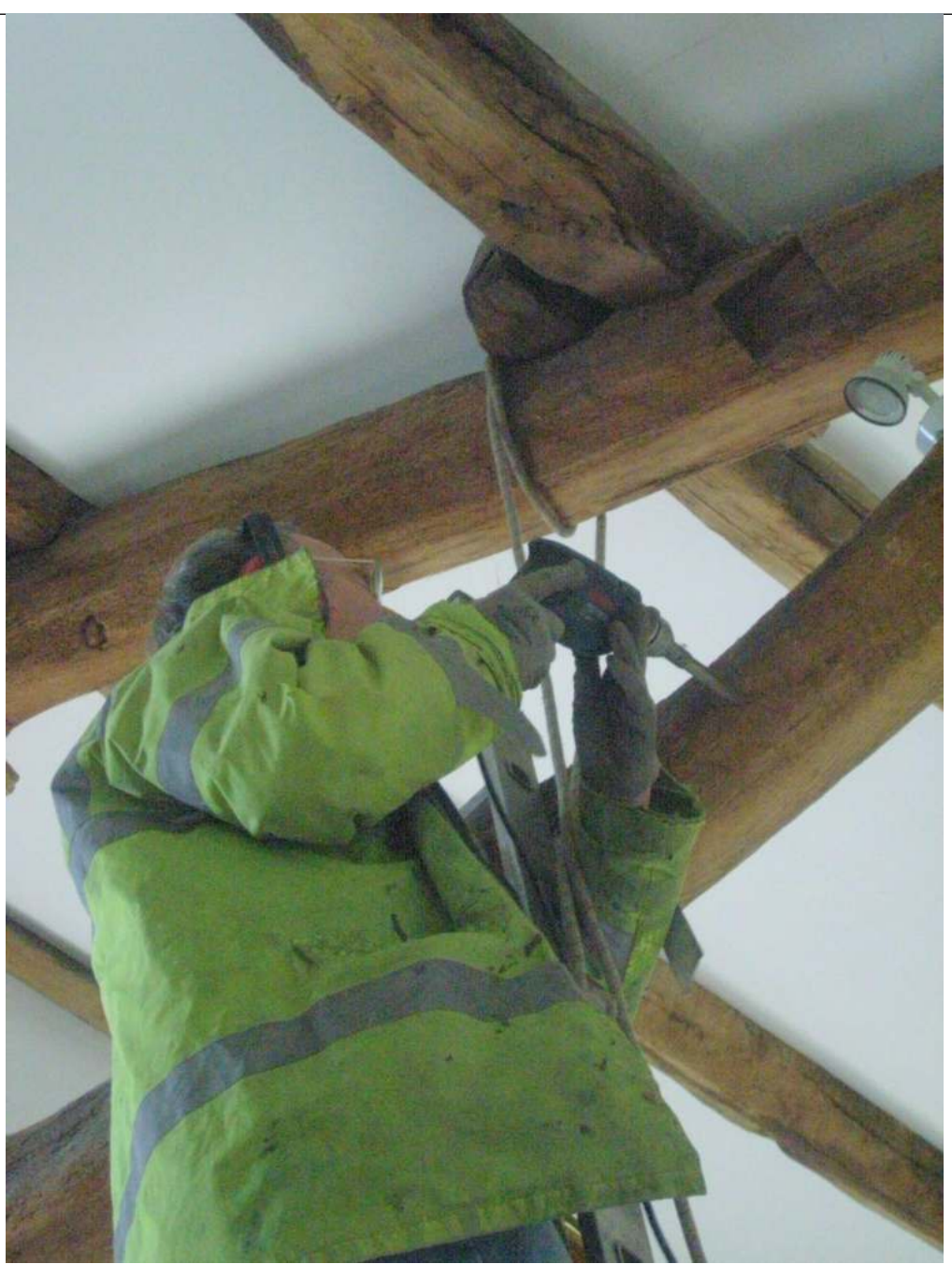

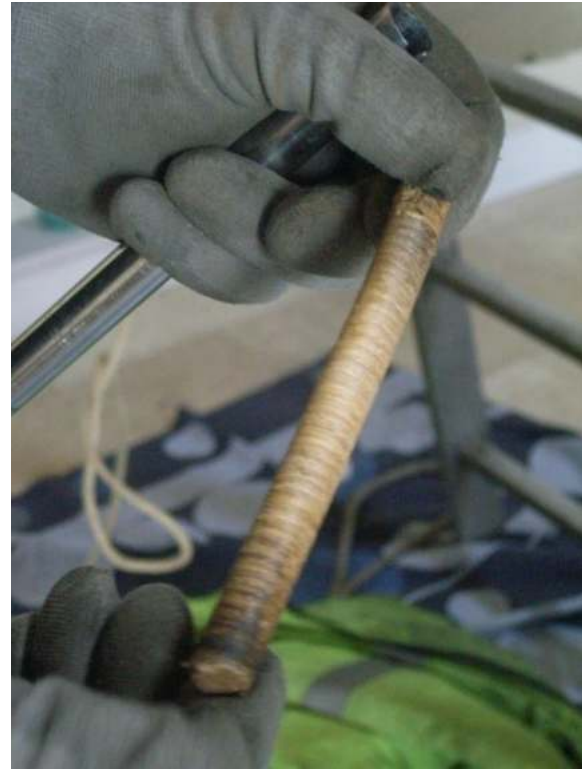

Timber cores or samples

Felling dates.....



Dating old oak timber by dendrochronology



Annual rings

Sap wood and bark





Climate change; the River Thames
at Southwark in 1677



Bolton Park, Wharfedale.

Westy Bank Wood and Lobwood remain only as field names.

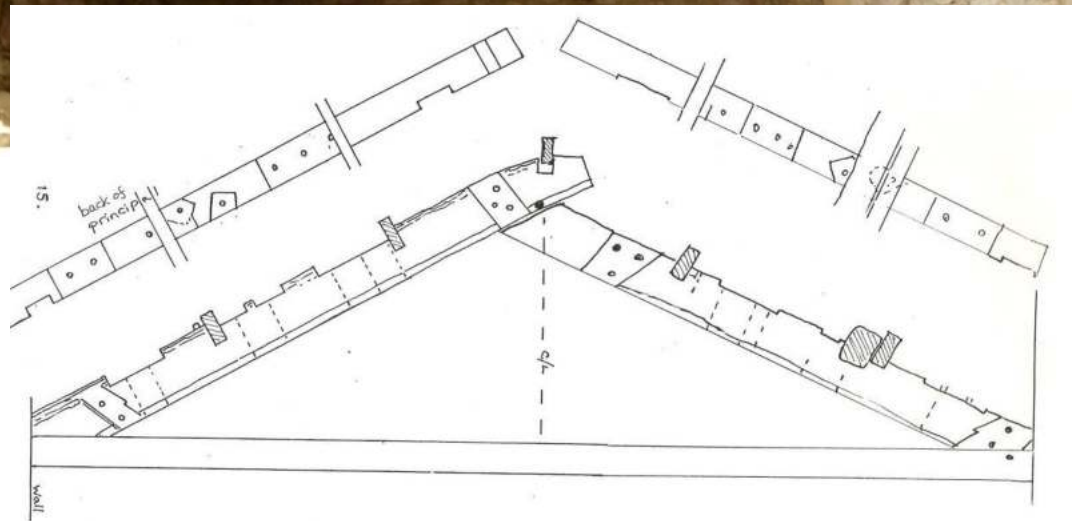
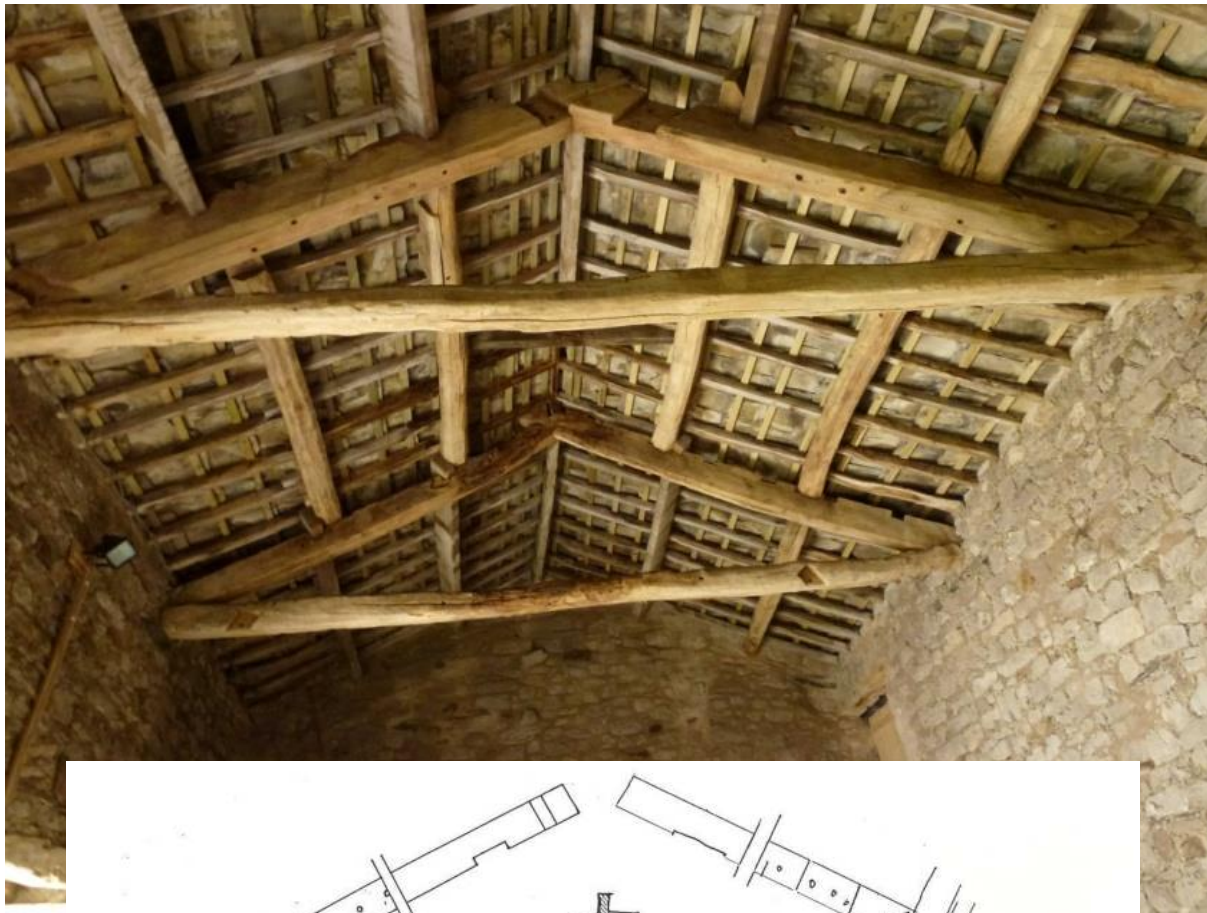

Re-used cruck timbers
from a cruck "great barn"
at Low Winskill. Dates;
c 1570 ; c 1500



Vernacular buildings; datestones





SOME HOUSES

Windy Arbour



North Cote



Kilnsey Old Hall



THE OLD HALL, KILNSEY.

tufa

Kilnsey Old Hall

1672/3 Hearth Tax; Cuthbert Wade has 11 hearths

