

THE GRANGE RYESTONE 1980



Mrs Hartley sent us this Jan 1981  
This house was made out of Ryestone  
House's Coach House and Building some  
Relations of Mr Hartleys lived at  
Ryestone House I was told and they  
had it made for a Relation but  
when I came to Ryestone in 1930s The  
Proctor Family lived there Mr Hartley  
bought it when Miss Proctor went to  
live at SKM.

the Little Pond in the Craft behind  
Rylstone House garden was done away  
with in the 1939-45 <sup>2nd world</sup> war when  
the <sup>craft</sup> was ploughed up to try and grow  
Some feeding stuff for the hens whether  
it was successful or not I've not  
heard. Mrs Mae told me today Feb  
28.1968 that the pond wasn't there when they  
came in 1947. She told me about  
the ploughing I must put this with  
the photo of the little Pond which was  
useful for putting the Ducks by when  
they had young ones, so they didn't  
run over

2 new Bucks Mrs Mac has just  
got have flown off they have  
~~seen~~ were they are one on a  
Roof in Rylstone the other down  
Helton Beck.

Mrs Hodgson said they were used  
to going down to Mrs. Beck at  
their house.

Little Pond   
Page opposite

X

Gilbert told me that Norman Proctor planted these Balsam Poplars at Rylstone, Miss Proctor said he took some cuttings from these Balsam Poplars below Scale House and he planted them by Rylstone Railway Bridge nr Barton House and they took some cuttings to Skelley and brought some back to Mr Proctor at Cracoe.

Miss Proctor had the Rylstone Bus Shelter made in memory of him  
 our Gladys feeding Ducks on that little pond  
 ↗

MILITARY CROSS FOR DALES OFFICER.



...uce a photograph of Lieutenant J. Proctor, younger son of Mr. W. A. Manor House, Rylstone, who, as stated in our columns last week, has been awarded the Military Cross. He joined the Army and went to the Front in 1915 as

the Signalling Officer to the Duke of Wellington's West Riding Regiment. In April, 1916, he was mentioned in despatches. Recently he was made Signalling Officer to the Infantry Brigade.



The House | This little pond doesn't seem to be there now.  
 where Miss Proctor lived at Rylstone. She now lives in Skipton 1961.

Grange see

## The Green Farm:

outside stair cases. were used to get to  
the upper floor. after the top of a Ladder into the bedroom  
from the room below

tile features here, but the other has  
been modernised.

The Green Farm and the Kennel Papers  
Tile Kiln  
Paper



against barn out side steps  
in the

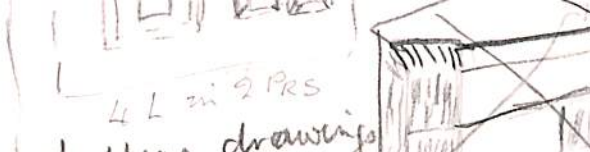

do these drawings  
again.

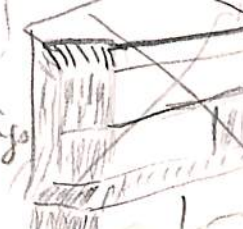

Sharpening Stone  
or grind stone

Sheet Hallowell  
The Green Farm  
Rielston



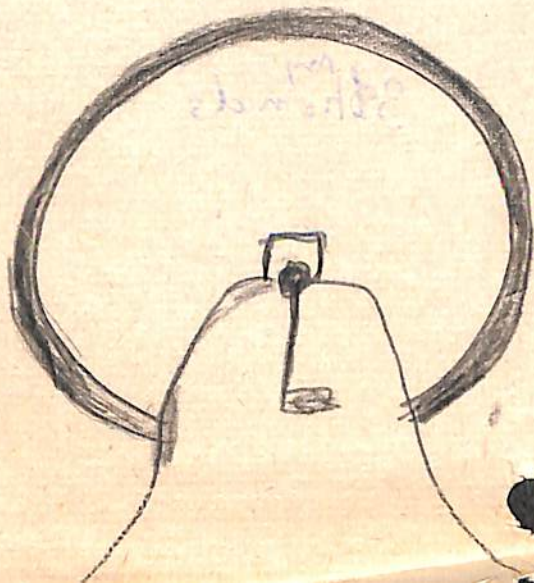

1 Barn was built after the  
House, a workman told  
Mrs Shuttleworth

60 years ago | Alice Carr  
people had to leave that  
House because a woman  
wanted to keep dogs. Before  
that it was a farm.

W.A.W. | door over the Kennels  
Rylstone

1705

Cat →  
Trough  
or Dog  
Trough

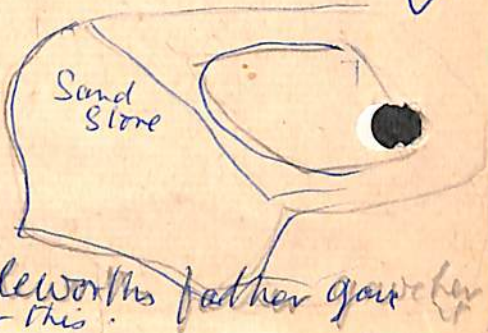

Mrs Shuttleworth's father gave her this.

The Kennels

1962

Rilston

The Barn was  
Mrs Shuttleworth

built after the House a work man told  
a woman had kept dogs there about 60 years ago  
and before that it was a farm.

WAW  
1905  
was over

the doorway -

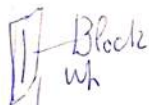

? W - could be Waddilore  
its on Shuttleworth  
Farm.

W It could be Watkinson  
Seale House Property.

Aylsford  
in old Register  
W Waddilore  
Jeoman

Green Lane Rileston

Chimneys Paddets

21 May

The new  
cellar hole  
near the



Barn Door

Door Top



Weather

Mr John Shuttleworth } Rents this from  
Mr Standeven  
Scale House  
The Green Farm. Rylstone 1962

John Shuttleworth died Sept 1980

I used to do some chores for Tommy's wife  
one day I saw a pig gathering  
leaves under its chin so I  
said to Tommy why does it do  
that. and



He told me  
sows do that  
it is a way  
of providing a  
nest for the young  
instinct carried from the wild  
Pigs.

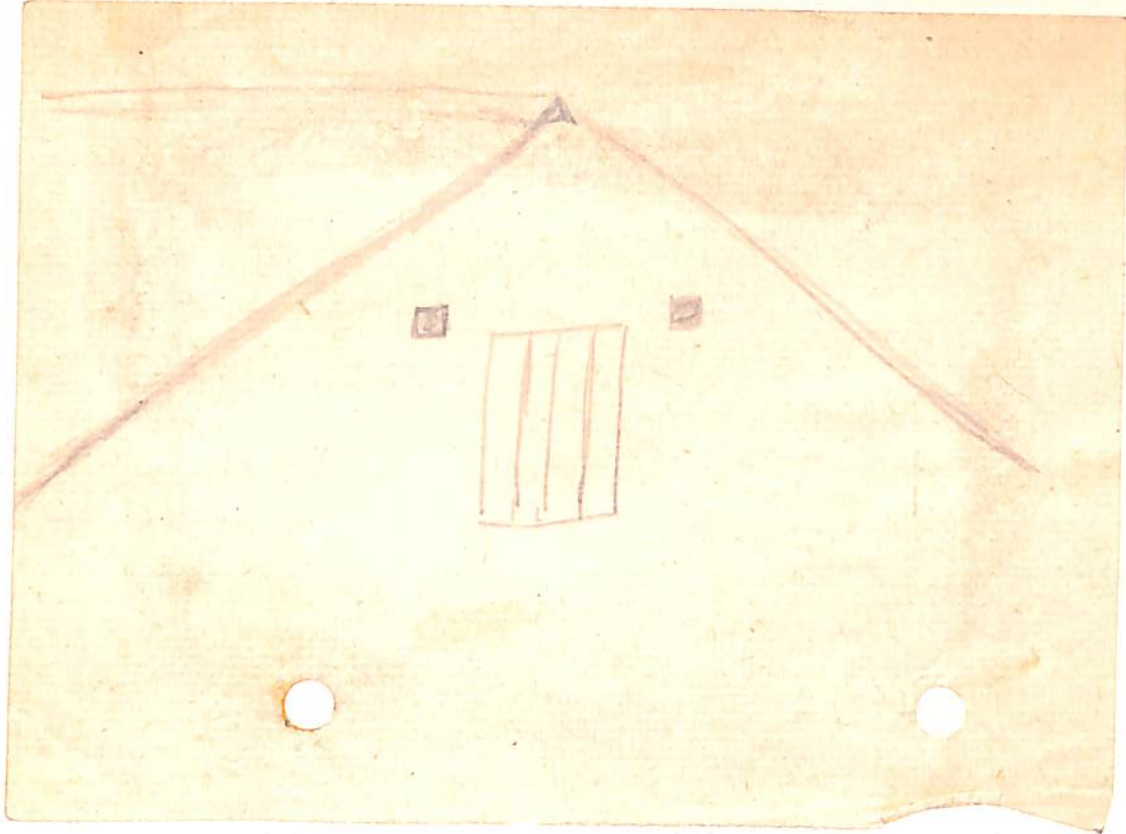



I saw a pig carrying leaves  
under its chin and Tommy  
said they often do that when  
they are going to have young  
ones as if they must make  
a nest or something.  
It must be a built in  
feeling they have.



3 was the day he died.

all the known things for him but  
to no avail. young Richard was  
born just a short while before Robert  
died. They kept Richard in hospital  
a few weeks and brought him  
home as soon as the funeral of  
Robert was over. They have another  
boy David born since then.

John was 21 - in 1978.

Sons of Tommy Shuttleworth

John and Robert  
Shuttleworth

Reylstone 1964.

Taken on a day  
when Robert was feeling  
a bit better, poor  
little chap he did  
suffer from Nov to  
~~May~~, no hope  
for him as they  
havent found a  
cure for that ail-  
ment yet. A Dr  
Ward, <sup>specialist</sup> tried his  
utmost and died

May 1984 I went with Mrs Metcalf  
and Miss Taylforth, who are Relations  
of Mrs (Tommy) <sup>Vera</sup> Shuttleworth and  
their house has been Renovated  
and is lovely now. Then we  
went to Forces Barr which they  
are having made into a house  
that will be lovely when it  
is done, Richard is doing  
all the wiring there was a joiner  
there he was doing a good  
job Vera said Fox House when  
she talked about it, she said  
she was going to live there  
Tommy had done some walling  
they can mow the lawn but  
havent to dig because it was a  
Quaker Burial ground

Yorkshire Observer  
May 4 1956



Mr. Thomas Shuttleworth, younger son of Mr. and Mrs. J. Shuttleworth, of Green Farm, Rylstone, with his bride, the former Miss Vera Marlene Metcalfe, only daughter of Mr. and Mrs. W. Metcalfe, of Stainton Hall, Gargrave, after their wedding at Gargrave Methodist Church on Tuesday.

Sharpening Stone or Grindstone  
at Shuttleworths - Green Farm Rylstone

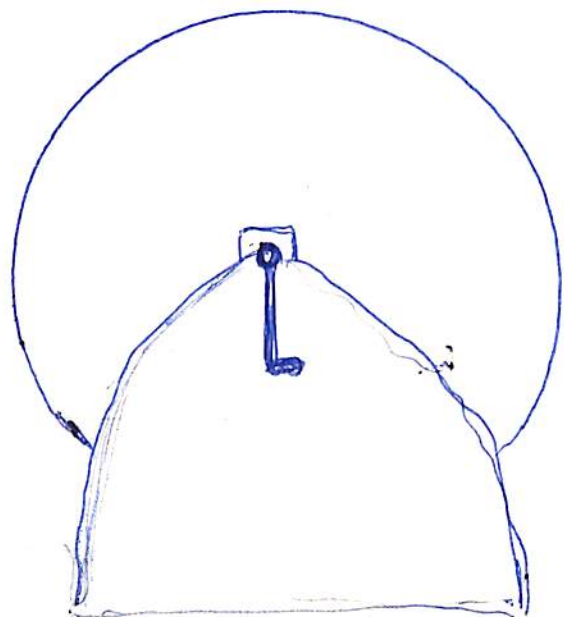
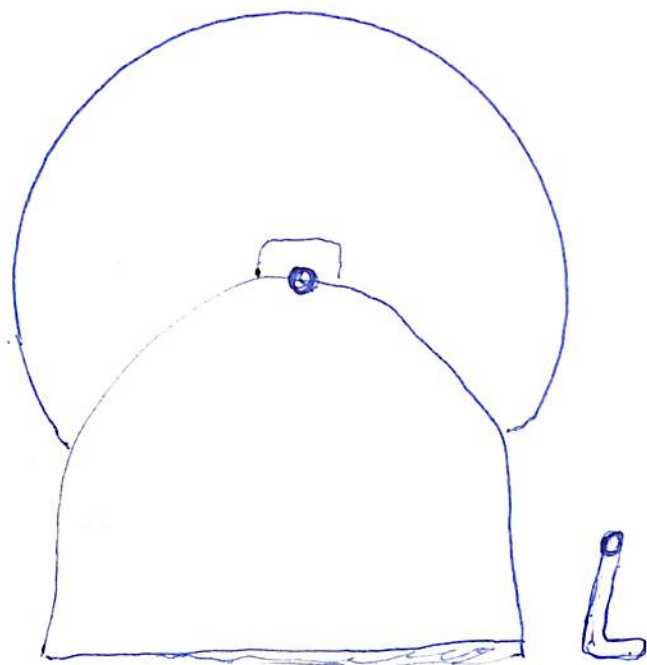

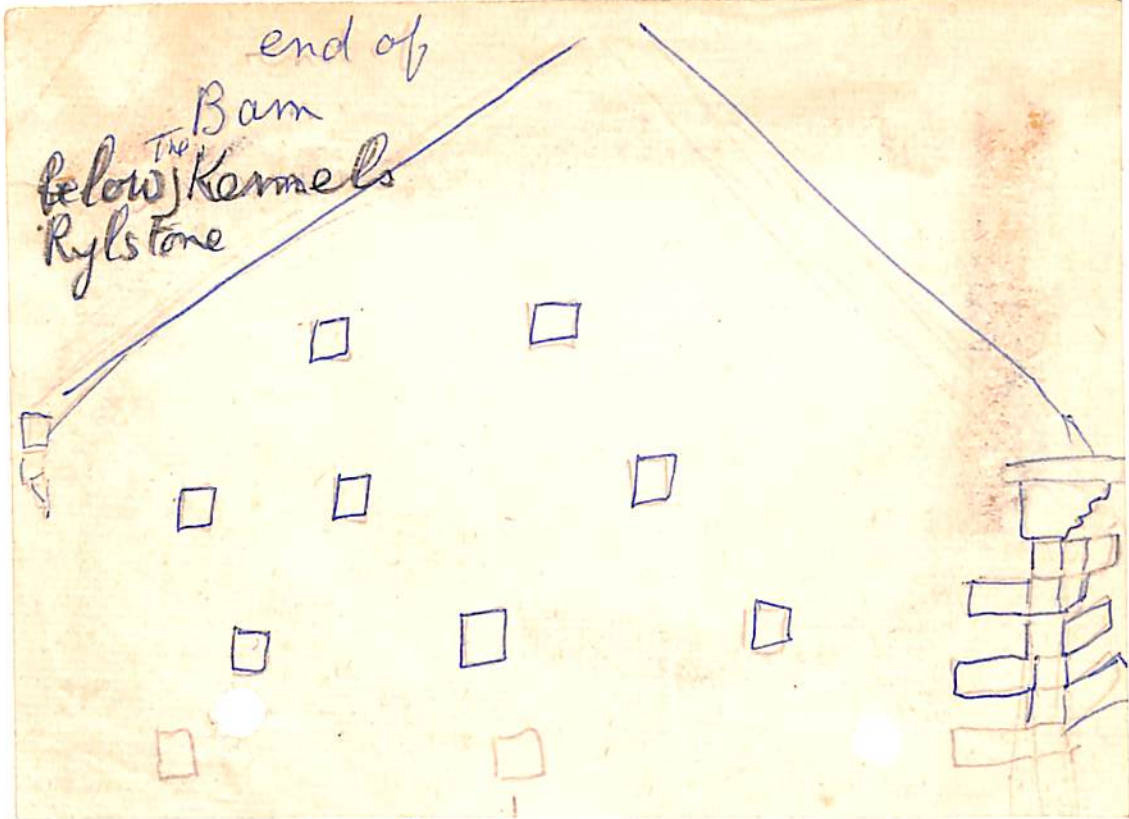

Mr Mrs John Shuttleworth living at The Kennels  
1 Barn was built after the House a workman  
told Mrs Shuttleworth and she told me. in 1962  
that 60 years ago Cilice Carrs people had to  
leave that house because a woman wanted to  
keep dogs, before that it was a farm.

On the Door Head of the Kennels House

WAW  
1705

a cat Trough  
or dog Trough.

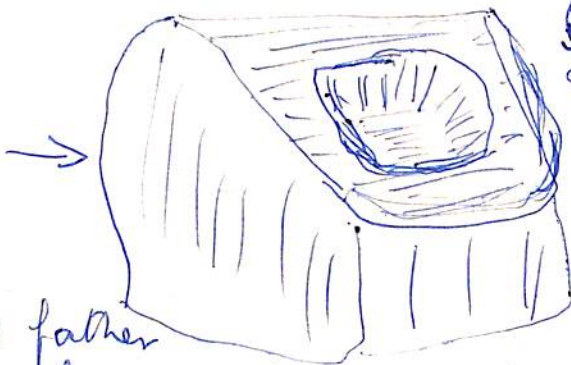

It is  
made  
of  
Sand  
Stone.

Mrs John Shuttleworths father  
gave her this She had it by the House

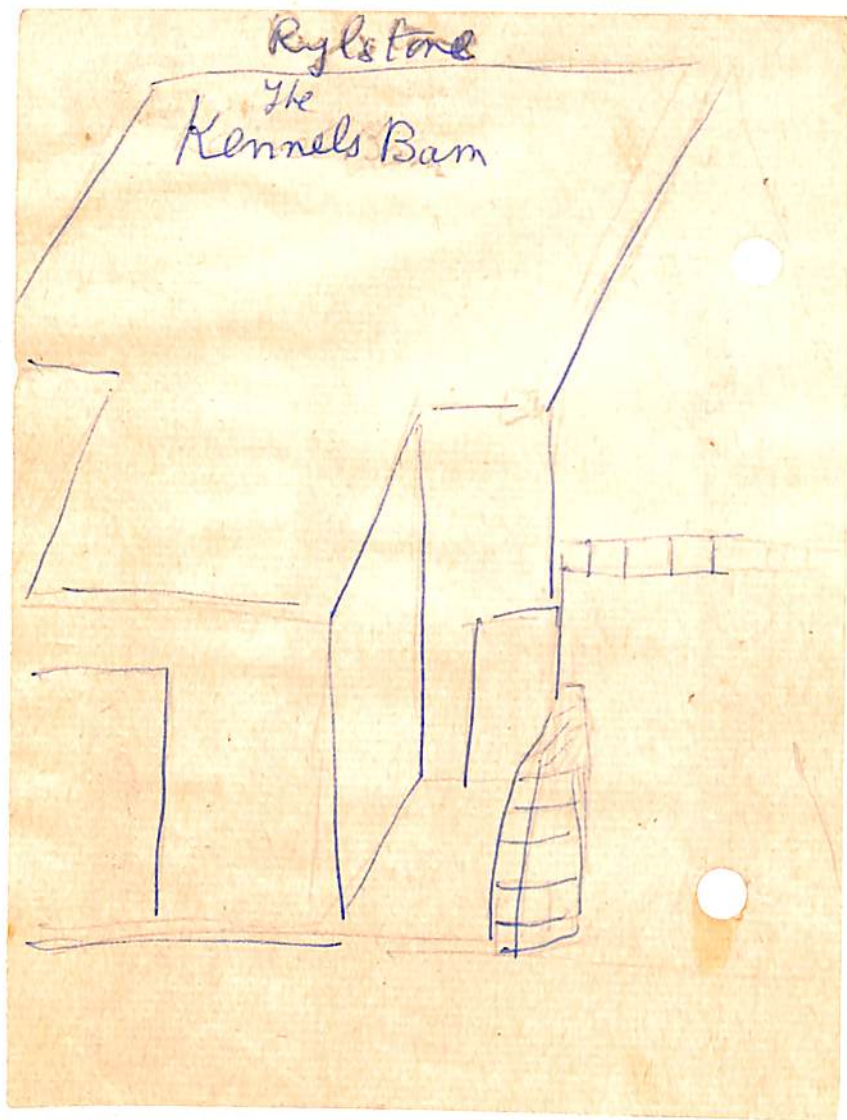

Also this is being made into  
a house

The Barn above The Kennels.

Reylstone

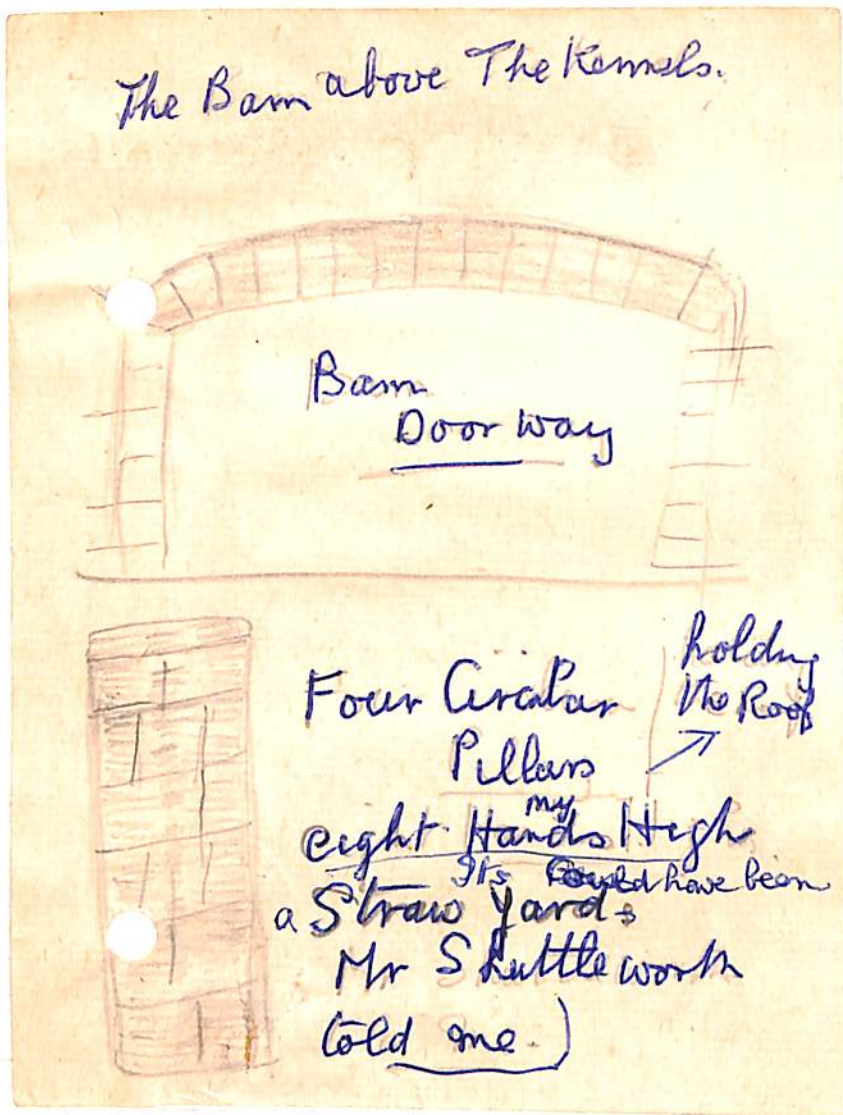

May 1984

This Barn is made into a House  
Now Vera told me. I think she  
said one or two of these had been  
bought by somebody a Embassy

# old Burton House Rilston



This house is based upon the traditional northern plan of the middle ages. It all passage with kitchen at one end and parlour at the other. The roof is very unusual with the ridge across the hall making the parlour appear as an off-shoot. The floor and windows thus come into the gable and the side walls are blank. The kitchen is roofed at right angles to the rest. Carved doorhead RB 1696. - string course and window mouldings are all in a uniform style and certainly belong to the main building period. A backward extension of two rooms and a small parlour has a pair of large Georgian period framed windows say 1730-1760. The main hall roof has been extended over these rooms. all chimneys are asial - main fireplace on back wall of hall opposite the windows. Internal doors are stone framed with curved head.

MULLIONS.

The Main Roof Truss across the Centre of the Hall has strongly Curved Rafters which have all the appearance of being Cruck timbers, It seems likely with the early plan, that the present house replaced a Cruck and Timber built hall and that the peculiar Roof structure is an accommodation to Shortage of long timbers. The now being half Mascorium span between Ridge and Party Walls. Post of Rather



NEW YEAR

and the

CHRISTMAS

for

Best Wishes

With

The Truss is a King unusual style.

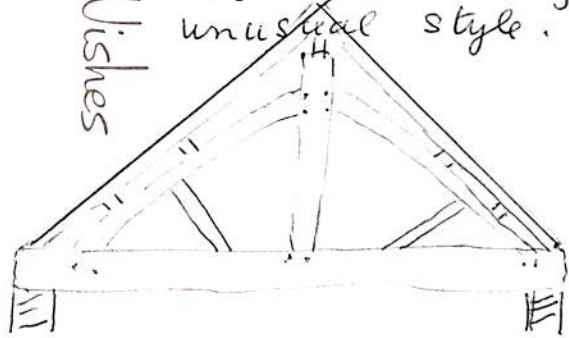



the Deserled Farm  
Old Burton House Ry Elton.  
Has been Renovated around 1980s  
Photo wanted of this now.

Ripton Burlington House (old) 1696. <sup>?</sup> 1698? 1962



1825

Rilston Rakes is an old disused Quakers  
Burying Ground. It is an enclosure of 13  
square yards with an old gateway and lintel  
which is formed by a single Stone & slightly  
curved

The Building in the 19 Century was used for  
a school <sup>Rilston old</sup> The Church Registers have entries  
of burials.

See my papers about Quakers

Railway up the Dales  
The Spade that  
cut the first sod  
used to hang  
on the Wall in  
one of the Rooms  
at Malham Tarn  
House. It  
belonged to Mr  
Walter Morrison

He cut the first  
sod when it was  
started and they  
gave him ~~the~~ spade.  
It was a Silver one.

I wonder who  
had the first  
Ticket,  
and I wonder  
who got the  
spade after  
Mr Morrison  
death in 1921.

# Yorkshire Dales Railway.

(SKIPTON TO GRASSINGTON.)

## Opening of the Line

For Public Traffic,

BY

Lady Wilson,

TUESDAY, JULY 29th, 1902.

## - Programme -

- 12-0 (noon)—Special Train will leave Skipton Railway Station (Skipton and Ilkley Platform) for Grassington.
- 12-25—Arrive Rylstone Station.  
Presentation of Key to LADY WILSON, by MR. WALTER MORRISON.  
Public Opening of Rylstone Station, by LADY WILSON.
- 12-35—Special Train will leave Rylstone Station.
- 12-45—Arrive Grassington Station.  
Public Opening of Grassington Station, and Declaration of the Opening for public traffic of the Yorkshire Dales Railway, by LADY WILSON.  
Vote of thanks to LADY WILSON.  
Addresses by MR. WALTER MORRISON and others.
- 1-30—LUNCHEON.—In Marquees in Field adjoining Station.—Entrance for Directors and invited friends from Station Yard only, and for the general public from the Field.
- 4-0 —AFTERNOON TEA at the Old Hall Inn, Threshfield.
- 5-30—Special Train will leave Grassington for Skipton, calling at Rylstone.

This is the reverse side of a railway pass issued for the opening of the railway line from Skipton to Grassington in 1902. It has been sent to "The Keighley News" for forwarding to Keighley Museum by Mr. J. Bottomley, who now lives at Southport. The pass was issued to shareholders and Mr. Bottomley adds: "My mother was a shareholder and probably used the tickets on this occasion."

Rylstone Parish Mag for Aug.

Tues July 29<sup>th</sup> 1902 12-25 PM.

The first passenger train steamed into Rylstone New Station which was  <sup>tastily</sup>  favourably decorated and compared with Grassington

The school children greeted the train with much cheering

Mrs Roundell opened the station with a golden key. The whole ceremony occupied about 10 mins.

The train had a heavy load of passengers and several other trains ran during the day. a large number of people were carried up and down the line

Rylstone Station) <sup>this is</sup> in the Snow



There isn't much left now of the Buildings  
in 1968.

Gilbert recognized Mr Best the Station Master  
he is the one stood by himself ~~and~~ he has a  
Moustach, <sup>Photo</sup> this was taken about 50 years ago  
Nothing left of the Station now 1970 just  
the line thro to Swadlow Quarry that's all

Hugh Pye has got the Coal Stays for his  
Coal Round, <sup>1980's</sup> Pye <sup>let</sup> his <sup>Coal Round</sup> <sup>at Skirethorns</sup>  
The Station house was built about 1922-3. Gilbert  
told me, the Station Master used to live at  
the Kennels Rylstone, before the Station house was  
made. The House was sold to Jack Capslick  
he sold it, to Fox Allens of Skipton and now  
it has been sold again twice and its 1975  
Mr. Mrs. Betts



SPICER  
AQ  
R1 2/15/69

drawing done by  
Harold Thompson

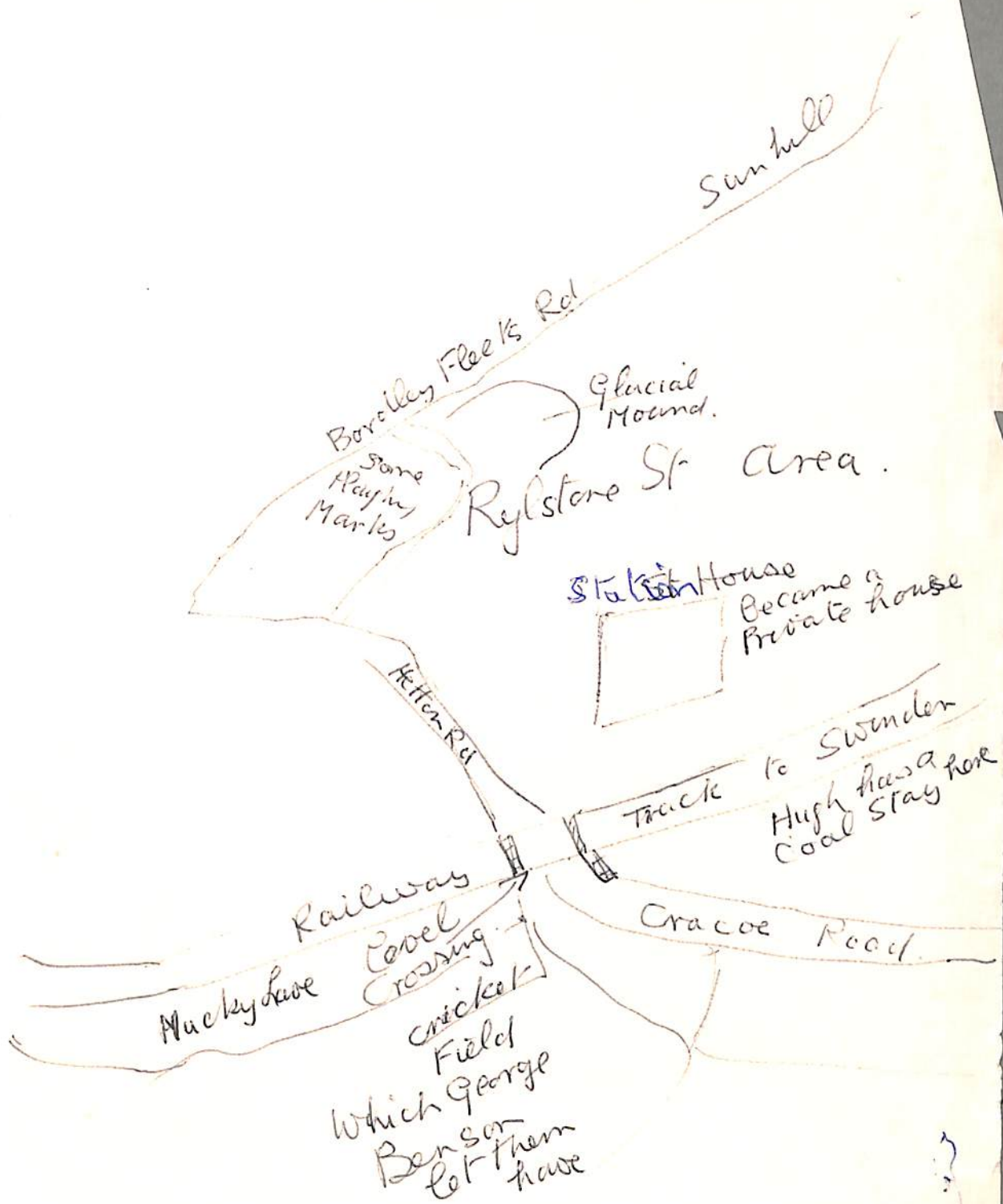

The Cairn, or War Memorial  
is set up in  
Remembrance of those who fell in the  
1914 - 1918 Great War. for Rylstone  
Hetton  
Bordley  
Cracoe

Up at the Cairn  
on a really clear day.  
I've heard it said  
you can see Morecambe Bay.

The Fell up there  
from the Cairn to the Cross  
which is Bracken lung,  
and ~~lots~~ of Moss.

There's huge Rocks.  
of Millstone Grit  
all round the Cairn  
I've walked to 'em.

Helen Ward

Peche

Sasca / Northern Germany

ON. Old Norse

Is there any Roman Names  
Round about us.

Bar House, Toll Bar

Mean

What does Crook  
Where

Mean

Crook Danish

Rise Anglo Saxon. for higher  
Level.

Race Course

Norton Towers

Waterford Gill.

Scale House

Sandy Beck.

Toll Bar.

Crook Rise

Rough Haw

Anglo Saxon } Anglo Saxon

Rough - Hawing Promising enclosure

Shark Haw ?  
Anglo SAXON

Angles SAXON (Angles  
German Tribe who in the 5<sup>th</sup>

Century crossed over to Britain  
along with bands of Saxons and Jutes

British are we.  
How