

Notes

1533 - 1555?

Building ID

LP14

YDNPA traditional farm buildings census record sheet

SPRING WOOD

NGR (8 figs)

Building name (if known)

SD 82296450

In field ~~at roadside~~ NW of Blue Cross, near Settle boundary,
off right of way Springs Wood

Parish

Site visit date

Recorded by

LANGCLIFFE

26-8-2010

AA: PO

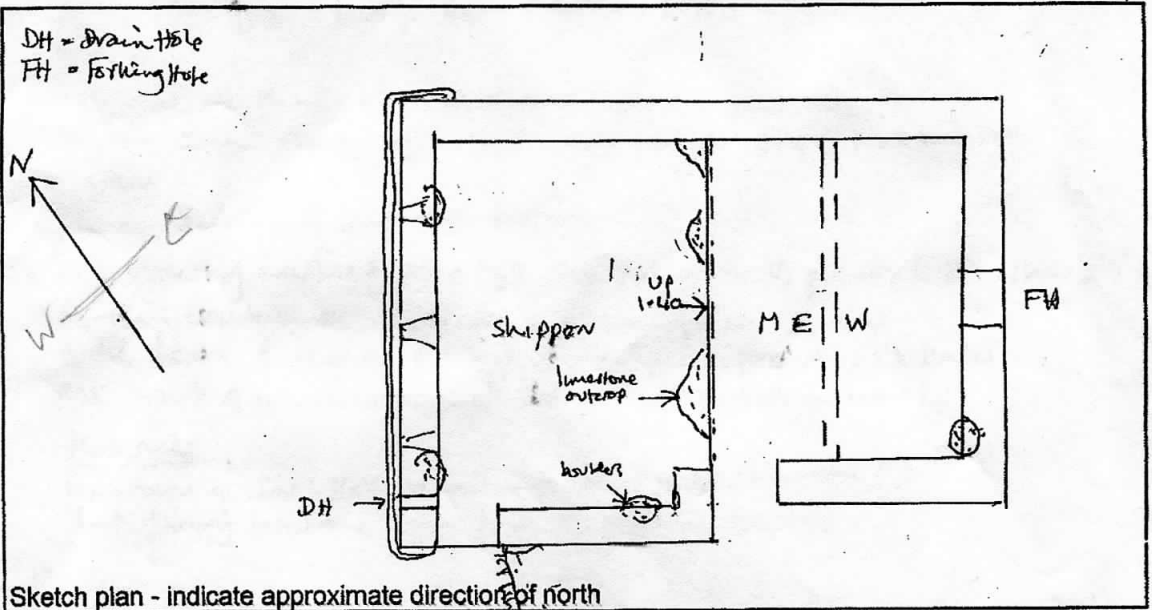

Wall thickness measured at height of 1m

Gables 60 cm
other elevs 62 cm
outshots -

Approximate dimensions

Length 9.10 (4.30 + 4.80)
Width 6.19 (east end) + 6.75

Inscription



'EH' carved on E truss

No. of roof trusses

2

raised eaves

Photographs

(Please tick box when the relevant photographs have been taken)

External elevations	Doors	Windows/forking holes, etc	Ventilators	Other wall details
<input checked="" type="checkbox"/>	<input checked="" type="checkbox"/>	<input checked="" type="checkbox"/>	<input checked="" type="checkbox"/>	
Internal elevations	Fittings	Roof	Lamp recess	Other internal details
<input checked="" type="checkbox"/>		<input checked="" type="checkbox"/>		

Landscape

Views from building

Views towards building

	<input checked="" type="checkbox"/>
--	-------------------------------------

Please use the rear of this form to record additional detail not covered here

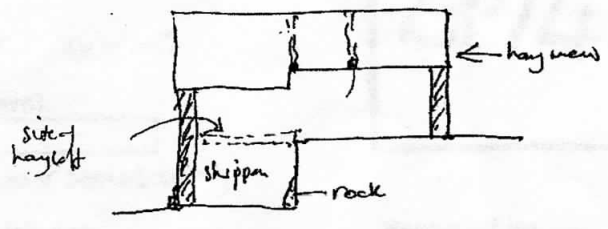

Barn of "bank barn" form with haymow over-skipper in Cornish style. Possibly cruck built c. 1600 or earlier. E. 18^c roof truss

Exterior

Large double plinth at l.w., w., ead. Square ventilators. W gable shows change of quoins and possible steeper thatched roofline.

Interior

Broken remains of dark slate bookies

Roof trusses of morticed apex type with raking struts, perhaps E 18^c. Member '1' x '11'
 Re-used cruck timber includes a portion of a cruck blade; a tie beam of a cruck purlin; 2 principal rafters of cruck blades one joint of which is mortised halving and perhaps nodeval.

Materials

limestone quoins; slaty sandstone lintels (Sandford sandstone?)
 Thick flaggy sandstone roofing flags in graded courses.

