

Facsimile of Old Engraving of Tumulus near Stackhouse (A.D. 1784.)

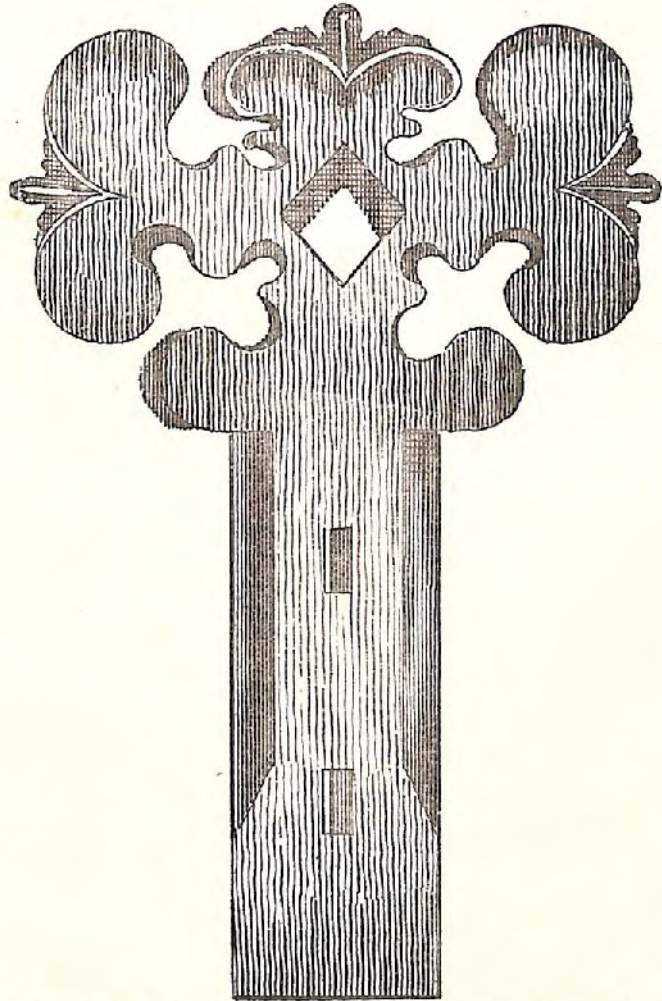

Facsimile of Old Engraving of Giggleswick
Cross (A.D. 1784.)



Ancient Brooch or Ornament found inside
Settle Old Cross.

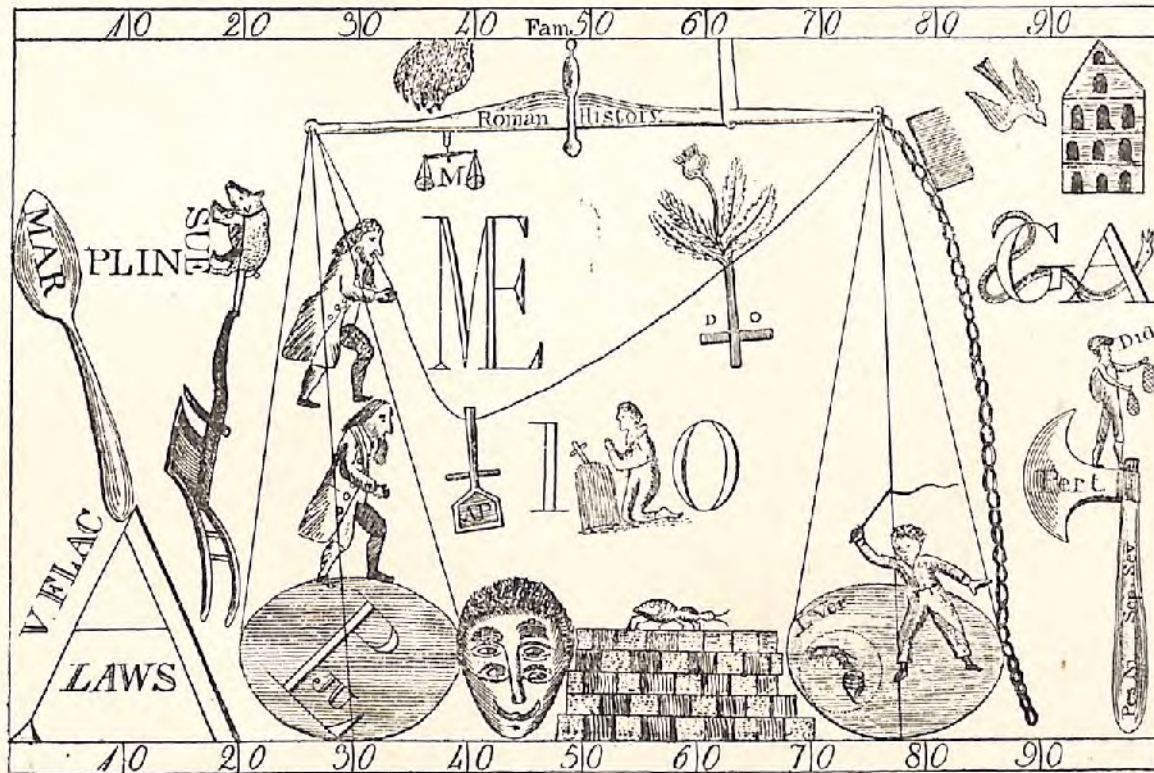

Page from Broader's "System of Artificial Memory," showing events of the 2nd century.



"CHALICES OF GIGGLESWICK CHURCH."



REV. RICHARD FRANKLAND.

BORN at Rathmell, Nov. 1st, 1630. Graduated B.A. 1651, M.A. in 1655. After holding several livings he was ejected by the Act of Uniformity 1662. Commenced an "Academy" at Rathmell, where he educated over 300 young men. He also taught at Calton Hall, &c. Excommunicated and absolved in Giggleswick Church. Died Oct. 1698 and buried in Giggleswick Church.



H. Howson

DEAN HOWSON.

BORN at Giggleswick, 1816, educated at the Grammar School, and afterwards went to Cambridge, where he took his degree in 1837. Private tutor to several well-known men, and then Head of Liverpool College. Author of many works and important articles. Appointed Dean of Chester, 1867. Died Dec. 15th, 1885.

The Grammar School of King Edward the Sixth OF GIGGLESWICK

RE-FOUNDED AND ENDOWED BY ROYAL
CHARTER DATED 26TH MAY, A.D. 1553.

*New Scheme approved by the Queen's Most Excellent Majesty in
Council on the 9th day of August, 1872.*

The Governing Body.

CO-OPERATIVE GOVERNORS.

- HECTOR CHRISTIE, Esq., Langcliffe Place, Settle.—*Chairman.*
WALTER MORRISON, Esq., Malham Tarn, Settle.—*Vice-Chairman.*
JOHN BRIGG, Esq., M.P., Kildwick Hall, Keighley.
JAMES ANSON FARRER, Esq., Ingleborough, Clapham, Lancaster.
Rev. R. C. GARNETT, The Rectory, Salwarpe.
THE RIGHT HON. SIR UGHTRED J. KAY-SHUTTLEWORTH, BART., M.P., Gawthorpe
Hall, Burnley.
W. G. PERFECT, Esq., Stainforth, Settle.
RICHARD FOULIS ROUNDELL, Esq., Gledstone, Skipton.

REPRESENTATIVE GOVERNORS.

- SIR FRANCIS SHARP POWELL, BART., M.P., Horton Old Hall, Bradford. (*Elected
by the Master and Fellows of St. John's College, Cambridge.*)
THOMAS EDWARD YORKE, Esq., Bewerley, Pateley Bridge, Yorkshire. (*Elected by
the Master and Fellows of St. John's College, Cambridge.*)
THOMAS PENWICK PENWICK, Esq., Burrow Hall, Kirkby Lonsdale. (*Elected by the
Justices of the Ewecross Division of the West Riding.*)
J. G. ROBINSON, Esq., Cradiale, Settle. (*Elected by the Justices of the Staincliffe-West
Division of the West Riding.*)
PROFESSOR ARTHUR SCHUSTER, F.R.S. (*Elected by the Principal and Professors
of the Queens College, Manchester.*)
PROFESSOR ARTHUR J. GRANT. (*Elected by the Council of the Yorkshire College.*)
MATHEW AMCOTT'S WILSON, Esq., Eshton Hall, Gargrave. (*Elected by the Technical
Instruction Committee of the West Riding County Council.*)
RALPH C. ASHETON, Esq., Hall Foot, Clitheroe. (*Elected by the Governors of
Clitheroe Grammar School.*)
ROBERT CLOUGH, Esq., Beechcliffe, Keighley. (*Elected by the Governors of Keighley
Grammar School.*)
Rev. A. INGILBY, Harden, Clapham, Lancaster. (*Elected by the Governors of Kirkby
Lonsdale Grammar School.*)

Clerk to the Governors,

THOMAS BRAYSHAW, Esq., Solicitor, Settle.

Head Master.

Rev. GEORGE STYLE, M.A., formerly Fellow of Queens' College, Cambridge.

Assistant Masters.

Upper School.

- WILLIAM MARSHALL WATTS, D.Sc. (Lond.), B.Sc. (Victoria University), F.C.S.
STEPHEN P. SMITH, Esq., of the University of Heidelberg.
J. CONWAY REES, B.A., late Exhibitor of Jesus College, Oxford.
H. M. F. HAMMOND, B.A., late scholar of Emmanuel College, Cambridge.
W. J. BENSLEY, M.A., late Exhibitor of Emmanuel College, Cambridge.
H. W. WILKINSON, M.A., St. John's College, Cambridge.
C. H. HAYWARD, B.A., late Exhibitor of Corpus Christi College, Oxford.
Rev. H. M. GORHAM, M.A., late Scholar of St. Peter's College, Cambridge.

Junior School.

- PHILIP BEARCROFT, M.A., Keble College, Oxford.
Rev. ARTHUR CROSS, M.A., Christ's College, Cambridge.
GIFFORD BROMLEY MANNOCK, Esq.

Drawing.

Rev. ARTHUR CROSS, M.A.
Certificated under the Committee of Council on Education.

Music.

- THEODORE H. H. WALROND, M.A., Balliol College, Oxford, Organist and Choir
Master.
LEONARD WATKINS, Esq., late Scholar of the Royal College of Music (Violin).

Gymnastics and Drill.

SERGEANT-MAJOR CANSDALE.

GENERAL STATEMENT.

General Statement.—This ancient School, remodelled, rebuilt and greatly enlarged in the course of the last thirty years, provides, in a district of singular beauty and under most healthy conditions, a liberal education for boys up to the age of nineteen who intend to proceed to the Universities, to compete for appointments in the Civil Service, or to pass the Entrance Examinations for Woolwich or Sandhurst. It also provides a thoroughly sound education for those who wish to qualify themselves for their profession, or for a commercial career.

The whole internal organisation, management, and discipline of the School is in the hands of the Head Master.

Religious Instruction is given generally throughout the School.

The Chapel, the munificent gift of Mr. Walter Morrison, designed and completed by Mr. T. G. Jackson, R.A., is remarkable for its romantic site, its bold design, and the magnificence of its interior. The foundation stone was laid on the 7th of October, 1897, by the Duke of Devonshire, K.G., to commemorate the sixtieth year of the reign of Her Majesty Queen Victoria; and the building was dedicated on the 4th of October, 1901. The Head Master is responsible for the Services.

The subjects of **Secular Instruction** are the English, Greek, Latin, German and French Languages and Literature; Arithmetic; Mathematics, pure and applied; Geography, political and physical; History; Chemistry and Physics; Botany and Physiography; Drawing; Vocal Music; Swimming and Gymnastics.

The foregoing subjects are taught in different parts of the School in such a way as to make the work in each as thorough as possible.

Ancient and Modern Languages.—Boys who are likely to go to a University learn Latin, Greek, and (as a rule) French; those who desire a "Modern" course of work take Latin, French, and (from the Fourth Form upwards) German; while those who omit Latin are advised to give additional time to French and German or to Shorthand and commercial subjects.

For Mathematics and Science, which occupy a prominent place throughout the School, the boys are arranged in Sets, which are, to a considerable extent, distinct from the division into Forms.

Physical Science.—Chemistry and the various branches of Physics (including Electricity and Magnetism) are part of the ordinary work of the Upper School; the work is founded on instruction in Practical Chemistry and Practical Physics.

The **Laboratories** (Chemical and Physical) now largely extended, are well provided with apparatus for experimental work in physical science.

Drawing, artistic and technical, forms part of the regular work, except in the Fifth and Sixth Forms.

Music and Singing are encouraged throughout the School.

Sixth Form Work.—For boys who reach the Sixth Form special arrangements are made (so far as is necessary) for preparing them for Scholarships at the Universities, and for Woolwich or Sandhurst.

Examinations.—The School is examined annually by Examiners, unconnected with the School, appointed by the Governors. The Examiners report to the Governors on the proficiency of the scholars and on the position of the School as regards instruction and discipline. Prizes and Exhibitions are given upon the result of the examination. Other examinations are conducted by the Masters of the School.

Admission.—Boys are admitted in January, May, and September. Application for admission to the School must be made to the Head Master, upon a printed form, which he will supply to all applicants.

The examination for admission is graduated according to age, but it never falls below the following standard—viz., Reading, Simple Dictation, the First Four Rules of Arithmetic, the Outlines of the Geography of England: it is held usually on the day before the commencement of each Term.

Application for admission should be made early. In the case of a boy who has already been at School, a certificate of good conduct is required from the School he is leaving.

Junior School.—Boys are admissible into the Junior School at the age of nine. In it they are carefully grounded in English, Latin, French, Arithmetic, and Geography, for promotion into the Upper School. No boy may enter the Junior School who is above thirteen years old, or remain in it after he is fourteen.

Upper School.—Boys are promoted from the Junior School into the Upper School as they are qualified. Other boys are admitted upon passing an easy entrance examination, provided they are under fifteen years of age: boys over fifteen must be prepared to join Forms suitable to their age.

No boy may remain in the School after the end of the School year in which he attains the age of nineteen, except by permission of the Head Master.

SCHOOL BUILDINGS.

The School Buildings are close to the Boarding House. Besides the large School Room there are fifteen admirable Class Rooms and Lecture Rooms, so that every Form works under the most favourable conditions: special attention has been paid to lighting, warming, and ventilation.

The Boarding Houses are under the control and management of the Head Master, who is aided by Resident Assistant Masters. Boarders have ample opportunity of obtaining additional help in their work, and younger boys prepare their evening work under a Master's supervision.

Boarding Houses.—The **Hostel**, or principal Boarding House, resembles the most convenient Houses at the best English Schools, containing numerous Studies and Dormitories so arranged that each boy has a separate compartment.

The Hostel is divided into five Dormitories, each containing from twenty-five to thirty boys, under the immediate charge of J. C. Rees, Esq., P. Bearevoft, Esq., H. M. F. Hammond, Esq., W. J. Bensley, Esq., and S. P. Smith, Esq.

'**Bankwell**,' a separate Boarding House for younger boys.—Boarders at Bankwell enjoy all the advantages of other members of the School, but their work in the early morning and in the evening is done in their own Boarding House; in other respects also the arrangements at Bankwell, which is under Mr. Mannoek's charge, are made with special regard to the requirements of boys under thirteen years of age. At the age of thirteen, boarders pass on from Bankwell to the Hostel.

The **Medical Officer** of the School visits the Boarding Houses daily so that he may see not only boys who are ill, but any boy who requires special supervision. Each boarder is charged half a guinea a term for medicine, nursing by trained nurses, the use of the Sanatorium and all Medical Attendance, except fees for consultations.

The **School Library** (towards which every boy pays 2s. a term) contains about 3,000 volumes and is rapidly increasing; it is open to the upper boys for reading and reference: most of the books may be taken out by any boy.

The **Museum** contains the interesting Collection of Cave Remains presented by the Victoria Cave Excavation Committee, and good collections of Minerals, Fossils, Birds, Eggs, &c. Contributions are invited from boys and their friends.

The **Swimming Bath** (in which the water is 60 feet by 26 feet and from 6 feet to 3 feet deep) is close to the Hostel, within a covered building which is warmed. The water also is warmed to 70° F., so that bathing continues throughout the year. Beginners are carefully taught to swim.

The **Gymnasium** (built by subscription in 1886 at a cost of about £1,200) is used by all boarders under adequate superintendence and instruction.

All boarders, *unless parents object on account of health*, are charged at the end of each term 7s. for the Bath and 7s. for instruction in Gymnastics. Day boys using either the Bath or the Gymnasium are charged the same.

The **Joiner's Shop** is in the large room of the Old School. Systematic instruction is given by a well-qualified Joiner, at a charge of 7s. a term.

Games, &c.—Much attention is given to physical development. Besides Swimming, Gymnastics, and Drill, all boys, not hindered by health, are expected to take part regularly in Cricket, Football and other games. The Playing Fields, which are about forty acres in extent, adjoin the School premises.

July, 1902.

Giggleswick School, Settle, Yorkshire.
 All communications on School matters should be addressed to the Head Master, Yorkshire and Lancashire, and with Scotland, by way of Carlisle.
 Midland Railway. Communication is easy with London and the large towns of the School is about a mile from the Settle and Giggleswick Stations, on the

of any pupil, or a Term's fees are charged.
 A Term's notice must be given to the Head Master, in writing, before the removal of Spring Vacation, of four weeks, commences early in April.

Vacations, &c.—The Summer Vacation commences on the Thursday before the first Monday in August, and lasts seven weeks; the Winter Vacation commences on the Thursday in the week before Christmas week, and lasts four weeks; the

The Akroyd Scholarship.
 Giggleswick has the privilege of sending Candidates to compete for the Hastings Exhibitions, value £90 a year for five years, at Queen's College, Oxford, and for Exhibitions, at Christ's College, Cambridge.

Boys educated for two years at Giggleswick have a preference to two GAPP more Exhibitions tenable at some University or other place of liberal education.

The Governors also intend to establish, when the state of funds admits, one or more Exhibitions tenable at some University or other place of liberal education.

The Governors also intend to establish, when the state of funds admits, one or more Exhibitions tenable at some University or other place of liberal education.

for competition in July, 1902. Candidates for admission will be eligible as well as boys already in the School. State Exhibitions are offered as vacancies occur, to be competed for by boys educated in Elementary Schools of the ancient parish of Giggleswick.

SCHOLARSHIPS AND EXHIBITIONS.

at a charge of six guineas a year. There is an excellent Organ in Big School, is given

Music.—Instruction in Instrumental Music, Organ, Piano or Violin, is given These charges are made at the end of each term.

Gymnastics, unless they are prevented on account of health from using the Bath and Gymnasium. Day boys using the Bath or Gymnasium are charged the same.

charged a guinea a year for the use of apparatus and chemicals. While all Boarders are charged a guinea a year for the Bath and a guinea a year for instruction in

A statement is forwarded before the commencement of each term.
 They are made to the Crown Bank, Settle, to the credit of the Governors.
Method of Payment.—Payments must be made terminally in advance.

For Boarders under fifteen years of age the annual charges are: Tuition, £15; Board and Washing, £18; making together £33. For Boarders over fifteen the charges are: Tuition, £24; Board and Washing, £18; making together £42 a year.

The Tuition Fee for Day boys is £12 a year.
 School Fees.—The Entrance Fee for Boarders is £25, and for Day boys £1.

PAYMENTS.

The Water supplied to the School comes direct to the School premises from a copious and excellent spring belonging to the Trust.

The system is inspected periodically and periodical reports are made to the Inspectors of the Local Government Board.

Drainage.—The system of drainage is in accordance with the best principles of sanitary science. The plan was made and its execution approved by experienced

cases.
 removed there. There are also wards away from the Boarding Houses for doubtful from other buildings, and isolated. Cases of contagious disease are immediately
Sanitary Provisions: Sanatorium.—The School Sanatorium is separated large Covered Playground (100 feet by 50 feet) available.

Covered Playground.—When the weather prevents out-door games there is a



DR. GEORGE BIRKBECK.

BORN at Settle, 10th January, 1776, brought up a Quaker, was the founder of Mechanics' Institutes. Great friend of Lord Brougham, who penned the Epitaph on the monument to Dr. Birkbeck's memory, recently removed from Settle Mechanics' Institute to Giggleswick Church. Died 1841.



Seals of the Priory of Finchale attached to
Giggleswick Church Charters.

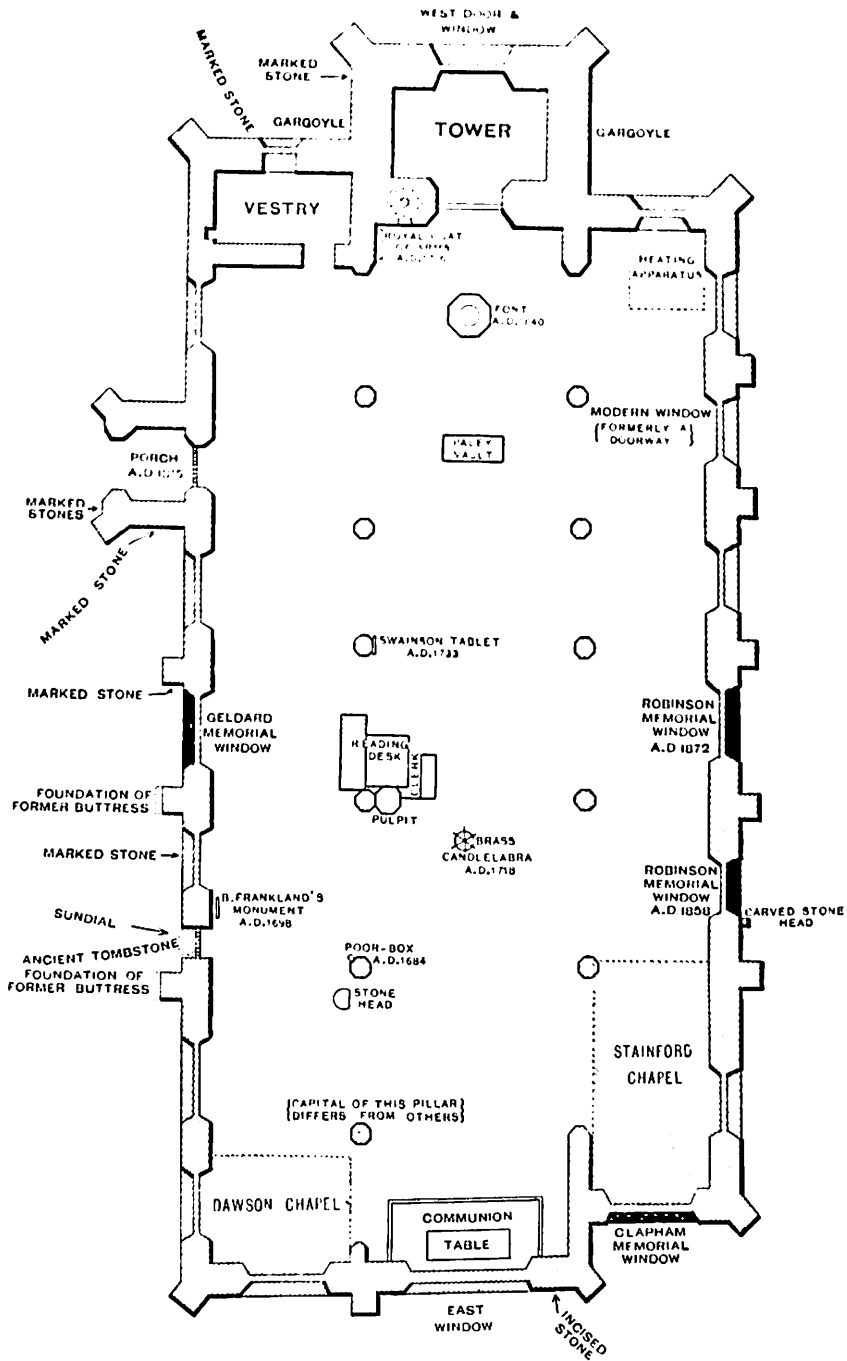

Ground Plan of Giggleswick Church before Restoration.

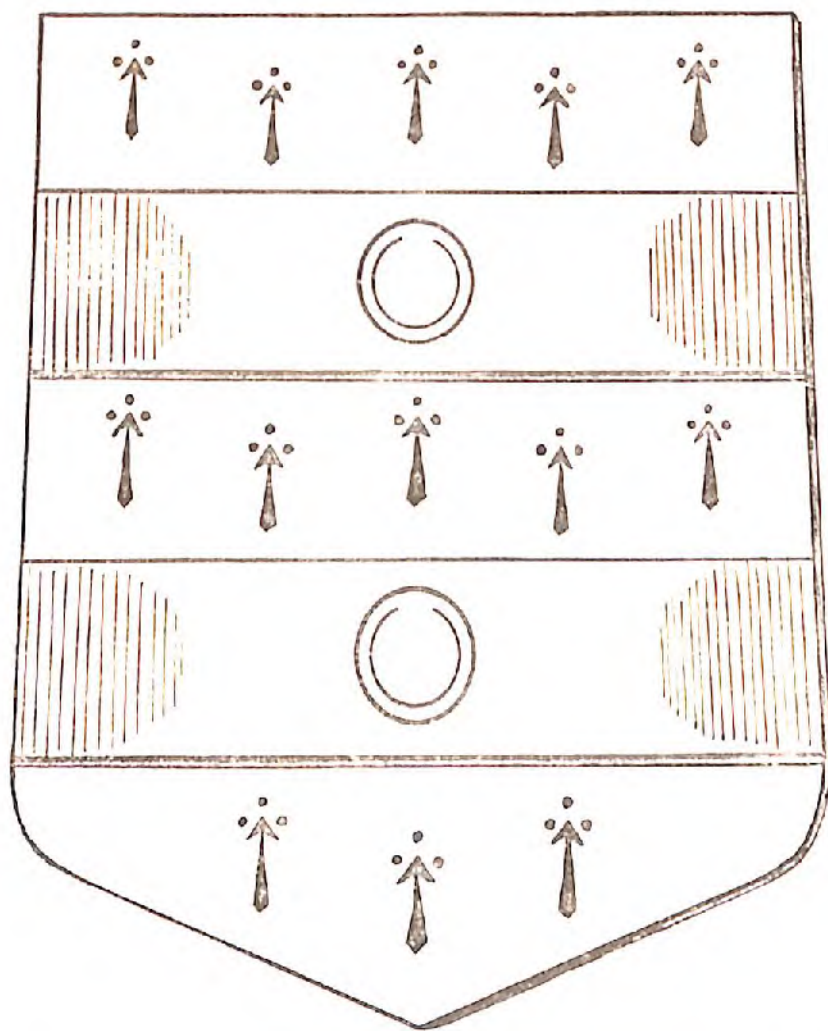

Coat of Arms formerly in a window of
Giggleswick Church (from a sketch in
British Museum.)

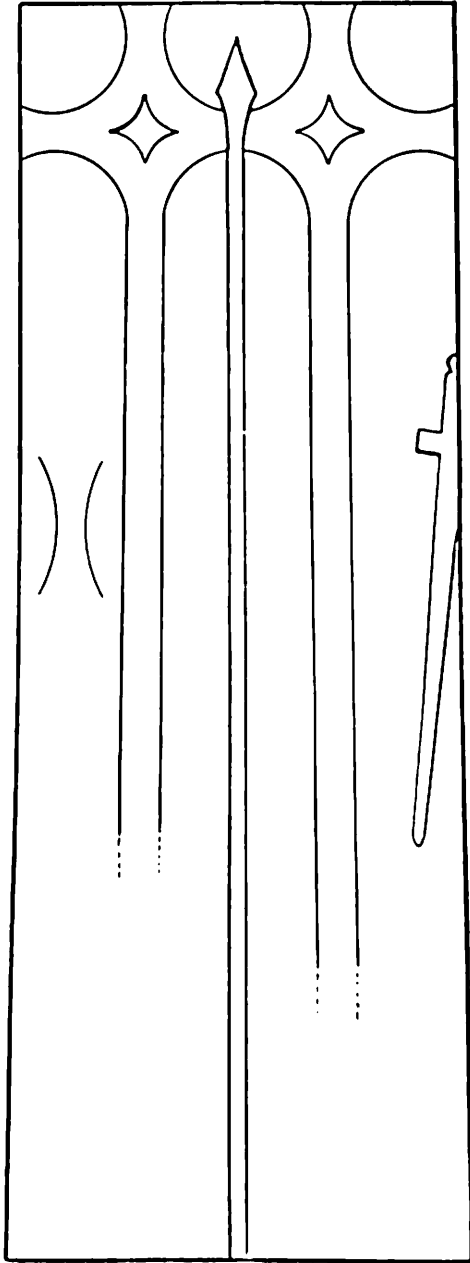

Old Tombstone at Giggleswick (from Sketch
made A.D. 1844.)

SETTLE RURAL DISTRICT COUNCIL.

ELECTION 23rd MARCH, 1901.

To the Parochial Electors of the Township of SETTLE.

LADIES AND GENTLEMEN,

The period of three years for which you elected me as one of your representatives on the District Council has nearly expired, and I have again the honour of offering myself as a Candidate and asking for a further expression of your confidence.

The publicity given to the proceedings of the Council in the local papers makes it needless to enumerate all the measures which have had my support, though I may lay claim to having honestly endeavoured to further the interests of the town and neighbourhood in my position as one of your representatives.

Out-door relief has for some years been a notable feature in this Union, and is without doubt in many cases the best form of help that can be given, but when we look at the total annual amount disbursed, it becomes a matter requiring considerable discrimination in its distribution. The average yearly expenditure for the past three years is as follows:—

	£	s.	d.
Northern Section	516	13	0
Southern Section	404	13	0
Total for the Union per annum	£921	6	0

This is a decrease of £49 per annum compared with the previous three years, and is so far satisfactory, as it indicates more prosperity, better wages, and greater thrift.

During the next three years the matters of the greatest importance affecting this township will be the re-laying of a portion of the sewers, the purchase of land for new outlet works, and the securing of a good and sufficient water supply. Your representatives have held many meetings in connection with the scheme for new sewers, and the plans and drawings are now complete, waiting for the sanction of the Local Government Board, who intimate this will be granted on the completion of the purchase of land for new outfall works. The securing of a water supply is a slow and tedious business, but two separate springs have now been inspected by your representatives and the Engineer, and the report of the latter will very shortly be received. As the above schemes will cost several thousands of pounds, it is of great importance you should send those to represent you whom you con-

sider qualified to have the oversight of the work. There is an old adage "Never swop horses when crossing a stream," and it may well apply at this particular juncture. There are many questions of minor importance, but which are insignificant compared with the schemes above-mentioned.

I am strongly in favour of the roads being maintained in an efficient state, and my support has been given to all measures having this end in view; and having been appointed one of a Committee to inspect the roads throughout the Union (in the company of the Surveyor), it is hoped considerable improvement may result from the report which will shortly be presented to the Council.

Insinuations having been rather freely made in certain quarters respecting the letting of contracts for the supply of goods to the Workhouse, I append a list of the firms which have supplied for the last three years, and, without comment, allow the facts to speak for themselves.

1898. DRAPERY.
Jan. Graham & Sons, Langcliffe
May Jackman, Long Preston
July Kayley, Hellifield
Oct. Procter, Bentham

1899.
Jan. J. Moore, Settle
Feb. J. Tatham & Sons, Settle
Mar. Leach, Ingleton
Oct. Miss Jenkinson, Giggleswick

1900.
Mar. John Hirst & Sons, Skipton (by contract)
Sept. Do. do. "

1901.
Mar. J. Tatham & Sons, Settle "

1898. GROCERIES.
Mar. Graham Bros., Langcliffe
Sept. Greenwood & Whitehead, Lancaster
1899.
Mar. Graham Bros., Langcliffe, and J. Hoar,
 Hellifield
Sept. Graham Bros., Langcliffe
1900.
Mar. John Hoar, Hellifield
Sept. Do. do.
1901.
Mar. Do. do.

The Flour and Oatmeal by Delves & Son, J. Brown & Son, John Hoar, and T. Clark & Sons.

The Drapery was not let by contract until 1900, but was altered owing to an order for about £40 worth of goods having been given to a Clapham firm, when it was decided that in future all Drapery be contracted for in the same way as the Groceries.

I now ask, if you consider I have discharged my duties faithfully, you will again place me in the honoured position of one of your representatives on the Rural District Council, and, should you so favour me, I will endeavour to the best of my ability to make myself worthy of your trust.

The Poll will take place at the NATIONAL SCHOOL, SETTLE, on SATURDAY, the 23rd of MARCH, 1901, from 8 a.m. to 8 p.m., when I hope to be again favoured with your vote.

Your obedient Servant,

THOS. HARGER.

SETTLE RURAL DISTRICT COUNCIL.

ELECTION, MARCH 23rd, 1901.

To the Parochial Electors of the Township of Settle.

LADIES AND GENTLEMEN,

During the seventeen years I have had the honour of representing you on the Settle Board of Guardians and Rural District Council (formerly the Rural Sanitary Authority), I have so frequently laid my views before you in my election addresses and at public meetings, that I feel there is but little need for me to repeat them.

Briefly speaking however my programme is:—

(1) **Out-door relief as opposed to in-door.**—I consider it better and cheaper to give persons, who are temporarily unable to maintain themselves, sufficient relief to pull themselves round, rather than force them into the "House" and so break up their homes and in many cases throw them permanently on to the rates.

(2) **Board out all pauper children.**—I hold a strong opinion that no child should be brought up in the "House" if it can possibly be avoided. The taint of pauperism thereby acquired is most difficult to shake-off in after years.

(3) **Improve the lot of the inmates of the "House."**—This a matter to which I have devoted more attention than any other. I would like the "House" to be a *home* for the aged and infirm. Keep out the loafers, and let any able-bodied inmates be well occupied. But as many of our fellow-creatures have to seek refuge there in their declining years, let such be treated (unless they become inmates through their own fault,) with all humanity. By paying weekly visits to the "House," by adding to the little comforts of the aged and the children (in which work I have been kindly assisted by several of my friends), and in other ways, I have endeavoured to faithfully perform my duties as a "Guardian of the Poor," and I only trust that if you see fit to elect some other candidate in my place you will choose one who will carry-on this work on the same lines. The result of my labours in this branch has been that the members of the Board are always good enough to attach a considerable amount of weight to any suggestions I may make connected with the "House."

(4) **Improved Water-supply.**—Many complaints have been made both as to the quality and quantity of the present supply, and the "Local Committee" have given great attention to the matter. A scheme is now being prepared whereby the present supply may be augmented, and the water rendered softer in quality.

(5) **Improved Sewerage.**—This matter also has involved great attention. The work will be extensive and necessarily costly, and will require careful supervision to ensure a satisfactory result at as moderate a cost as possible. I venture to suggest that the considerable amount of trouble I have taken in the new water and sewerage schemes, and my familiarity with their details, is a weighty reason why I should remain a member of the Council.

(6) **Improved Roads.**—Of late the condition of the roads in this Union cannot be described as satisfactory, and steps must be taken to see in what direction improvements can be effected. I have my own views on the matter, both as regards the construction and the management of the roads, but as the whole subject is now being considered by a committee I do not want to pre-judge the case until they have made their Report and Suggestions.

There are many other minor points which I should like to mention, but as I have never hesitated to speak my mind, and as full reports of the meetings are published in the Local papers, you are already pretty familiar with my opinions.

I flatter myself I have represented you well in the Council-chamber. When the interests of Settle have been concerned I have been always ready to "take a hand" in the fight, and my record of 72 attendances, out of the 76 meetings held in the last three years, shows that I have done my duty in that line. And it has been a pleasure to me to always support any representations that the Parish Council of Settle have sent to the District Council, though I fear in these matters we have not always got what we wanted.

From the financial point of view I am in favour of economy so far as is compatible with efficiency, and I have always tried to act fairly, in poor-law matters, between the rate-payers on the one hand and the poor on the other; whilst in District Council matters my interests as a property-owner in Settle and the adjacent Townships, naturally cause me to keep a sharp look-out as regards expenditure, at the same time recognizing the fact that Settle must keep pace with the sanitary requirements of the times.

One little matter I trust I may be pardoned for introducing, viz:—the question of the allowance of beer to the workhouse officials, which was the subject of a little good-humoured "heckling" at the last Parish Meeting, and on which there has been some misunderstanding. Ever since I became a member of the Board of Guardians the officials in question have been allowed a moderate quantity of beer,—the total cost of which for the whole staff has of late averaged about five pounds a year, spread over all the thirty townships of the Union, the annual rateable value of which is £143,000! I cordially supported a proposition that the officials should receive some allowance in place of this beer, but we were defeated. Another proposition was made that the beer should be discontinued (except when ordered by the Medical Officer). This I opposed. I do not regard it as a Temperance question (altho' it so happens that I do not drink beer myself), or from a merely financial point of view, but I look at it purely in the light of a contract

between master and servant, and I contend that if you deprive any members of your staff of any privileges they have enjoyed for so many years without any complaint, you are bound in honour and fairness to give them reasonable recompense. In the case of any New official appointed in the future the question can very fairly be taken into account, but I will not support what I consider to be a breach of contract in the case of an old servant, unless compensation is made them in some form or other.

LADIES AND GENTLEMEN,

I again ask for a renewal of that confidence you have placed in me so long, and that I may thus be permitted to complete the period of Twenty years in your service. My record is before you, and you know, in this and in other matters, how great is my interest in the old town of Settle. I do not expect to please you all in everything, and I am not so foolish as to try. I do not ask for your support either on political or sectarian grounds, for such questions should not enter into a contest of the present description. But I do claim that I have honestly tried to do my best for you in the past, and if you again honour me by returning me as one of your representatives I shall continue to use my best efforts on your behalf in the future. And I can fearlessly assert that in no single instance has my line of action been influenced by any consideration of personal or pecuniary advantage.

The Election will be held in the National School, Settle, on Saturday, the 23rd March, 1901, from 8-0 a.m. to 8-0 p.m. Voting is by ballot, and you can give one, two, or three votes, **but you cannot give more than one vote to one candidate.** May I ask that one of your votes may be recorded for

Your obedient Servant,

THOS. BRAYSHAW.

Settle, March 18th, 1901.



SKIPTON DIVISION.

PARLIAMENTARY ELECTION, 1900.

SKIPTON, OCTOBER, 1900.

SIR,

I have the honour to inform you that the **POLL** will take place on **FRIDAY NEXT**, the 12th inst., between Eight in the Morning and Eight in the Evening.

Enclosed is a Poll Card showing your number, description on the Register, and Polling Place.

I beg to solicit your vote and interest, and respectfully urge you to put a **X** opposite my name on the Ballot Paper which will be given you in the Polling Station.

If any other mark than a **X** opposite the name of the Candidate for whom you intend to vote be made upon the Ballot Paper, your vote will be lost. On the back of the Poll Card accompanying you will find a Form of Ballot Paper marked as an elector should mark it if he desire to vote for me.

You are earnestly requested to vote early on **FRIDAY NEXT**.

I am, Sir,

Yours faithfully,

FREDERICK WHITLEY THOMSON.

*Central Liberal Committee Rooms,
Temperance Hall, Skipton.*

Coronation Festivities at Settle.

E. R.



A. R.

HECTOR CHRISTIE, Esq., J.P., C.C.—*Chairman of the Committee.*

C. A. L. SWALE, Esq., J.P. and THOMAS HARGER, Esq.—*Vice-Chairmen.*

J. W. SHEPHERD, Esq.—*Treasurer.*

At a Parish Meeting recently held in Settle it was decided that the inhabitants should commemorate the auspicious event of the Coronation by holding a Festival on Thursday, the 26th June, 1902.

A Committee was accordingly appointed, which included the Settle District Councillors, representatives of the Parish Meeting, the Tradesmen's Association, and the Parish Council. This Committee, having enlarged its numbers and given the matter its best consideration, has accordingly decided to have (1) a Procession, (2) Sports for Children and Adults, (3) Cycle Parade, and (4) Presentation of Medals to Children. Other items will be added as funds permit, but it is obviously impossible to finally settle details until an approximate idea is formed as to the financial support likely to be received.

The foregoing suggestions refer merely to the Festivities on the appointed day, but if sufficient support is promised to establish a permanent memorial of the happy event, the Committee recommend that a small Museum—to which a Library, Reading Room, &c., could be gradually added—would be most suitable. This plan would have the advantage that it might be commenced on a very modest scale, and be improved and added to in the course of time as funds permitted.

The venerable Market Town of Settle, which for more than 650 years has been in the enjoyment of a Charter, has ever been to the fore in works of philanthropy and utility, and in demonstrations of loyalty, and it is to be hoped that it will on this occasion fully maintain its ancient reputation. Every one is therefore invited to contribute to the fund which is being raised for the above purposes, and as the Committee wish to form an early estimate as to what amount will be at their disposal, it is hoped that a speedy and favourable response will be made to this appeal.

Subscriptions may be paid to Mr. J. W. Shepherd (Treasurer), Messrs. Geo. K. Charlesworth, J. E. Hindle, E. R. Morphet, and T. Dickinson (Finance Committee), or to other accredited collectors.

THOMAS BRAYSHAW
WILSON HEWITT } *Hon. Secs.*

MAY 1ST, 1902.

GOD SAVE THE KING!
GOD BLESS THE QUEEN!!

[The Committee trust that one or both of these forms may be forwarded at an early date either to the Treasurer or to some member of the Finance Committee].

E. R. CORONATION. A. R.

I will subscribe the sum of £ : : towards the Settle Festivities in celebration of the Coronation, 26th June, 1902.

Name

Address

E. R. CORONATION. A. R.

In the event of a Permanent Memorial being founded at Settle—whether in the form of a Museum or otherwise—in commemoration of the Coronation of Their Majesties King Edward VII and Queen Alexandra, I will contribute the sum of £ : : towards such permanent memorial.

Name

Address

4-30 o'clock. Tea will be provided at the National Schools for all Children under the age of 15 years resident in the Township of Settle.

Commemoration Medals and Tickets for the Tea may be obtained for all Children under 15, free of charge, from Mr. Wilson Hewitt, at the National Schools, on Saturday, the 19th inst., from 1-0 p.m. to 5-0 p.m.

6-0 o'clock. Sports for Adults will be held in the Cricket Field. For List of Prizes see the Schedules already published.

9-0 o'clock. Fancy Dress Cycle Parade.

The Procession will assemble at Halsteads not later than 8-45, when a ballot will be taken for places and the procession will start at 9-0 o'clock prompt.

All Lamps must be lighted at the time the procession starts.

The route will be the same as that taken by the general procession and the Cyclists will finally disperse in the Market Place.

The following Prizes will be given:—

For the greatest Novelty in Dress—1st Prize	12/6
2nd	7/6
For the Neatest Dress—Gentleman...	10/-
Lady	10/-
For the best Decorated Machine—Gentleman	10/-
Lady	10/-

Messrs. E. Handby and J. W. Dugdale will officiate as Judges.

Cyclists are requested to ride five yards apart.

10-0 o'clock. There will be a display of Rockets, &c., from Castleberg.

It is hoped that the Inhabitants of Settle will decorate the exterior of their Houses, and the Streets generally, as much as possible.

Stalls will be admitted to the Cricket Field free, subject to the control of the Committee.

Further particulars may be had on application to

Thos. BRAYSHAW, }
J. W. SHEPHERD, } Secretaries.

“God save the Queen.”

SETTLE CHURCH.

—*—
→* JULY 19th, 1902. *←
—*—

Hymn 350.

THE voice that breathed o'er Eden,
That earliest wedding day,
The primal marriage blessing,
It hath not pass'd away :

Still in the pure espousal
Of Christian man and maid
The Holy THREE are with us,
The threefold grace is said,

For dower of blessèd children,
For love and faith's sweet sake,
For high mysterious union
Which nought on earth may break.

Be present, awful FATHER,
To give away this bride,
As Eve Thou gav'st to Adam
Out of his own pierced side ;

Be present, SON of Mary,
To join their loving hands,
As Thou didst bind two natures
In Thine Eternal bands ;

Be present, Holiest SPIRIT,
To bless them as they kneel,
As Thou for CHRIST, the Bridegroom,
The heavenly spouse dost seal.

O spread Thy pure wing o'er them,
Let no ill power find place,
When onward to Thine Altar
The hallow'd path they trace,

To cast their crowns before Thee
In perfect sacrifice,
Till to the home of gladness
With CHRIST's own Bride they rise.

Amen.

Mr. & Mrs. Thomas Bryestum
request the Company of

at the Marriage of their daughter

Mabel

with

J. Murray Crofts, M.A., B.Sc.,
at the Church of the Holy Ascension, Settle,
on Saturday, July 19th, 1902,
at 2-30 p.m.

"At Home" at the Ashfield Hotel,
at 3-0 p.m.

Pen-y-ghent View,
Settle.

R. S. V. P.



Ashfield Hotel
Mabel Medd



continued for many,
where Grabel and Murray
spent their honeymoon

JULY 26th, 1902.

MARRIAGE OF MISS BRAYSHAW.

A great amount of interest centred in the marriage, on Saturday afternoon, of Mr. James Murray Crofts, M.A., B.Sc. (Lond.) to Miss Mabel Brayshaw, elder daughter of Mr. Thomas Brayshaw, solicitor, of Settle. Both are well known and highly esteemed throughout a wide district. The bride belongs to a family which has been prominently associated with Settle for many years, her father at the present time being Chairman of the Board of Guardians, Clerk to the Governors of Giggleswick School, and discharging other important offices of trust; whilst the bridegroom was formerly a very popular master of Giggleswick School. The ceremony took place in Holy Ascension Church, the interior of which has been lavishly adorned with flowers and plants by a number of ladies under the direction of Mr. Crofton and Mrs. Musgrove. There was a very large attendance; indeed the space not reserved for invited guests was speedily filled to overflowing, and it was found necessary to lock the doors of the Church some time before the hour fixed for the ceremony in order to prevent overcrowding. The bride, who was given away by her father, looked very charming in a gown of ivory duchesse satin, trimmed with chiffon and duchesse point lace (the lace being the gift of her aunt, Mrs. Thorp), with veil and orange blossoms. She carried a bouquet of choice white flowers, and wore a diamond and sapphire bracelet, both the gifts of the bridegroom. She was attended by two bridesmaids: Miss Edith A. Brayshaw (her sister) and Miss May Crofts (sister of the bridegroom). They wore pretty pink and white costumes, the dresses being of white Japanese silk and lace, with shrimp pink velvet belts; and hats trimmed with pink flowers. Each carried a parasol tied with carnations, the gift of the bridegroom. The best man was Mr. Douglas Crofts, of London (brother of the groom); and the officiating clergymen were the Rev. J. G. Style, M.A., Headmaster of Giggleswick Grammar School, assisted by the Rev. C. S. Forsyth, curate-in-charge of Holy Ascension Church. The service was choral, the hymn, "The voice that breath'd o'er Eden," being sung as the bride entered the Church. Miss Watts, daughter of Dr. Watts, science master at Giggleswick School, officiated at the organ, and played a selection of appropriate music preparatory to the ceremony, and as the wedding party left the Church the well-known March by Mendelssohn. There was a large gathering outside the Church, and as the party made their way to the carriages they were plentifully battered with flowers and showers of confetti. Subsequently a reception was held at the Ashfield Hotel, the hall, staircase, and principal guest-rooms of which were profusely decorated with flowers sent in by friends of the bride and bridegroom. The guests were very numerous. The happy pair left Settle by the 4.15 p.m. train for the Lake District where the honeymoon is being spent. The bride's travelling dress was of a lovely pale-green with coat to match, and black picture hat. The following is a list of the presents, most of the contributors of which were present at the reception:—

- Bridegroom to bride, diamond and sapphire bracelet bulldog.
- Bride to bridegroom, bookcase.
- Father and mother of Bride, cheque, antique tea service, &c.
- Father and mother of Bridegroom, cheque, drawing-room overmantel, cosy corner.
- Dr. Almond, silver tea service.
- Dr. and Mrs. Atkinson, picture.
- Mr. Raymond Atkinson, overmantel.
- Miss E. A. Brayshaw, sauce-boat, silver salts.
- Master T. Brayshaw, vase, silver.
- Mrs. Brayshaw, cheque, pearl brooch, old china, embroidered cloth, &c.
- Mr. J. L. Brayshaw, silver tea pot, screen.
- Mr. and Mrs. D. H. Brayshaw, canteen of plate and cutlery.
- Mr. Hamilton Baly, ormolu travelling clock.
- Mr. and Mr. and Mrs. J. H. Batten, silver muffineers.
- Mrs. Bazett, China bowl.
- Mr. and Mrs. Beale, marmalade jar.
- Miss Benson, jewelled hat pin.
- Mrs. Birkbeck, Indian table and brass vase.
- Miss Inez Birkbeck, "Zephyr" fan.
- Mr. and Mrs. Bone, Worcester china vase.
- Miss M. Bradley, piping syringe.
- Mr. and Mrs. Brame, silver serviette rings.
- Mrs. Brown, silver muffineers.
- Mr. and Mrs. Buck, silver butter dish.
- Miss May Crofts, revolving breakfast dish, painted cushion.
- Mr. Douglas Crofts, framed engraving s.
- Miss Crofts, cheque, silver tea spoons and tongs.
- Mr. and Mrs. Septimus Crofts, silver tea spoons.
- Mr. and Mrs. Samuel Crofts, salad bowl and servers.
- Mrs. H. and Miss F. Crofts, table gong.
- Mr. Wm. Crofts, silver tea spoons.
- Mr. and Mrs. A. Crofts, eiderdown quilt.
- Mr. Calton, coalport vase.
- Mrs. Caton, antique glass and china.
- Mr. and Mrs. Charlesworth, silver belt buckle.
- Mr. Christie, cheque.
- Miss Christie, parasol.
- Mrs. Conway, silver butter knife.
- Mr. and Mrs. Cornock, bronze centre piece.
- Mr. and Mrs. Howard Cox, two princess lamps.
- Rev. J. E. and Mrs. Crabtree, sugar sifter.
- Rev. A. and Mrs. Crofton, silver photo-frame.
- Miss Dalby, lace handkerchief.
- Mr. and Mrs. Dancey, afternoon tea table.
- Miss Davidson, silver-mounted vases.
- Mr. Dean, sandwich case.
- Mr. and Mrs. Denniston, table centre.
- Mrs. Edgar, gold brooch.
- Mr. and Mrs. Embrey, smoker's companion.
- Rev. R. G. and Misses Garnett, antique Sheraton chair.
- Mrs. Geldard, telegram-form case.
- Miss Geldard, flower vase.
- Mrs. Glanville, silver and glass toilet jar.
- Mr. and Miss Golland, silver serviette rings.
- Mr. and Mrs. Gregory, rose bowl.
- Mr. and Mrs. Girling, mustard pot.
- Mrs. Hall (Ingfield), silver clock.
- Mrs. Hall (Kirkby Malham), sidoboard cloth.
- Mrs. Harrison, flower basket.
- Misses Ida and Fannie Hartley, silver photo-frames.
- Mrs. and Miss Henley, case of nut-crackers.
- Mr. and Mrs. Houston, Aneroid in silver frame.
- Mrs. Hudson and Miss Butler, silver tea spoons.
- Mr. Hyslop, silver bon-bon dishes.
- Mr. and Mrs. In Thurn, silver sugar basin and sifter.
- Mr. Ingram, case of carvers and cutlery.
- Mr. and Mrs. Jackson, silver photo frame.
- Miss Jarry, gold brooch.
- Mr. Knowles (Kirkby Malham), cheque.

- Miss Knowles (Kirkby Malham), pictures.
 Dr. and Mrs. T. Knowles, old oak chair.
 Mr. and Mrs. M. R. Knowles, silver fruit spoons.
 Mr. W. Knowles (Lisbon), picture, toast rack.
 Mrs. J. Knowles (Lisbon), silver mustard pot,
 picture.
 Mr. Richard Knowles, cheque, tea tray.
 Mr. George Knowles, biscuit box, jam dish.
 Mr. Fred Knowles, Venetian glass.
 Miss and Miss Ellen Knowles, China vases and
 plate.
 Mr. T. Foster Knowles, oblique.
 Miss Larner, George Eliot's works.
 Mrs. Latimer, shoes.
 Mr. Lloyd, flask.
 Mrs. Loat, "Duchess" d'oyleys.
 Mr. and Mrs. Lucas, table centre and shawl.
 Masters at Giggleswick School, silver candlesticks.
 Masters at Sir Thos. Rich's School, case of pipes.
 Miss Mabey, table centre.
 Mr. and Mrs. Marsden, entree dish.
 Mr. and Mrs. Morgan Matthews, oak newspaper
 rack.
 Mr. and Mrs. Mills, cake basket and knife.
 Rev. J. J. and Mrs. Milne, Indian table.
 Miss Milne, flower pot.
 Mr. and Mrs. Moffatt, Worcester china vases.
 Dr. and Mrs. Morell, silver butter dish and knife.
 Mr. and Mrs. Musgrave, two silver photo frames.
 Mr. and Mrs. Jos. Parker, copper kettle.
 Mrs. Preston (Mearbeck), silver sauce boat.
 Miss Preston, silver bon-bon dishes.
 Misses Preston (Langcliffe), silver soup ladle.
 Mrs. Phillips, oxidised fern vases.
 Miss Picard (Stainforth), case of silver buttons.
 Miss Priestley, silver tea spoons.
 Mrs. and the Misses Pottinger, Japanese fire
 screen.
 Mr. and Miss Radcliffe, silver sugar tongs and
 sifter.
 Mr. and Mrs. J. Redmayne, pair of vases.
 Mr. and Mrs. J. G. Robinson, silver mustard pot.
 Rev. W. Shepherd, two silver vases.
 Misses Shepherd, pearl brooch.
 Dr. and Mrs. H. B. Shepherd, chair.
 Miss Shepherd, picture.
 Mrs. Simpson, afternoon tea table cloth.
 Miss Simpson, bread platter and knife.
 Mr. and Mrs. Slinger, cheque.
 Miss Slinger, silver muffineers, hat rack.
 Miss Ealie Slinger, silver-mounted scent bottle.
 Mrs. Smith, cushion.
 Mrs. Stackhouse (Ingfield), silver sugar basin and
 cream jug.
 Mrs. Stackhouse (Taitlands), fish knives and
 forks.
 Miss Stackhouse (Taitlands), carved table.
 Miss Stansfeld, case of silver salts.
 Mr. and Mrs. Stevenson, candlesticks.
 Rev. G. and Mrs. Style, silver fern pot.
 Mr. C. A. L. Swale, fish servers.
 Mr. W. D. Stone, case of silver salts.
 Mr. and Mrs. Tamblyh-Watts, photo frame.
 Mr. and Mrs. Taylor, cushion.
 Miss M. Taylor, picture.
 Mr. R. Taylor, butter dish.
 Mr. and Mrs. Thorp, cheque, dinner service.
 Mildred and Edgar Thorp, pearl bracelet.
 Dr. Timmins, case of carvers.
 Miss Tristram, vegetable dish.
 Mr. Tutton, F.R.S., pictures.
 Mr. and Mrs. Vant, fern vase.
 Mr. H. Vick, hot water jug.
 Dr., Mrs., and Miss Watts, blotter and stationery
 case.
 Mr. Frank Watts, silver-mounted toilet jar.
 Mr. and Mrs. J. Waugh, two Bartolozzi en-
 gravings.
 Miss Waugh, silver toilet box.
 Mr. Courtney Wells brackets.
 Mr. Fred White, silver toast rack.
 Mrs. Wilcock, old China.

The Pioneer.

"True to the kindred points of Heaven and Home."

FRIDAY, JULY 25, 1902.

MARRIAGE OF MISS M. BRAYSHAW, OF SETTLE.

A crowded congregation assembled at the Church of the Holy Ascension, Settle, on Saturday afternoon, to witness the marriage of Mr James Murray Crofts, M.A. (Camb.), B.Sc. (London), eldest son of Mr James Crofts, head master of Sir Thomas Rich's School at Gloucester, to Miss Mabel Brayshaw, eldest daughter of Mr Thomas Brayshaw, of Settle. The fact that the bride's family has been established so long in this locality, and that they are so well known, and the bridegroom's previous connection with Giggleswick School, created widespread interest in the ceremony, and when it became necessary to close the church doors there were still some hundreds unable to find admission to the sacred edifice, whilst the long lines of carriages testified to the large number of personal friends who had come to show their goodwill to the happy pair. A considerable number of masters and others connected with Giggleswick School also put in an appearance out of compliment to the bridegroom, who was formerly one of their most popular colleagues. Whilst the congregation were assembling a selection of sacred voluntaries was played by Miss Watts, who officiated as organist. The bridegroom was attended by his brother, Mr Douglas Crofts, as best man. They were closely followed by Rev G Stile, M.A., head master of Giggleswick School, who took the principal part of the service, and Rev C S Forsyth, who assisted him. Soon after the clergy had reached the chancel, the opening bars of the beautiful hymn "The voice that breathed o'er Eden" announced the approach of the bride, who was accompanied by her father, by whom she was given away. The bride was dressed in an ivory duchesse satin costume, trimmed with chiffon and duchesse point lace, the latter being the gift of her aunt, Mrs Thorp. She wore a veil and orange blossom wreath, and she carried a bouquet of choice white flowers, the gift of the bridegroom. Amongst her ornaments was a diamond and sapphire bracelet, also the gift of the bridegroom. The bride was attended by her sister, Miss Edith A Brayshaw, and by Miss May Crofts, sister of the bridegroom, who wore white Japanese silk and lace robes, with shrimp-pink velvet belts, hats adorned with pink flowers, and pink carnations adorned the parasols, which had been presented to them as mementoes of the occasion by the bridegroom. The ceremony was impressively rendered by the clergy, and as the chancel and screen had been tastefully decorated with flowers by Mrs Crofton, Mrs Musgrave, and other friends, the whole effect, coupled with the gaily dressed assembly, was charming. The service having concluded, and the register having been signed, a merry peal of bells announced the exit of the newly-wedded pair, who, on their departure from the church were greeted with showers of confetti, whilst children strewed their path with flowers. The whole of the wedding party then adjourned to the Ashfield Hotel, where Mrs Brayshaw was "at home" to a large company, and where the numerous and valuable presents which had been given to the young couple were on view. Many well-wishers had sent lavish contributions of superb flowers, which had been tastefully arranged under the supervision of Mr Dugdale, and which converted the Hotel into a veritable floral arbour, whilst the members of the Bowling Club had courteously placed their green at the disposal of the wedding party. After a short interval, during which a sheaf of congratulatory telegrams was received from absent friends and relatives, the bride donned a travelling costume of pale green coat and skirt, and black picture hat, and Mr and Mrs Crofts then departed for their honeymoon, which is to be spent amongst the English lakes. Regret was felt that, owing to illness, the father of the bridegroom was unable to be present. The following is a

LIST OF PRESENTS.

Bridegroom to bride, diamond and sapphire bracelet, bulldog; bride to bridegroom, book case; father and mother of bride, cheque, antique tea service, etc; father and mother of bridegroom, cheque, drawing-room overmantel, cosy-corner, etc; Dr Almond, silver tea service; Dr and Mrs Atkinson, picture; Mr Raymond Atkinson, overmantel; Miss E A Brayshaw, sauce boat, silver salts; Master T Brayshaw, vase, silver; Mrs Brayshaw, cheque, pearl brooch, old china, embroidered cloth, etc; Mr J Lund Brayshaw, silver teapot, service.

and cutlery; Mr Hamilton Bady, ornolu travelling clock; Mr and Mr and Mrs J H Bateau, silver muffineers; Mrs Bazett, china bowl; Mr and Mrs Beale, marmalade jar; Miss Benson, jewelled hat pin; Mrs Birbeck, Indian table and brass vase; Miss Inez Birkbeck, zephyr fan; Mr and Mrs Boone, Worcester china vase; Miss M Bradley, piping syringe; Mr and Mrs Brame, silver serviette rings; Mrs Brown, silver muffineers; Dr and Mrs Buck, silver butter dish; Miss May Crofts, revolving breakfast dish, painted cushion; Mr Douglas Crofts, framed engraving; Miss Crofts, cheque, silver tea spoons and tongs; Mr and Mrs Septimus Crofts, silver tea spoons; Mr and Mrs Samuel Crofts, salad bowl and servers; Mrs H and Miss F Crofts, table gong; Mr W Crofts, silver tea spoons; Mr and Mrs A Crofts, eider-down quilt; Mr Calton, coalport vase; Mrs Caton, antique glass and china; Mr and Mrs G K Charlesworth, silver belt buckle; Mr Christie, cheque; Miss Christie, parasol; Mrs Conway, silver butter knife; Mr and Mrs Cornock, bronze centre piece; Mr and Mrs Howard Cox, two Princess lamps; Rev J E and Mrs Crabtree, silver sugar sifter; Rev A and Mrs Crofton, silver photo frame; Miss Dalby, lace handkerchief; Mr and Mrs Dancey, afternoon tea table; Miss Davidson, silver-mounted vases; Mr Dean, sandwich case; Mr and Mrs Denniston, table centre; Mrs Edgar, gold brooch; Mr and Mrs Embrey, smoker's companion; Rev R C and Misses Garnett, antique Sheraton chair; Mrs Geldard, telegram form case; Miss Geldard, flower vase; Mrs Glanville, silver and glass toilet jar; Mrs and Miss Golland, silver serviette rings; Mr and Mrs Gregory, rose bowl; Mr and Mrs Girling, mustard pot; Mrs Hall (Ingfield) silver clock; Mrs Hall (Kirkby Malham), sideboard cloth; Mrs Harrison, flower basket; Misses Ida and Tavie Hartley, silver photo frame; Mrs and Miss Henley, case of nut crackers; Dr and Mrs Houston, aneroid in silver frame; Mrs Hudson and Miss Butler, silver tea spoons; Dr Hyslop, silver bon-bon dishes; Mr and Mrs Im Thurn, silver sugar basin and sifter; Mr Ingham, case of carvers and cutlery; Mr and Mrs Jackson, silver photo frame; Miss Jarry, gold brooch; Mrs Knowles (Kirkby Malham), cheque, oak hall table; Miss Knowles (Kirby Malham), pictures; Dr and Mrs T Knowles, old oak chair; Mr and Mrs M R Knowles, silver fruit spoons; Mr W Knowles (Lisbon), picture, toast rack; Mrs J Knowles (Lisbon), silver mustard pot, picture; Mr Richard Knowles, cheque, tea tray; Mr George Knowles, biscuit box, jam dish; Mr Fred Knowles, Venetian glass; Miss and Miss Ellen Knowles, china vases and plate; Mr T Foster Knowles, cheque; Miss Larnier, George Eliot's works; Mrs Latimer, shoes; Mr Lloyd, flask; Mrs Loat, duchesse d'oyleys; Mr and Mrs Lucas, table centre and shawl; masters at Giggleswick School, silver candlesticks; masters at Sir Thomas Rich's School, case of pipes; Miss Mabey, table centre; Mr and Mrs Marsden, entree dish; Mr and Mrs Morgan Matthews, oak newspaper rack; Mr and Mrs Mills, cake basket and knife; Rev J J and Mrs Milne, Indian table; Miss Milne, flower pot; Mr and Mrs Moffatt, Worcester china vases; Dr and Mrs Morell, silver butter dish and knife; Mr and Mrs Musgrave, two silver photo frames; Mr and Mrs Jos. Parker, copper kettle; Mrs Preston (Mearbeck), silver sauce boat; Miss Preston (Mearbeck), silver bon-bon dishes; Misses Preston (Langcliffe), silver soup ladle; Mrs Phillips, oxidised fern vases; Miss Picard (Stainforth), case of silver buttons; Misses Priestley, silver tea spoons; Mrs and the Misses Pottinger, Japanese fire screens; Mr and Miss Radcliffe, silver sugar tongs and sifter; Mr and Mrs J Redmayne, pair of vases; Mr and Mrs J G Robinson, silver mustard pot; Rev W Shepherd, two silver vases; Misses Shepherd, pearl brooch; Dr and Mrs H B Shepherd, chair; Miss Shepherd, picture; Mrs Simpson, afternoon tea table cloth; Miss Simpson, bread platter and knife; Mr and Mrs Slinger, cheque; Miss Slinger, silver muffineers, hat rack; Miss Ealie Slinger, silver-mounted scent bottle; Mrs Smith, cushion; Mrs Stackhouse (Ingfield), silver sugar basin and cream jug; Mrs Stackhouse (Taitlands), fish knives and forks; Miss Stackhouse (Taitlands), carved table; Miss Stansfeld, case of silver salts; Mr and Mrs Stevenson, candlesticks; Rev G and Mrs Style, silver fern pot; Mr C A L Swale, fish servers; Mr W D Stone, case of silver salts; Mr and Mrs Tamblin-Watts, photo frame; Mr and Mrs Taylor, cushion; Miss M Taylor, picture; Mr R Taylor, butter dish; Mr and Mrs Thorp, cheque, dinner service; Miss and Master Thorp, pearl bracelet; Dr Timmins, case of carvers; Miss Tristram, vegetable dish; Mr Tutton, F.R.S., pictures; Mr and Mrs Vant, fern vase; Mr H Vick, hot water jug; Dr Mrs and Miss Watts, blotter and stationary case; Mr Frank Watts, silver mounted toilet jar; Mr and Mrs J Waugh, two Bartolozzi engravings; Miss Waugh, silver toilet box; Mr Courtney Wells, brackets; Mr Fred White, silver toast rack; and Mrs Wilcock old china.

Bridgroom to Bride—Diamond and sapphire bracelet; bull-
 dog.
 Bride to Bridgroom—Oak bookcase.
 Dr Almond (Leeds)—Silver tea service.
 Dr and Mrs Atkinson—Picture.
 Mr Raymond Atkinson—Overmantel.
 Mr and Mrs Thomas Brayshaw—Cheque, tea service, house-
 hold linen, &c.
 Miss B A Brayshaw—Sauce boat and silver salts.
 Master T Brayshaw—Vase and salver.
 Mrs Brayshaw—Cheque, pearl brooch, old china, embroidered
 cloth, &c.
 Mr J L Brayshaw—Silver teapot and screen.
 Mr and Mrs D H Brayshaw—Caretton of plate and cutlery.
 Mr Hamilton Baly—Ormolu travelling clock.
 Mr, Mr and Mrs J H Batten—Silver muffineers.
 Mrs Berao—China bowl.
 Mr and Mrs Beale—Marmalade jar and spoon.
 Miss Benson—Jewelled hat pin.
 Miss Birbeck—Indian table and brass vase.
 Miss Inez Birkbeck—"Zephyr" fan.
 Mr and Mrs Boone (Cheltenham)—Worcester china vase.
 Miss M Bradley—Plating syringe.
 Mr and Mrs Braine—Silver serviette rings.
 Mrs Bywa (Gloucester)—Silver muffineers.
 Dr and Mrs Buck—Silver butter dish.
 Mr and Mrs James Crofts—Cheque, drawing-room overmantel,
 and cosy corner.
 Miss May Crofts—Revolving breakfast dish and painted
 cushion.
 Mr Douglas Crofts—Framed engraving.
 Miss Crofts (London)—Cheque, silver tea spoons and tongs in
 case.
 Mr and Mrs Septimus Crofts (London)—Silver tea spoons.
 Mr and Mrs Samuel Crofts (London)—Salad bowl and servers.
 Mrs H and Miss F Crofts (London)—Table gong.
 Mrs William Crofts—Silver tea spoons in case.
 Mr and Mrs A Crofts—Eiderdown quilt.
 Mr Caton (Gloucester)—Old Coalport vase.
 Mrs Caton—Antique glass and china.
 Mr and Mrs Charlesworth—Silver belt buckle.
 Mr Christie—Cheque.
 Miss Christie—Sunshade.
 Mr and Mrs Corman (Gloucester)—Bronze centre piece.
 Mr and Mrs Howard Cox—Two Princess lamps.
 Rev J E and Mrs Crabtree—Sugar sifter.
 Rev A and Mrs Crofton—Silver photo frame.
 Mrs Conway (Gloucester)—Silver butter knife.
 Miss Dalby—Lace handkerchief.
 Mr and Mrs Dancy (Gloucester)—Afternoon tea stand.
 Miss Davidson—Silver mounted vases.
 Mr Dean—Sandwich case.
 Mr and Mrs Denniston—Table centre.
 Mrs Edgar—Gold brooch.
 Mr and Mrs Embroy (Gloucester)—Smoker's companion.
 Rev R O and Misses Garnett—Antique Sheraton chair.
 Mrs Galdard—Telegram form case.
 Mrs Glenville—Silver and glass toilet jar.
 Mrs and Miss Golland—Silver serviette rings.
 Mr and Mrs Gregory—Rose bowl.
 Mr and Mrs Gieling—Mustard pot.
 Miss Galdard—Flower vase.
 Mrs Hall (Ingfield)—Silver clock.
 Mrs Hall (Kirkby Malham)—Sideboard cloth.
 Misses Ida and Tavia Harley—Silver photo frame.
 Mrs and Miss Healey—Case of nut crackers.
 Dr and Mrs Houston—Aneroid in silver frame.
 Mrs Hudson and Miss Butler—Silver tea spoons.
 Dr Hyslop—Silver bon-bon dishes.
 Mrs Harrison—Flower basket.
 Mr and Mrs Im Thurn—Silver sugar basin and sifter.
 Mrs Inham—Case of carvers and cutlery.
 Mr and Mrs Jackson—Silver photo frame.
 Miss Jarry—Gold brooch.
 Mrs Knowles (Kirkby Malham)—Cheque and oak table.
 Miss Knowles (Kirkby Malham)—Pictures.
 Dr and Mrs T Knowles—Old oak chair.
 Mr and Mrs M R Knowles—Silver fruit spoons.
 Mr W Knowles (Lisbon)—Picture and toast rack.
 Mrs J Knowles (Lisbon)—Silver mustard pot and picture.
 Mr Richard Knowles—Cheque and tea tray.
 Mr George Knowles—Biscuit box and jam dish.
 Mr Fred Knowles—Venetian glass.
 Miss and Miss Ellen Knowles—China vases and plate.
 Mr T Foster Knowles—Cheque.
 Miss Larner—George Eliot's Works.
 Mrs Ladimer—Shoes.
 Mr Lloyd—Flask.
 Mrs Loat (Oxford)—Duchesse d'oyleys
 Mr and Mrs Lucas—Table centre and shawl.
 Masters at Giggleswick School (8)—Silver candlesticks.
 Masters at Sir Thomas Rich's School—Case of pipes.
 Miss Mabey—Table centre.
 Mr and Mrs Marsden—Entrée dishes.
 Mr and Mrs Morgan Matthews (Gloucester)—Oak newspaper
 rack.
 Mr and Mrs Mills (London)—Cake basket and knife.
 Rev J J and Mrs Milne—Indian table.
 Miss Milne—Flower pot.
 Mr and Mrs Moffatt (Gloucester)—Worcester china vases.
 Dr and Mrs Morrell (Cambridge)—Silver butter shell and
 knife.
 Mr and Mrs Musgrave—Two silver photo frames.
 Mr and Mrs Jos. Parker—Copper kettle.
 Mrs Preston (Mearbeck)—Silver sauce boat.
 Miss Preston (Mearbeck)—Silver bon-bon dishes.
 Misses Preston (Langcliffe)—Silver soup ladle.
 Mrs Phillips—Oxidised fern vases.
 Miss Plead (Stainforth)—Case of silver buttons.
 Misses Priestley—Silver tea spoons.
 Mrs and The Misses Pottinger (Cheltenham)—Japanese fire
 screen.
 Mr and Miss Radcliffe—Silver sugar tongs and sifter.
 Mr and Mrs J Redmayne—Pair of vases.
 Mr and Mrs J G Robinson—Silver mustard pot.
 Rev W Shepherd—Two silver vases.
 Misses Shepherd—Pearl brooch.
 Dr and Mrs E B Shepherd—Chair.
 Miss Shepherd—Picture.
 Mrs A Simpson (Gloucester)—Afternoon tea table cloth.
 Miss Simpson (Bath)—Bread platter and knife.
 Mr and Mrs Slinger—Cheque.
 Miss Slinger—Silver muffineers and hat rack.
 Miss Edie Slinger—Silver-mounted scent bottle.
 Mrs Smith—Gashan.
 Mrs Stackhouse (Ingfield)—Silver sugar basin and cream jug.
 Mrs Stackhouse (Taitlands)—Fish knives and forks.
 Miss Stackhouse—Carved table.
 Miss Stanfeld—Case of silver salts.
 Mr and Mrs Stevenson—Candlesticks.
 Rev G and Mrs Syle—Silver fern pot.
 Mr C A L Swale—Fish servers.
 Mr W D Stone (Gloucester)—Case of silver salts.
 Mr and Mrs Tamblay-Watts—Photo frame.
 Mr and Mrs Taylor—Cushion.
 Miss M Taylor—Picture.
 Mr R Taylor—Butter dish.
 Mr and Mrs Thorp—Cheque, dinner service, and Duchesse
 point lace.
 Miss and Master Thorp—Pearl bracelet.
 Dr Timmins (London)—Case of carvers.
 Miss Tristram—Vegetable dish.
 Mr Tutton, F.R.S. (Oxford)—Pictures.
 Mr and Mrs Vant—Fern vase.
 Mr H Vick (Gloucester)—Hot water jug.
 Mr Frank Watts—Silver-mounted toilet bottle.
 Dr, Mrs and Miss Watts—Blotter and stationery case.
 Mr and Mrs J W Wagh—Two Bartolozzi engravings.
 Miss Waugh—Silver toilet box.
 Mr Fred White (Gloucester)—Toast rack.
 Mr Courtenay Well—(Gloucester)—Brackets.
 Mr W Wink—Old china.

GIGGLESWICK SCHOOL,

YORKSHIRE.

The Governors of Giggleswick School, Yorkshire, owing to the retirement of the Rev. George Style, are prepared to appoint a Head Master, to take office after the next Easter vacation.

He must be a Graduate of some University within the British Empire, and must be under 45 years of age.

There is a Boarding-House capable of holding 140 boys, and there are also two smaller Houses, all (except one) being under the charge of the Head Master, who will not, however, receive boys into his own house.

His emoluments, in addition to a residence, arise from a fixed stipend of £200 a year and capitation fees, which together make, at the present time, a total amount of not less than £1,000 per annum.

Further particulars may be obtained free, and copies of the Scheme for Management may be purchased for 1/- each, from

THOS. BRAYSHAW,

Solicitor,

SETTLE,

(the Clerk to the Governors), to whom Candidates must forward their applications on or before the 1st of January, 1904.

13 High Street - Skipton
9 November 1950

Dear Mabel & Edith.

Miss Hamkinson is going to be married at Xmas, & we thought it would be very nice if the old girls joined with the school in giving her a present. Miss Farmer has a list of things Miss Hamkinson wants, & a Committee has been formed of both old & present girls to choose something from it. Miss Hamkinson's new home will be at Lamberis where Mr Foster has just been appointed headmaster of the County School. Will you let us have your subscription not later than Nov 30th as there will be a great deal to arrange after the money is all collected. Cards will be sent round to say what has been done.

yours sincerely
Elsie Gummell.

Subscriptions may be sent to
Miss E. Gummell, 13 High Street, Skipton
Miss B. Rhodes, Fieldhurst, Liversedge.

SETTLE & DISTRICT
TECHNICAL INSTITUTE.

THE

REV. ADDISON CROFTON, M.A.

Has kindly consented to LECTURE in the

TECHNICAL INSTITUTE, SETTLE,

FRIDAY, FEBRUARY 22nd, 1901,

At 4-30 p.m., on

Snow, Ice,
and Glaciers,

With numerous Lantern Slides, shewn by the Oxy-Hydrogen Light.

ADMISSION: Front Seats, 6d.; Back Seats, 3d.;

DAY SCHOOL CHILDREN, 1d.

Zion Chapel, Settle.



A SHORT

MEMORIAL SERVICE

Will be conducted in the above Chapel,
by the

REV. G. H. BROWN,

ON

Saturday, Feb. 2nd, 1901,

AT 11 A.M.,

The Day of National Mourning for Her Most
Gracious Majesty Queen Victoria,

at which all members of the congregation are earnestly
requested to be present.

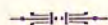

Special Hymns will be sung.



In Memoriam,

Her late Majesty,

❖ UNITED ❖

Memorial
Service

IN THE

Wesleyan Church, Settle,

ON

SATURDAY, Feb. 2nd

TO COMMENCE AT 2 O'CLOCK.

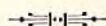

SPECIAL HYMNS and AN ANTHEM.

**WILL YOU PERMIT
THE BRITISH FLAG
TO BE TRAMPLED UPON?**



LIBERAL LITTLE ENGLANDERS :—“Go it, Gentlemen! We don't mind! Keep it up until *we* get into power, and then we'll make things pleasant for you. Always write (on the strict Q. T.) to C. . . k, L. e & Co., Ltd.”

UNIONIST DETECTIVES :—“That little game is played out. Great Britain trusted you *once* on the Transvaal question, in 1881. But she is not fool enough to repeat that blunder in 1900. Once bit, twice shy!”

VOTE FOR MORRISON

TO COMPLETE THE WORK OUR SOLDIERS HAVE DONE.

Arthur D'Arcy

Sir Arthur D'Arcy.

*Your Obedt
Henry Cumberland*

Henry, Earl of Cumberland.

—
SIGNATURES TO GIGGLESWICK CHURCH CHARTERS.

SETTLE & DISTRICT TECHNICAL INSTITUTE.

SOIRÉE LITTÉRAIRE ET ARTISTIQUE

IN THE
VICTORIA HALL, SETTLE,

ON

TUESDAY, MAY 13th, at 7-45 p.m.

PROGRAMME.

PART I.

“THE DAISY CHAIN”

By LIZA LEHMANN.

Soprano = Mrs. MUSGRAVE. Contralto = Mrs. ATKINSON.
Baritone = Mr. WALROND. Tenor = Mr. CONWAY REES.
Accompanist = Miss BENSON.

PART II.

- 1.—“Le Pendu”.....Comic Song by *Mac Nab*
M. CHARLIER.
- 2.—“Aimons”..... by *Goring Thomas*
MRS. MUSGRAVE.
- 3.—Song
MR. WALROND.
- 4.—“Samson et Delilah”.....by *Saint Saens*
MRS. ATKINSON.
- 5.—“Les Plongeurs à Cheval”
M. CHARLIER.
- 6.—“Les Perles d’or”..... by *Francis Thorne*
MRS. MUSGRAVE.
- 7.—“La Pêche à la Ligne”
M. CHARLIER.

INTERVAL.

“LES DEUX SOURDS”

COMEDY BY MOINAUX.

PERSONNAGES—

Eglantine - - - MISS BRAYSHAW
Placide - - - M. CHARLIER
Boniface - - - MR. WOOLLARD (of Keighley)

Damoiseau - - - MR. C. GRAHAM
Le Garde Champêtre - - - MR. T. MARSDEN
Le Jardinier - - - MR. D. MARSDEN

ADMISSION := Dress Circle, 2/- ; Upper Circle, 1/6 ; Body of the Hall, 1/- and 6d.

Plan of the Hall may be seen and seats secured at the Craven Stationery Company's, on and after Monday, May 5th.

DOORS OPEN AT 7-15 P.M. CARRIAGES MAY BE ORDERED FOR 10-15 P.M.

"LES DEUX SOURDS"

(THE TWO DEAF MEN).

Comedy by **JULES MOINAUX.**

PERSONNAGES :

EGLANTINE - - - - -	Miss BRAYSHAW
PLACIDE - - - - -	M. CHARLIER
BONIFACE - - - - -	MR. WOOLLARD (of Keighley)
DAMOISEAU - - - - -	MR. C. GRAHAM
LE GARDE CHAMPTÈRE - - - - -	MR. T. MARSDEN
LE JARDINIER - - - - -	MR. D. MARSDEN

M. Damoiseau (Mr. Graham), a deaf widower, lives with his daughter Eglantine (Miss Brayshaw) and his servant Boniface (Mr. Woollard). Eglantine would like to be married (SCENE I.), but her father had refused five or six suitors, none of whom was the son-in-law of his dreams. When the play opens, Damoiseau is expecting a quack who cures deafness by electro-acoustico-galvanism. Meanwhile he reads a treatise on deafness (SCENE II.), and asks Boniface to explain a few details of his auricular anatomy, which leads to much shouting (SCENE IV.).

They are interrupted by a greater noise. A sportsman has entered Damoiseau's garden, a policeman and a gardener in pursuit.

Damoiseau, armed with a gun, and Boniface with a broom-stick, join in the chase. Placide (M. Charlier) rushes into the room pursuing a rabbit, having broken various things and killed his own dog in his progress. He is caught at last, and, threatened with imprisonment, pretends to be deaf.

Damoiseau, being shouted to by Boniface that the offender is afflicted with his own infirmity, is enraptured. He has at last found the ideal son-in-law, who, being deaf, will shout to Eglantine, she will do the same, and he will thus be able to hear everything they say.

Placide is introduced to Eglantine (SCENE VIII.), but Boniface, horrified at the idea of two deaf men in the house, prays Eglantine to refuse him (SCENE X.).

But in Placide Eglantine recognises a young man whom she already secretly loves, but in the presence of Boniface he still pretends to be deaf.

Meanwhile the quack has cured Damoiseau, and when he tells this to Eglantine, she wishes Placide to be cured also. But Damoiseau will have nothing to do with the pretended deaf man.

Then follows a most comic scene, in which Placide and Damoiseau, each believing the other deaf, abuse each other in the most polite manner (SCENE XIV.).

At last the trick is discovered. Placide apologises; Damoiseau consents to have him as a son-in-law, and all ends happily.

SPECIAL FORMS
OF
SERVICE

IN COMMEMORATION OF

HER LATE MAJESTY
QUEEN VICTORIA

OF BLESSED AND GLORIOUS MEMORY

TO BE USED IN ALL

CHURCHES and CHAPELS in ENGLAND and WALES

AND IN THE

Town of BERWICK-UPON-TWEED

Either on the Day of the Funeral, or on the most
convenient Day within the Octave.

By Authority.

LONDON:

Printed by **EYRE and SPOTTISWOODE,**
Printers to the King's most Excellent Majesty.

1901.

One of these Forms of Memorial Service to be used either on the Day of the Funeral of Her late Majesty Queen Victoria or on the most convenient Day within the Octave,

Form of Memorial Service.

FORM I.

The Litany.

The Burial Service, all to be said within the Church; omitting the words said at the Committal of the Body to the grave; and substituting the words, "Our Queen, Thy Servant Victoria" for the words "this our Brother"; and inserting before "The Grace" at the conclusion the following—

Thanksgiving.

O GOD, whose Providence ruleth all things both in heaven and earth, by whom Kings reign and princes decree justice, we thank thee for all the blessings which thou hast bestowed upon us through our Queen *VICTORIA* lately taken from us. We thank thee for the wisdom of her counsels, for the care and love with which she watched over her people, for the bright example of her noble life, for the prosperity which we enjoyed during her happy reign; and we pray thee to fill our hearts with gratitude for all these benefits, and to give us grace that we may use the memory of them as a perpetual call to live according to thy will, for the good of our fellow men and the glory of thy great Name, through Jesus Christ our Lord. *Amen.*

Prayer for His Majesty the King.

ALMIGHTY GOD, who rulest over all the kingdoms of the World, and disposcest of them according to thy good pleasure; We yield thee unfeigned thanks, for that thou hast been pleased to place thy Servant our Sovereign Lord, King *EDWARD*, upon the Throne of this Realm. Let thy wisdom be his guide, and let thine arm strengthen him; let justice, truth, and holiness, let peace and love, and all those virtues that adorn the Christian Profession, flourish in his days; direct all his counsels and endeavours to thy glory, and the welfare of his people; and give us grace to obey him cheerfully and willingly for conscience' sake; that neither our sinful passions, nor our private interests, may disappoint his cares for the publick good; let him always possess the hearts of his people, that they may never be wanting in honour to his Person, and dutiful submission to his Authority; let his Reign be long and prosperous, and crown him with immortality in the life to come; through Jesus Christ our Lord. *Amen.*

Hymns may be sung before and after the Litany and on the conclusion of the Service at the discretion of the Minister. A sermon may also follow.

FORM II.

OPENING SENTENCES.

I AM the resurrection and the life, saith the Lord: he that believeth in me, though he were dead, yet shall he live: and whosoever liveth and believeth in me shall never die.

St. John xi. 25, 26.

I KNOW that my Redeemer liveth, and that he shall stand at the latter day upon the earth. And though after my skin worms destroy this body, yet in my flesh shall I see God: whom I shall see for myself, and mine eyes shall behold, and not another. *Job xix. 25, 26, 27.*

WE brought nothing into this world, and it is certain we can carry nothing out. The Lord gave, and the Lord hath taken away; blessed be the Name of the Lord. *1 Tim. vi. 7. Job i. 21.*

In the Name of the Father, and of the Son, and of the Holy Ghost.

OUR Father, which art in heaven, Hallowed be thy Name. Thy kingdom come. Thy will be done in earth, As it is in heaven. Give us this day our daily bread. And forgive us our trespasses, As we forgive them that trespass against us. And lead us not into temptation; But deliver us from evil. *Amen.*