

DATING

6) Identify the oldest part of the building and indicate a likely date

The Barn (without outshot) is built in part upon the foundations of an earlier building, and dates from the late 18C.

7) Major extensions or alterations

Lean-to outshot added late 18c to early 19C.

SETTING

8) Orientation

High barn is located on the hollow lane which runs east from Newhouses and is near the gate which terminates the enclosed (walled) part of the lane.

9) Relationships

Barns L, M, and P (see separate reports) have, as does Barn K enclosed adjoining yards. Barn K is not now so apparent. The ground level to this 'yard' is slightly raised, especially relative to the lane, suggesting a "platform" i.e. the outline of a former building. The position at the end of the walled part of the lane makes this seem a significant site, and it is quite likely that there was once a house there.

OTHER INFORMATION

10) Initials/Datestones

none

11) Oral information from owner/occupier

none

12) Documentation: maps, inventories, etc.

First edition Ordnance Survey map 6" of 1850.

O.S. map 1910.

13) Plans, etc., annexed (please tick)

- | | |
|-------------------------------------|-------------------|
| - block plan of site | - sections |
| - ground floor plan | - elevations |
| - first floor plan | - detail drawings |
| - analytical plan | - photographs |
| - copies of inventories, maps, etc. | |

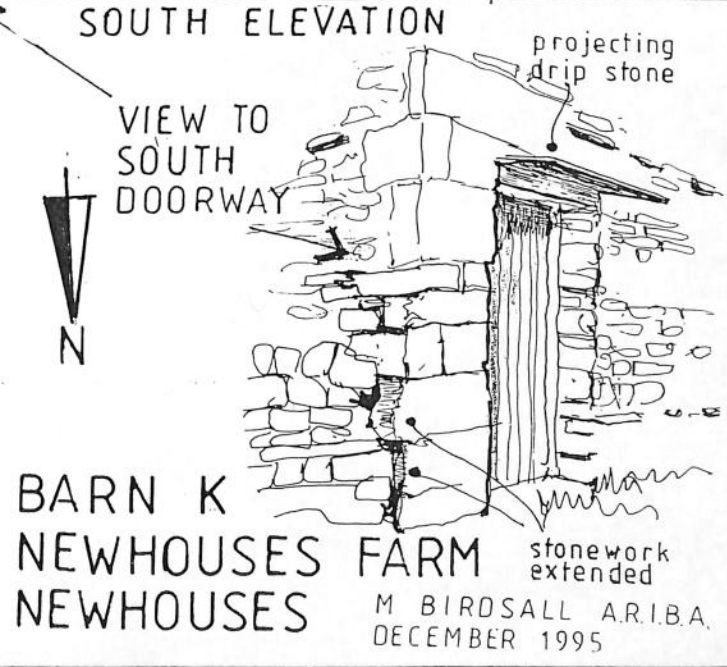
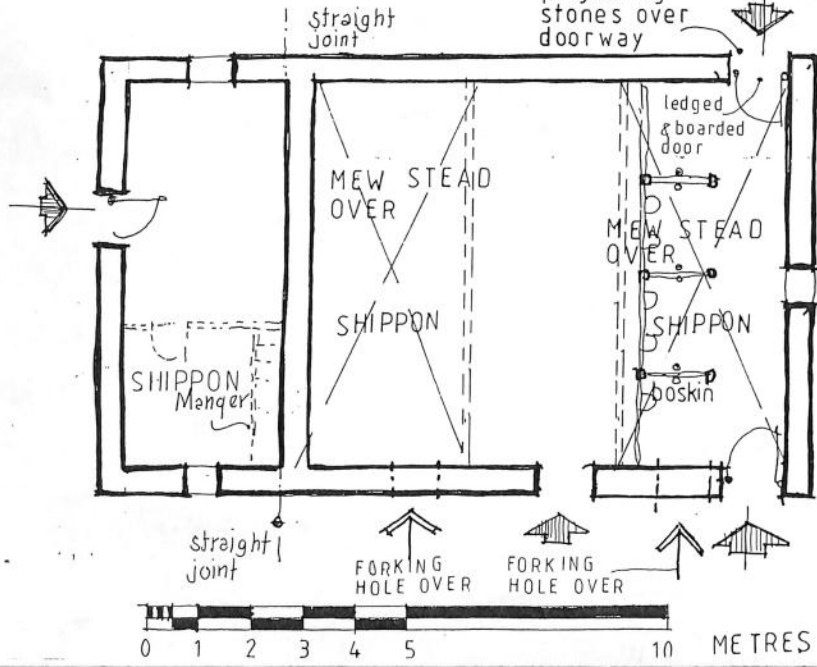
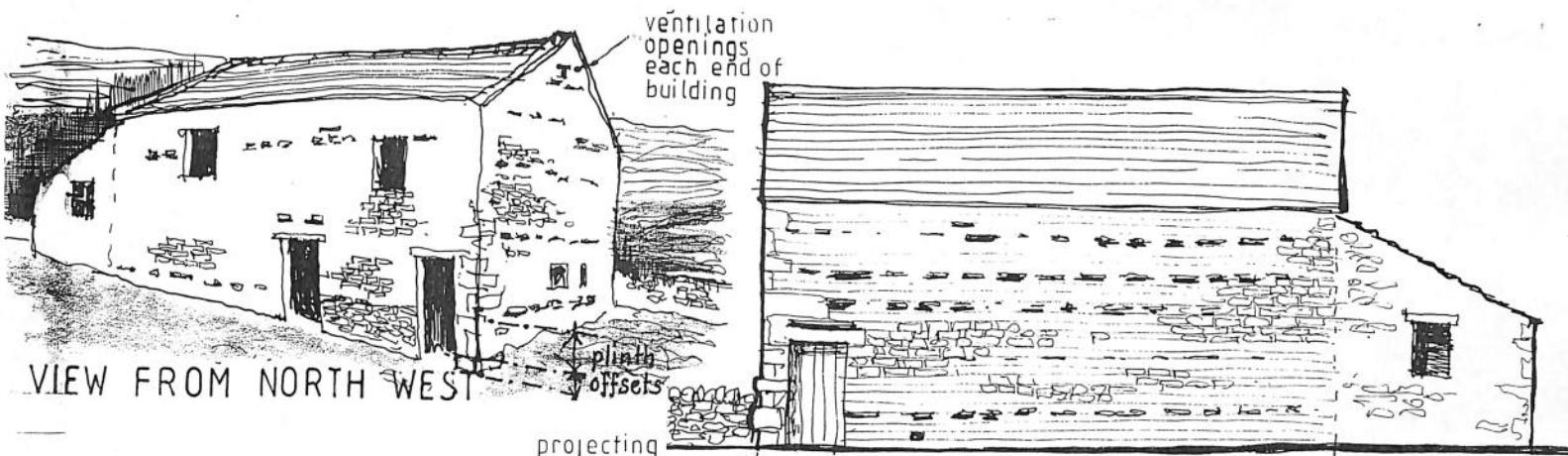

BARN K
 NEWHOUSES FARM
 NEWHOUSES
 M BIRDSALL A.R.I.B.A.
 DECEMBER 1995

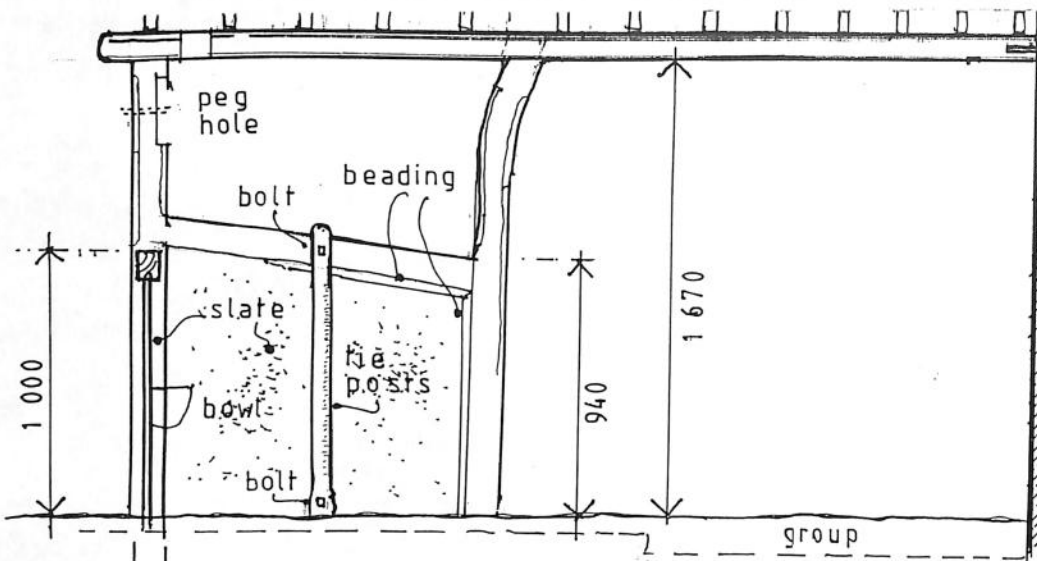

group
CROSS SECTION

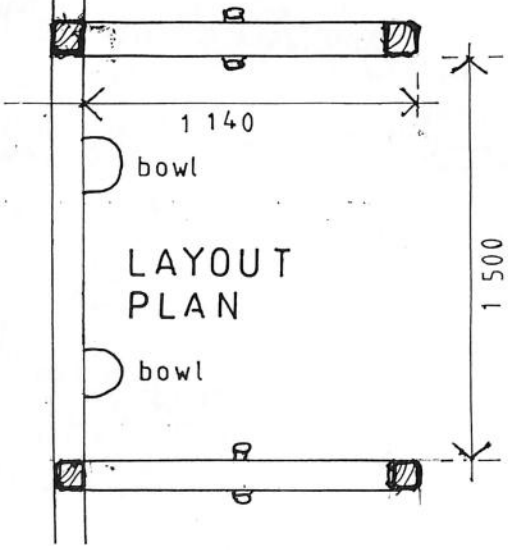

LAYOUT PLAN

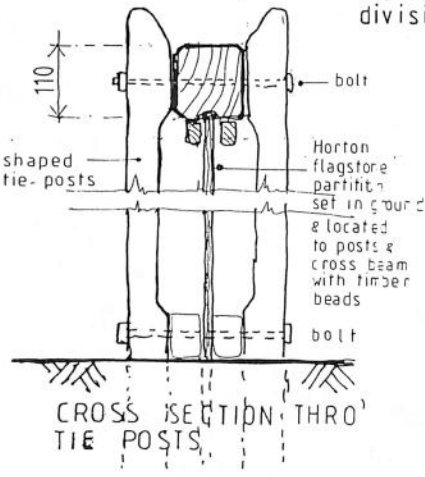

CROSS SECTION THRO' TIE POSTS

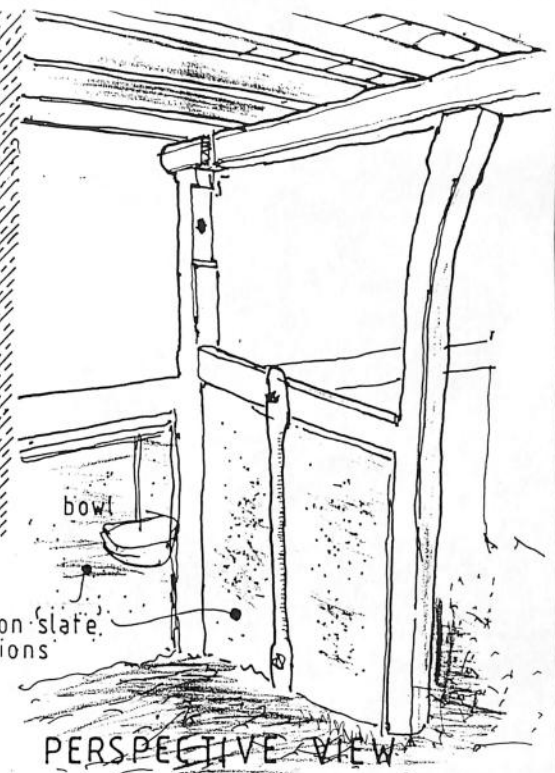

PERSPECTIVE VIEW

BOSKIN'S
BARN &
NEWHOUSES FARM
NEWHOUSES

M BIRDSALL MARCH 1996

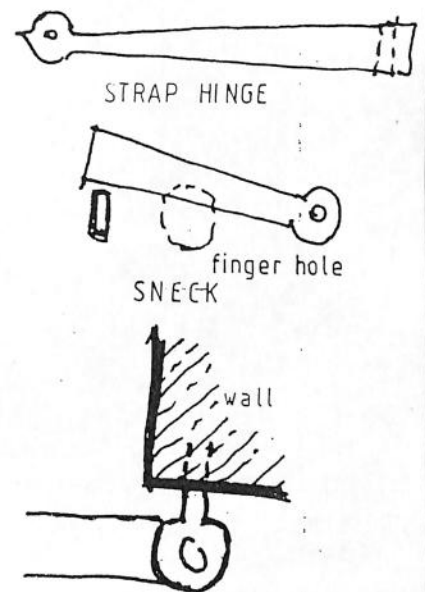
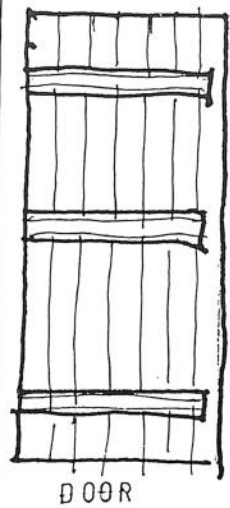
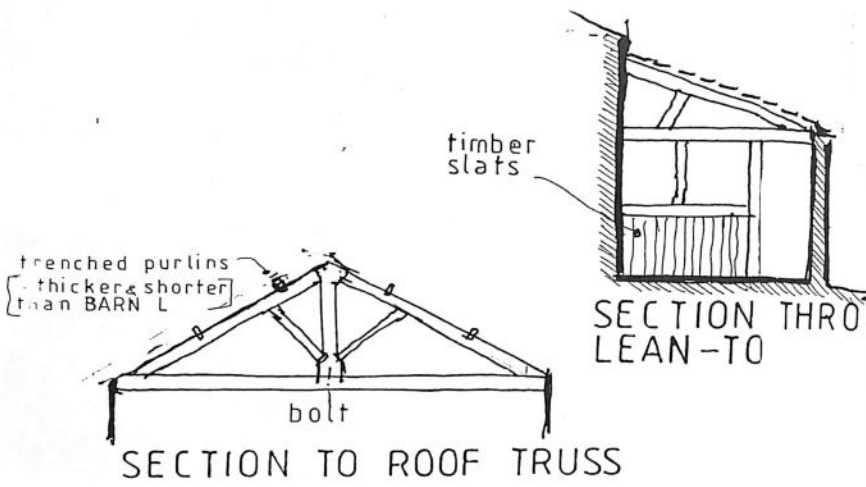

SOUTH DOORWAY DETAILS

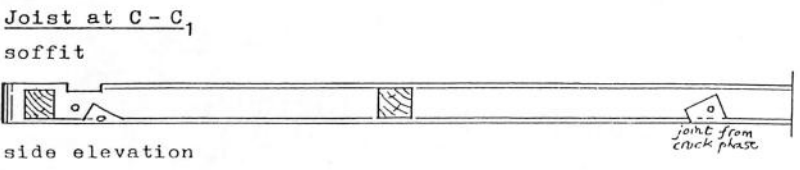
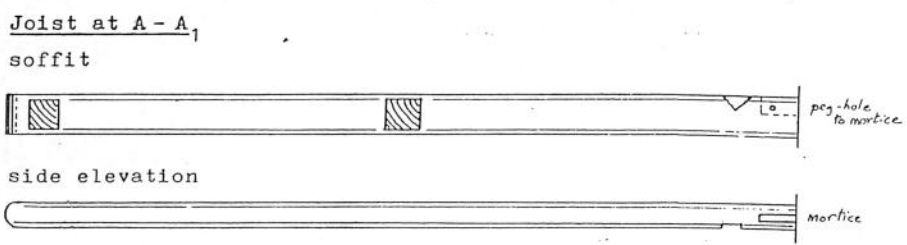

A. PACEY
APRIL 1996

BARN K
NEWHOUSES FARM
NEWHOUSES

M BIRDSALL MARCH 1996

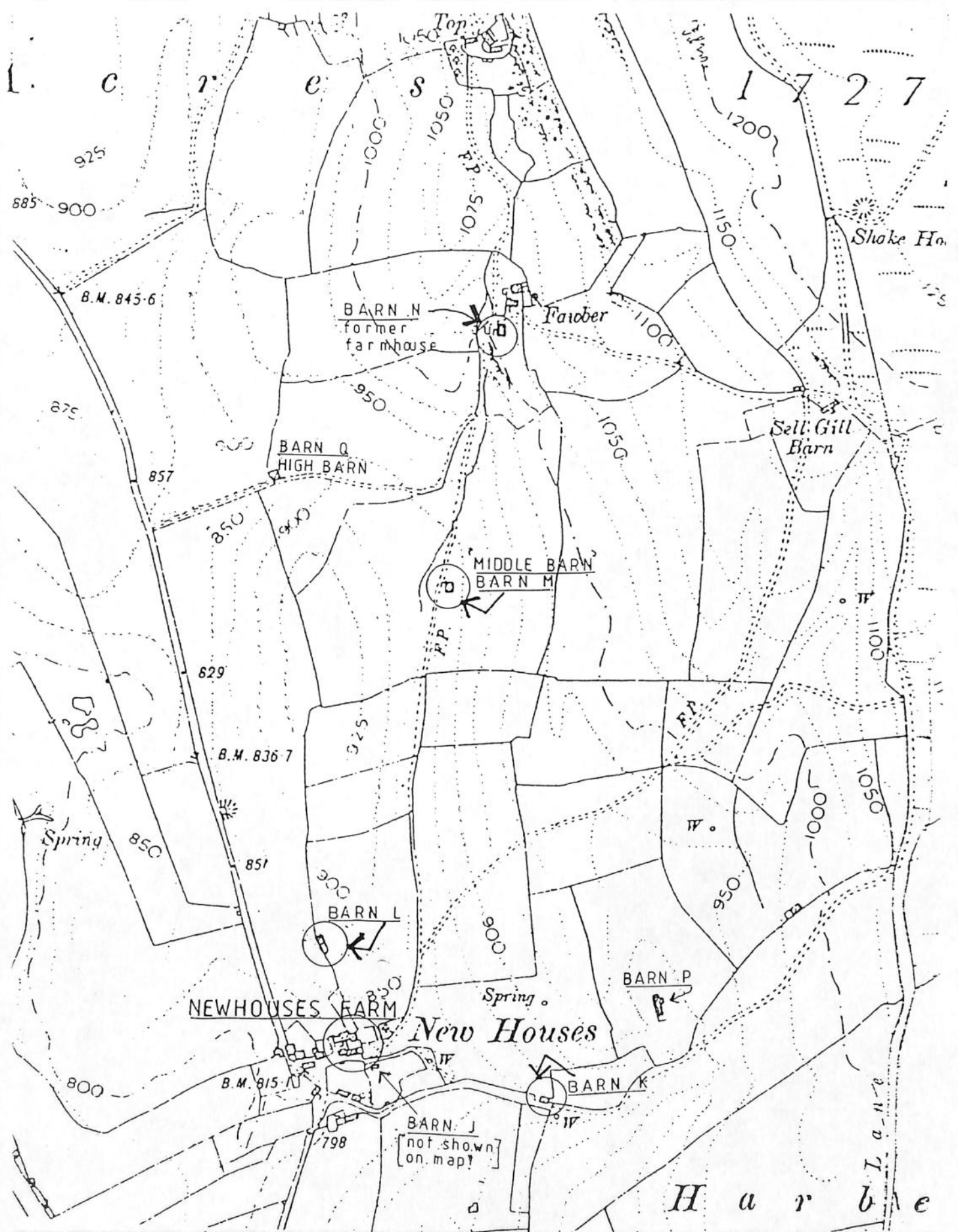

**NEWHOUSES FARM
NEWHOUSES**

© BIRDSALL 1996

**LOCATION OF FARMSTEAD
& ASSOCIATED BARNs**

FROM 6" O.S. MAP 1910 [enlarged]



NEWHOUSES FARM
NEWHOUSES

LOCATION OF FARMSTEAD
& ASSOCIATED BARNs
FROM 6" O.S. MAP 1850 [Enlarged]

A BARN SPOTTER'S GUIDE

TWO-DOOR BARN
(Dales type; evolved in 18th century as a field barn.)

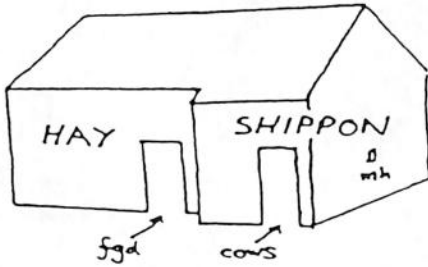

[mh = mucking-out hole
fgd = foddergang / doorway]

STANDARD LAITHE (widespread in the Pennines)

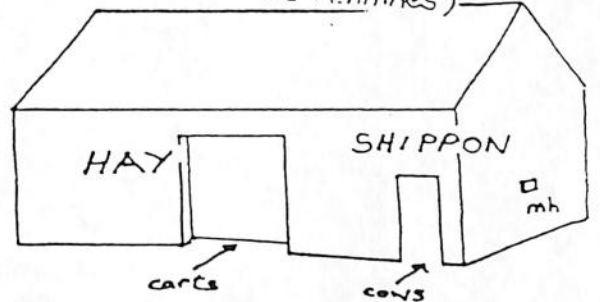
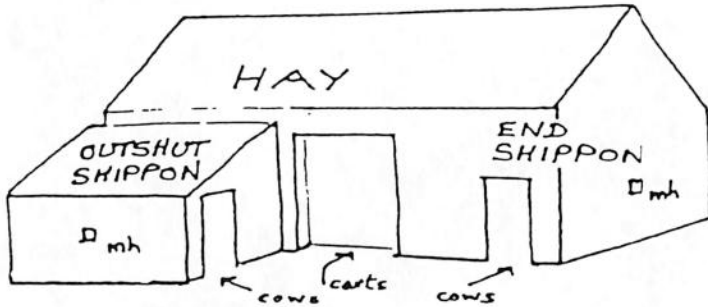

OUTSHUT-SHIPPON BARN

(Usually formed by adding an outshut to a standard laithe; common as a field barn south of Horton.)

GABLE-ENTRY BARN (dated examples from c.1680)

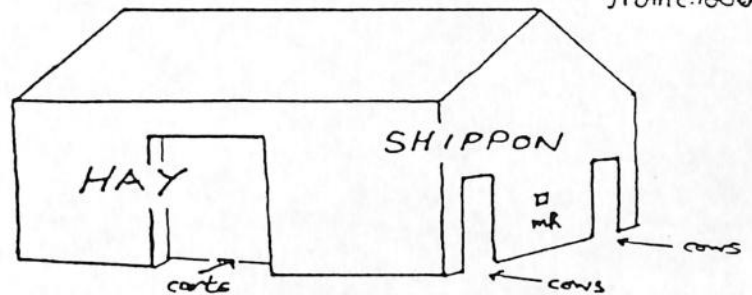

LONG OUTSHUT BARN (OR CONTINUOUS OUTSHUT)
(19th century type, often formed by adding outshut to earlier field barn.)

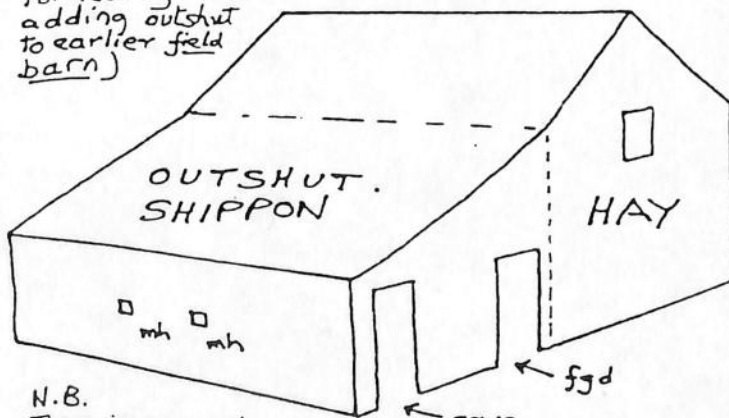

N.B. There is no cart entrance on the other side.

BANK BARN
(Cumbrian type; German origin, c.1600?)

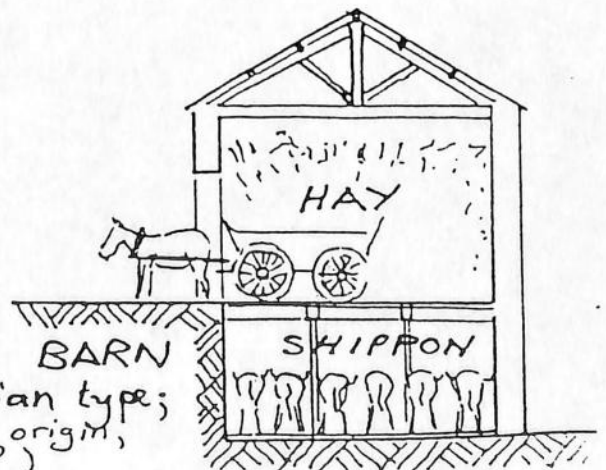

North Yorkshire
Modern county (Historic county)

YORKSHIRE
VERNACULAR BUILDINGS
STUDY GROUP 1519

office use

Horton in Ribblesdale
Parish or township

BARN L (North of Newhouses
Name of building Farm)

SD 806 738
National Grid ref.

Mr. & Mrs. Davidson

Owner or occupier

Newhouses Farm , Newhouses,

Address

Nr. Horton in Ribblesdale

North Yorkshire

Postcode

No

Building listed? Grade?

Date of record; names of recorders
Note of major alterations or
demolitions since the survey

Malcolm Birdsall 1st, July 1995. April 1996.
Arnold Pacey April 1996.

DESCRIPTION

1) Building type / purpose

Gable entry barn with no cart entry.

2) Materials

Limestone with a mix of sandstone walling.
Thin bedded stone slated roof.

3) Exterior detail

(especially detail not clear on drawings, e.g. label moulds, sections of mullions)

Roof has thin corbel stones approx 150mm wide bedded in mortar to gable ends. Ridge is formed out of stone.

Limewash evidence of rendering to walls .

Opposed high level 'owl-holes' to each gable.

Walling random brought roughly to course.

4) Interior detail

(especially detail not clear on drawings, e.g. chamfer stops)

Boskins partly dilapidated.

5) Plan form

Gable entry barn built partly into hillside. One entrance only for passage of animals and removal of hay. Evidence of wall enclosure to entrance incorporating gateway and trough.

DATING

6) Identify the oldest part of the building and indicate a likely date

Appears to be of one build. 1790-1820.

7) Major extensions or alterations

None

SETTING

8) Orientation

North to South.

9) Relationships

North of Newhouses Farmhouse.

OTHER INFORMATION

10) Initials./ Datestones

None

11) Oral information from owner/ occupier

None

12) Documentation: maps, inventories, etc.

First Edition Ordnance Survey Map 6" of 1850 -Sheet 97 SW
O.S. Map 1910.

13) Plans, etc., annexed (please tick)

- | | |
|-------------------------------------|-------------------|
| - block plan of site | - sections |
| - ground floor plan | - elevations |
| - first floor plan | - detail drawings |
| - analytical plan | - photographs |
| - copies of inventories, maps, etc. | |

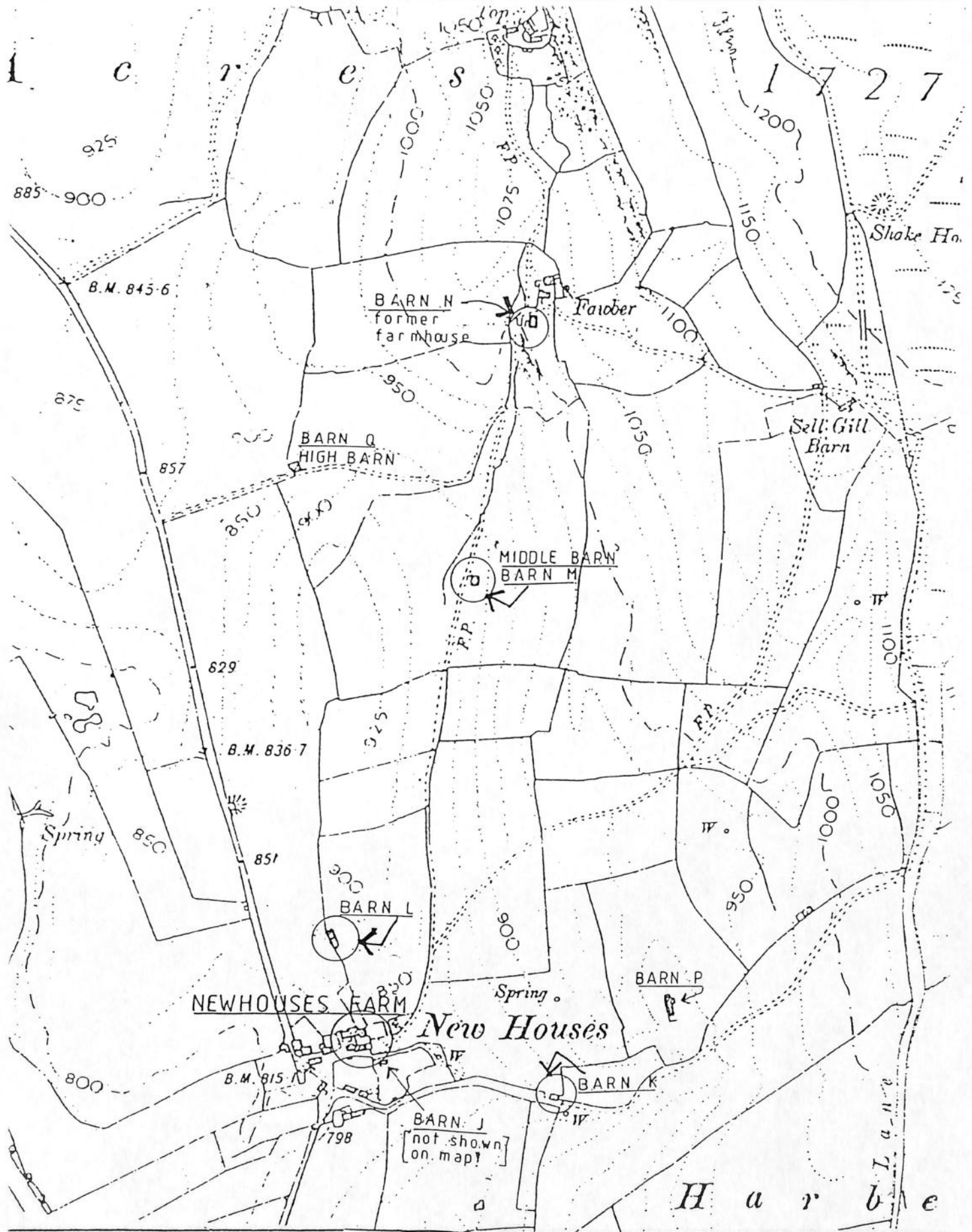

NEWHOUSES FARM
NEWHOUSES

LOCATION OF FARMSTEAD
& ASSOCIATED BARN

FROM 6" O.S. MAP 1910 [Enlarged]

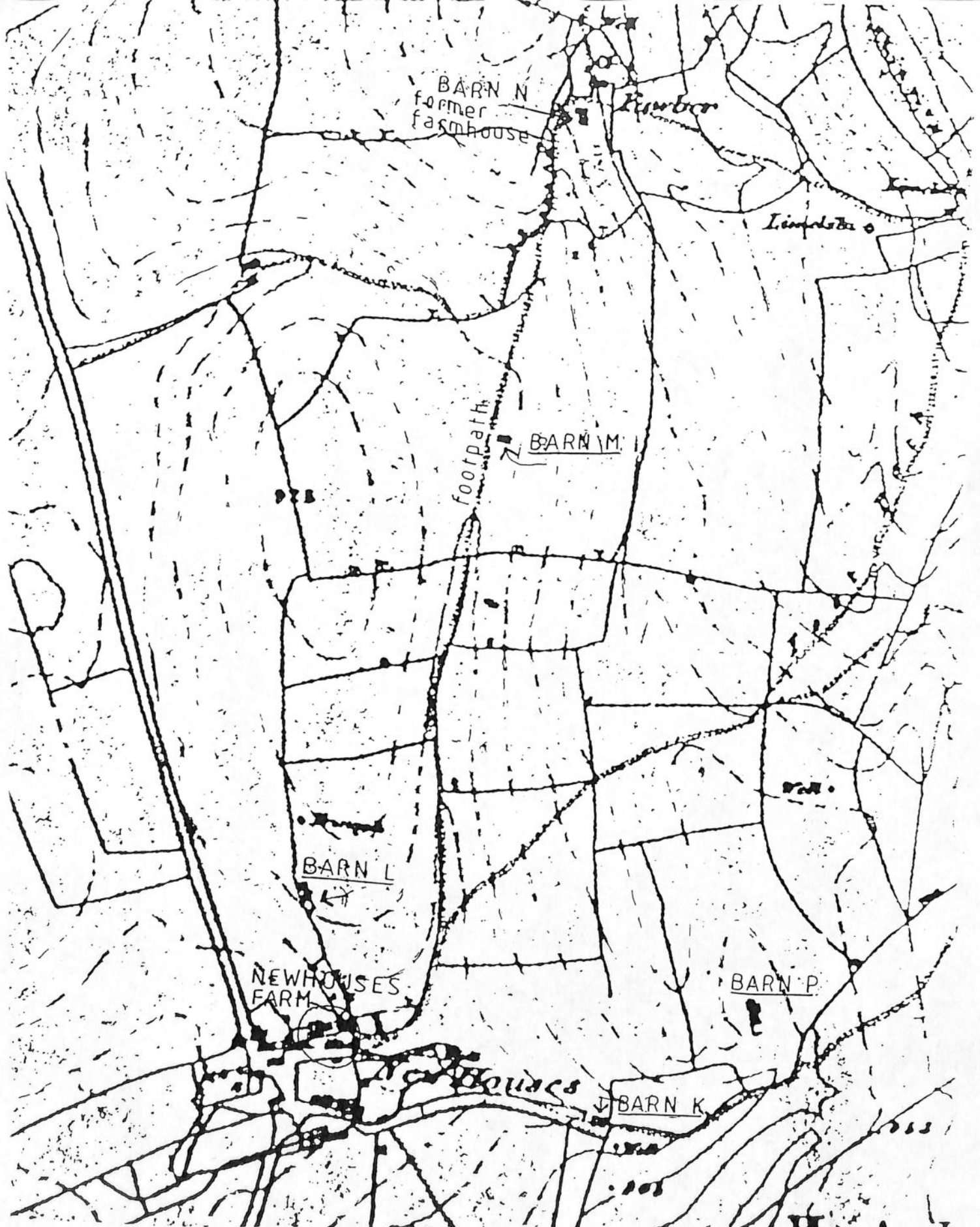

NEWHOUSES FARM
NEWHOUSES

LOCATION OF FARMSTEAD
& ASSOCIATED BARN
FROM 6" O.S. MAP 1850 [enlarged]

BARN L

This building is situated high on a drumlin 100 metres north of Newhouses Farm at map reference SD 805737.

It is an outstanding barn in terms of the high quality of workmanship in stonework, and also in the carpentry of boskins and the panelled door.

In the yard or fold on the south side is a water trough, also of excellent workmanship, carved from sandstone (rather than assembled from slabs of local 'slate' like many other troughs).

There is only one door into the barn and this opens onto this yard. The steeply sloping ground would have made a separate foddergang doorway impossible.

The barn appears to have been very little altered since it was first built, and the following features are characteristic of its date:

- 1) The walls have very regular projecting string courses of 'slate' instead of having the rough limestone throughs of many 18th century barns.
- 2) The king-post trusses are of Baltic pine, which was not commonly used until the later 18th century, and is more characteristic of the 19th century. The barn appears to have been built with these trusses. They are not a replacement for an earlier roof, as in so many other barns.
- 3) The door lintel is of a distinctive shape described as a "flattened basket handle". If it were chamfered, it might be dated to c.1750 by comparison with similar doorheads in such places as Lancaster or Addingham. Without a chamfer, it is unlikely to be earlier than about 1780 or 1790.

The barn does not seem to be on an old site, and the above considerations suggest a date of construction between 1790 and 1820.

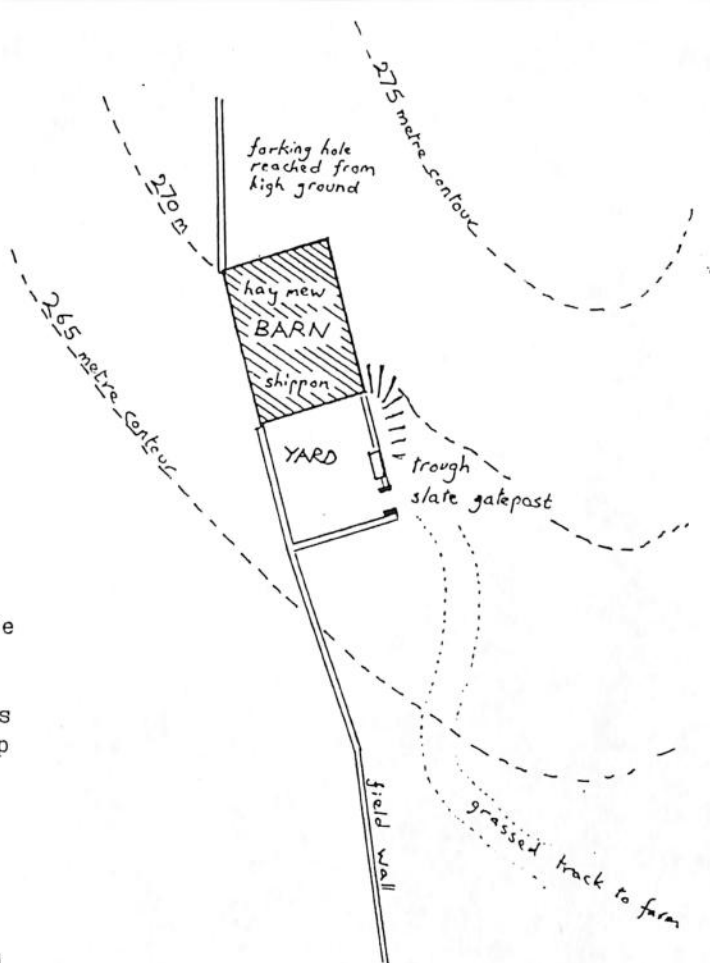

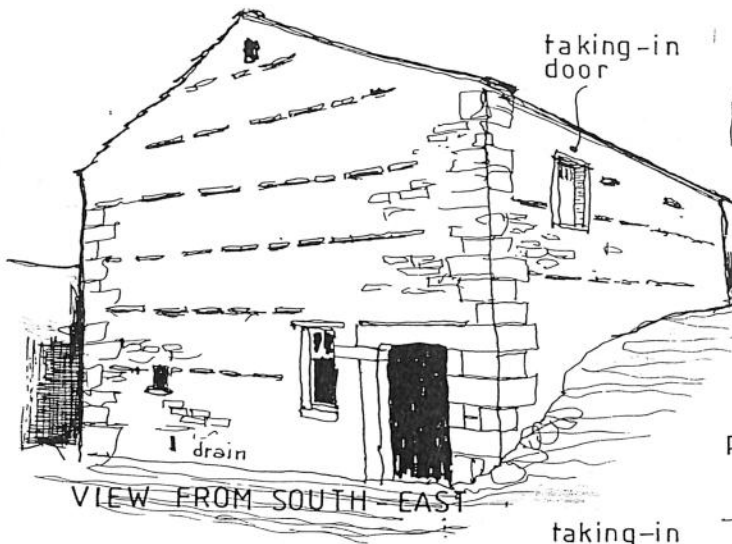

VIEW FROM SOUTH-EAST

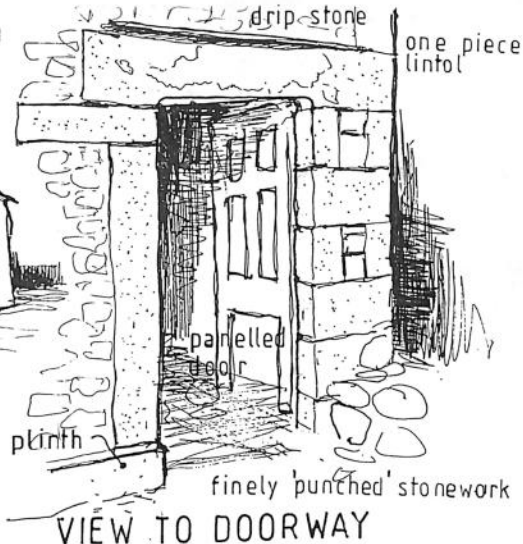

VIEW TO DOORWAY

BARN L
 NEWHOUSES
 FARM
 NEWHOUSES
 HORTON-IN-
 RIBBLESDALE

M BIRDSALL A.R.I.B.A.
 JUNE 1996
 YORKSHIRE VERNACULAR
 BUILDINGS STUDY GROUP

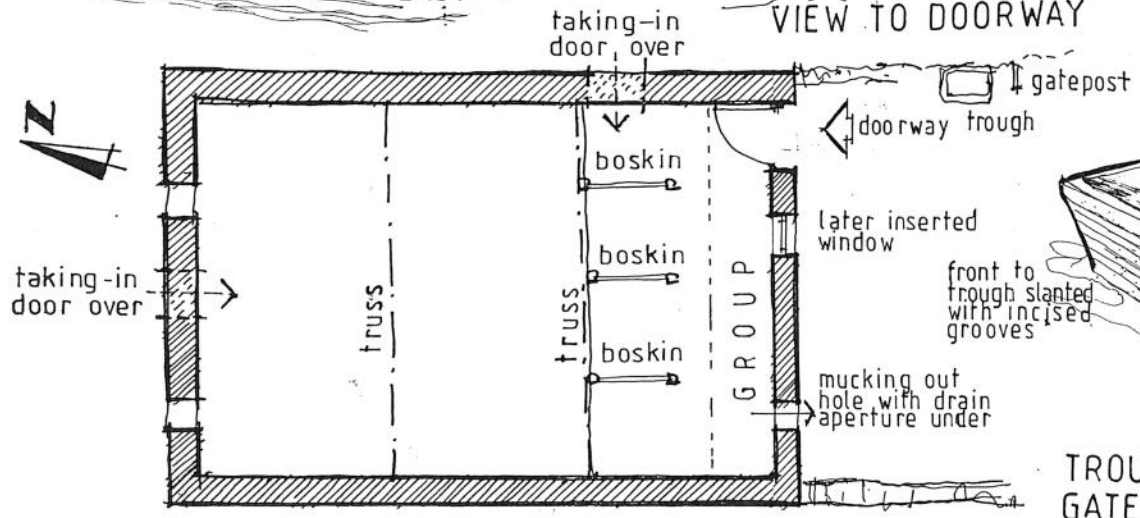

LAYOUT PLAN

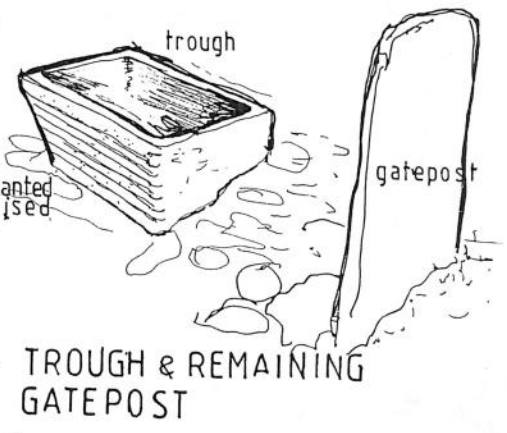

TROUGH & REMAINING GATEPOST

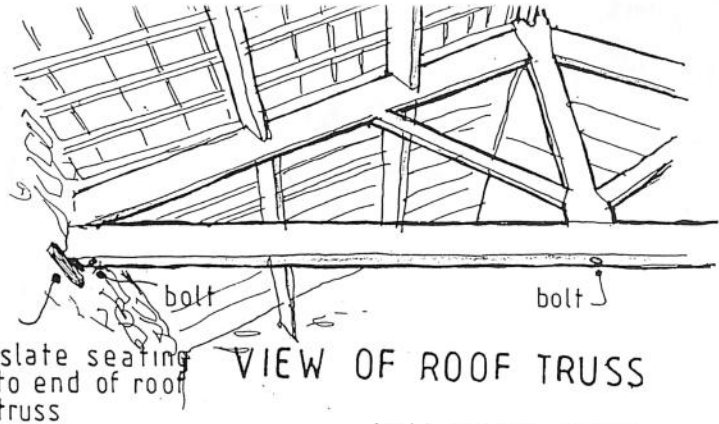

VIEW OF ROOF TRUSS

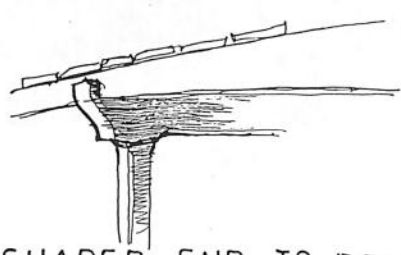

SHAPED END TO BEAM OVER BOSKINS

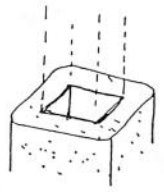

POST HOLDER - stone

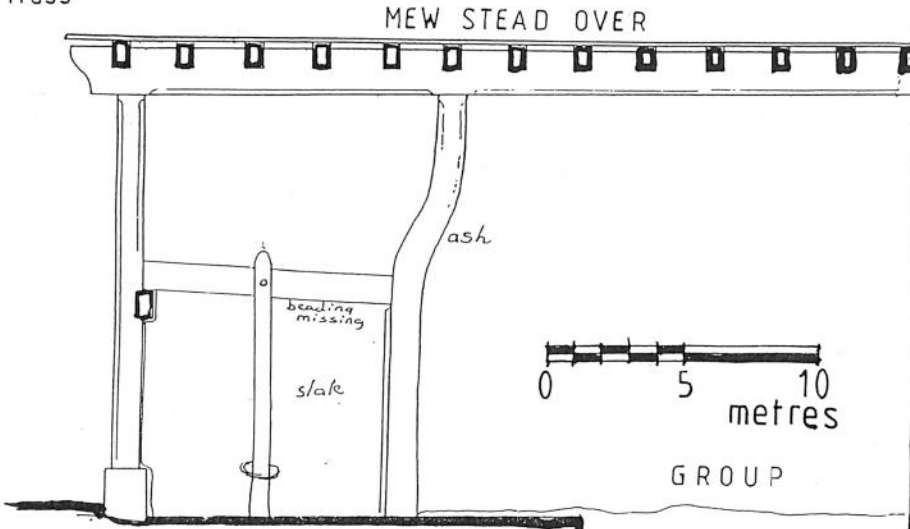

DETAIL SECTION / ELEVATION TO BOSKINS A. PACEY

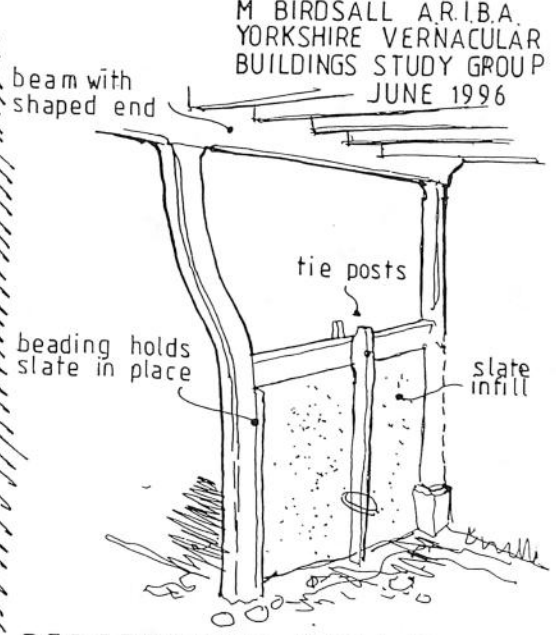

PERSPECTIVE VIEW TO BOSKINS

M BIRDSALL A.R.I.B.A.
YORKSHIRE VERNACULAR
BUILDINGS STUDY GROUP
JUNE 1996

BARN L NEWHOUSES FARM

North Yorkshire
Modern county (Historic county)

YORKSHIRE
VERNACULAR BUILDINGS
STUDY GROUP 1517

office use

Horton in Ribblesdale BARN(M)between Fawber & New Houses. SD 807745
Parish or township Name of building National Grid ref.

Mr. & Mrs. Davidson.

Owner or occupier

Newhouses Farm

Address
Newhouses, Nr. Horton-In-Ribblesdale

Postcode

Not known

Building listed? Grade?

Date of record; names of recorders
Note of major alterations or
demolitions since the survey

Sue Southwell, John Wood, David Cant, Cathy Small,
Malcolm Birdsall. 1st. July 1995
M. Birdsall/A. Pacey April 1996.

DESCRIPTION

1) Building type / purpose
Long Outshot Barn

2) Materials

Walling-limestone with some sandstone quoins. Thin-bedded stone slated roof
Timber framed boskins with brick flooring and stone edging to Group drainage channel
in Shippon.

3) Exterior detail
(especially detail not clear on drawings, e.g. label moulds, sections of mullions)

Protruding 'through-stones in horizontal bands of individual stones for 'bonding'
the walls.

The walls have been limewashed.

4) Interior detail
(especially detail not clear on drawings, e.g. chamfer stops)

King-Post roof trusses with trenched purlins. Baltic timber. Haunching to king-post
at intersection with tie beam.

5) Plan form

See-enclosed "A Barn Spotters Guide" prepared by Arnold Pacey of The Yorkshire Vernacular Buildings Study Group 1995.

This identifies different types of barn layouts in the Horton-in-Ribblesdale area. Barn 'M' falls into the Long Outshot Barn category. There is no cart entry. Hay would have been stored at high level (mew stead) and cattle housed below-entry being from two openings in the former gable wall (where the outshot shippon has been added)

DATING

6) Identify the oldest part of the building and indicate a likely date

The field barn appears on the first O.S. 6" map dated 18. ., and the Outshot appears on the 6" map dated 19. . The field barn with its roof truss arrangement may be dated to the early 19C and the Outshot Shippon to the late 19C.

7) Major extensions or alterations

Outshot shippon added in the late 19C.

SETTING

8) Orientation

The two entry positions are located on the East side. On this side is a paddock enclosure.

9) Relationships

The Barn is located alongside a footpath between New Houses and Fawber.

OTHER INFORMATION

10) Initials./Datestones

None.

11) Oral information from owner/occupier

None.

12) Documentation: maps, inventories, etc.

First Edition Ordnance Survey Map 6" of 1850. [sheet 97 SW]

Ordnance Survey Map of 1970.

13) Plans, etc., annexed (please tick)

- | | |
|---------------------------------------|---------------------|
| - block plan of site ✓ | - sections ✓ |
| - ground floor plan ✓ | - elevations ✓ |
| - first floor plan | - detail drawings ✓ |
| - analytical plan | - photographs |
| - copies of inventories, maps, etc. ✓ | |

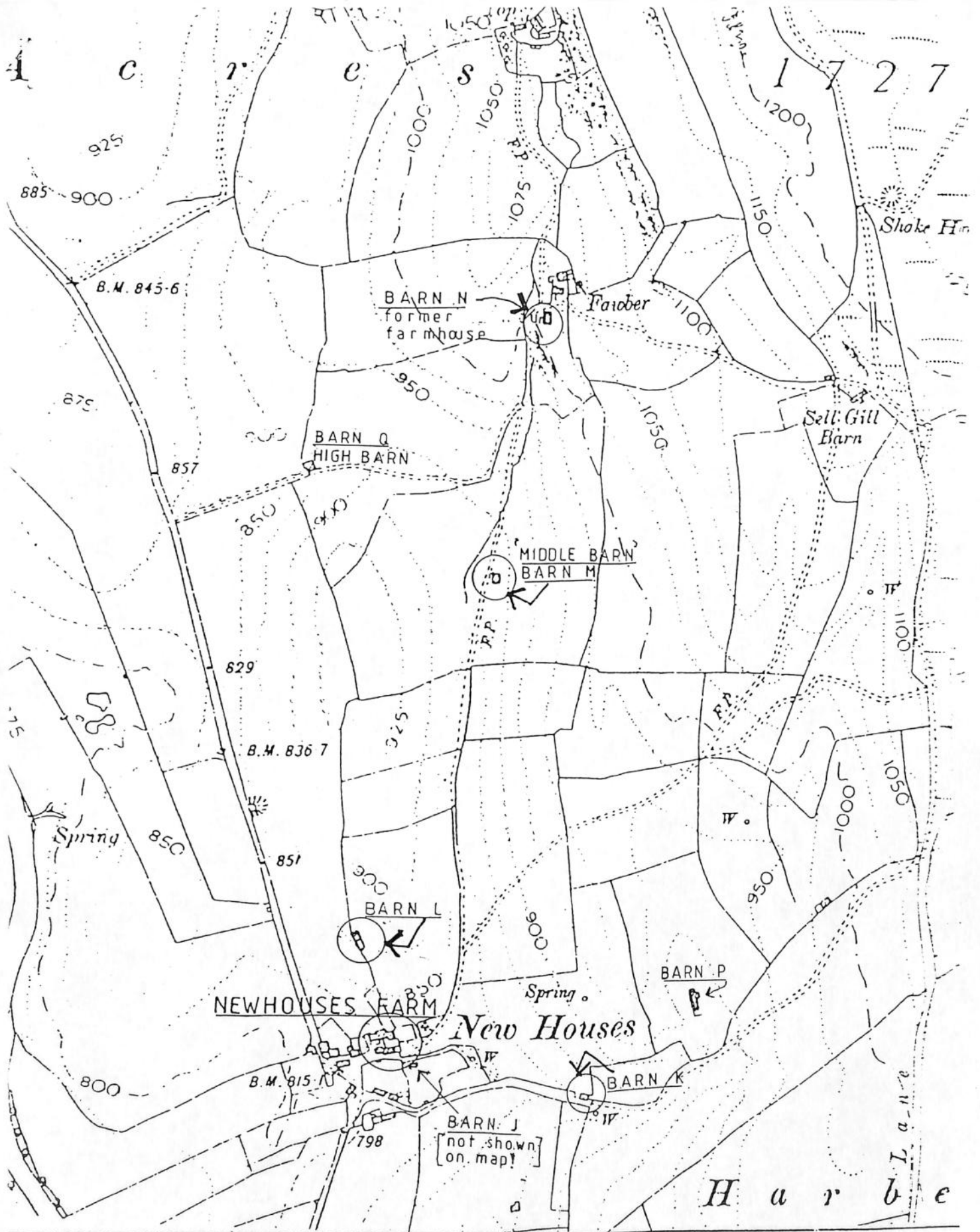

**NEWHOUSES FARM
NEWHOUSES**

LOCATION OF FARMSTEAD
& ASSOCIATED BARN
FROM 6" O.S. MAP 1910 [enlarged]

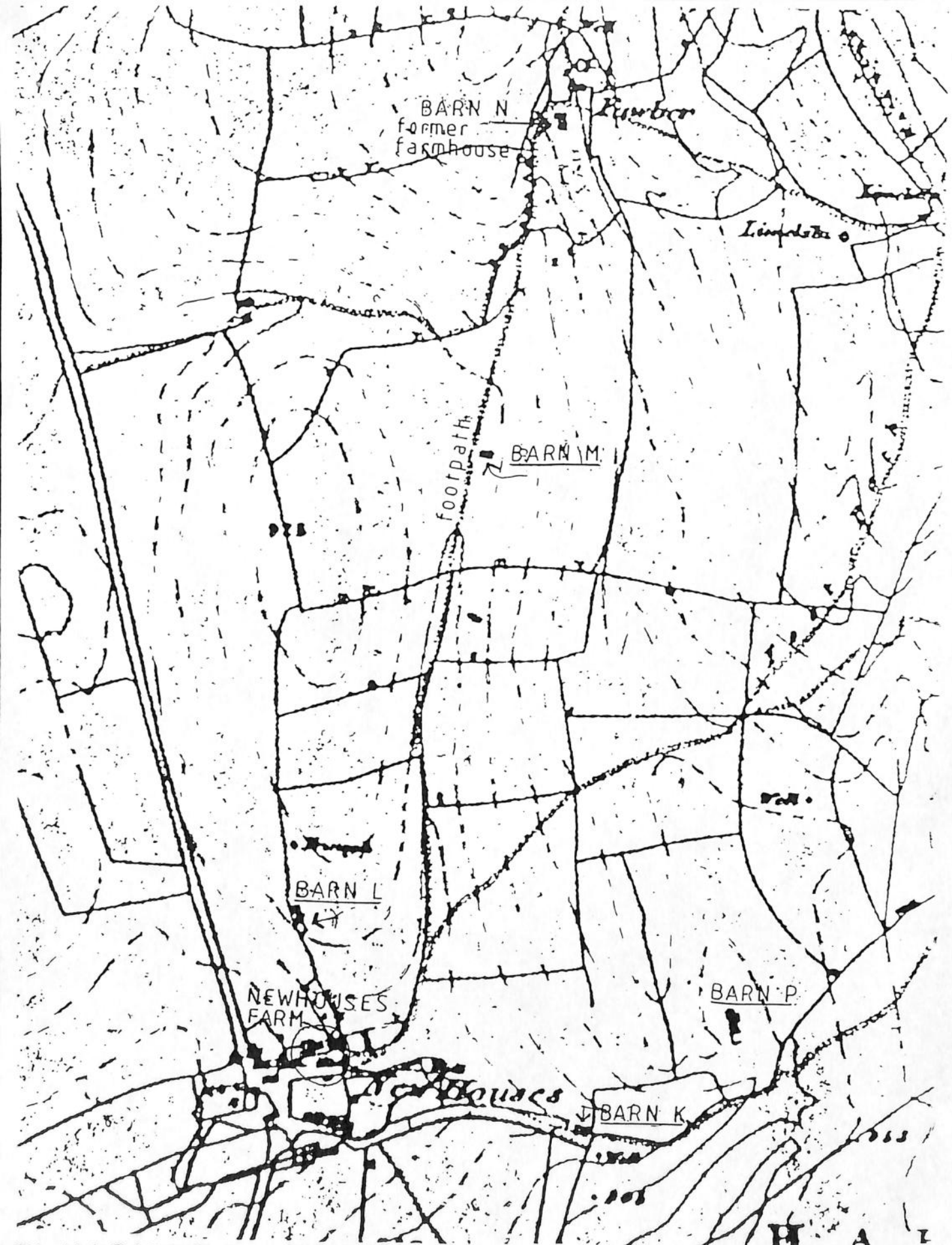

BARN N
former
farmhouse

Limekiln

Limekiln

footpath

BARN M

D.T.B.

BARN L

NEWHOUSES
FARM

BARN P

BARN K

Newhouses

H A I

NEWHOUSES FARM
NEWHOUSES

LOCATION OF FARMSTEAD
& ASSOCIATED BARN
FROM 6" O.S. MAP 1850 [enlarged]