

EDUCATION DEPARTMENT

We

B. 314 M

WEST RIDING
 COUNTY COUNCIL
 13 JUN 1955
 EDUCATION DEPARTMENT.
 DIVISION 31.

Horton-in-Ribblesdale Helmswith Bridge School - 432c.
 Additional Land (865).

Mr. E. B. Nelson

Referring to my minute dated 20th October, since the site selected severs the remainder of the field from its highway access and water supply it has been found necessary to again alter the boundaries of the site by taking a similar area from the eastern side of O.S. field 689 as shown on the attached plan, which kindly retain for record purposes, *instead of the area on the south of this field as originally proposed.*

When the area of land is eventually acquired it will be necessary to fence the northern and western boundaries and to make a new gateway from the road near the northern boundary wall to provide access to the remainder of the field.

A. B. Clegg

9th June, 1955.

HORTON - IN - RIBBLESDALE HELWITH BRIDGE M & I SCHOOL

PLAN REFERRED TO

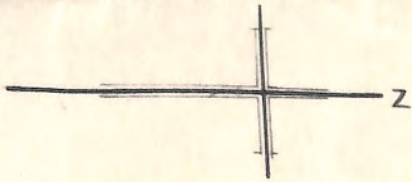
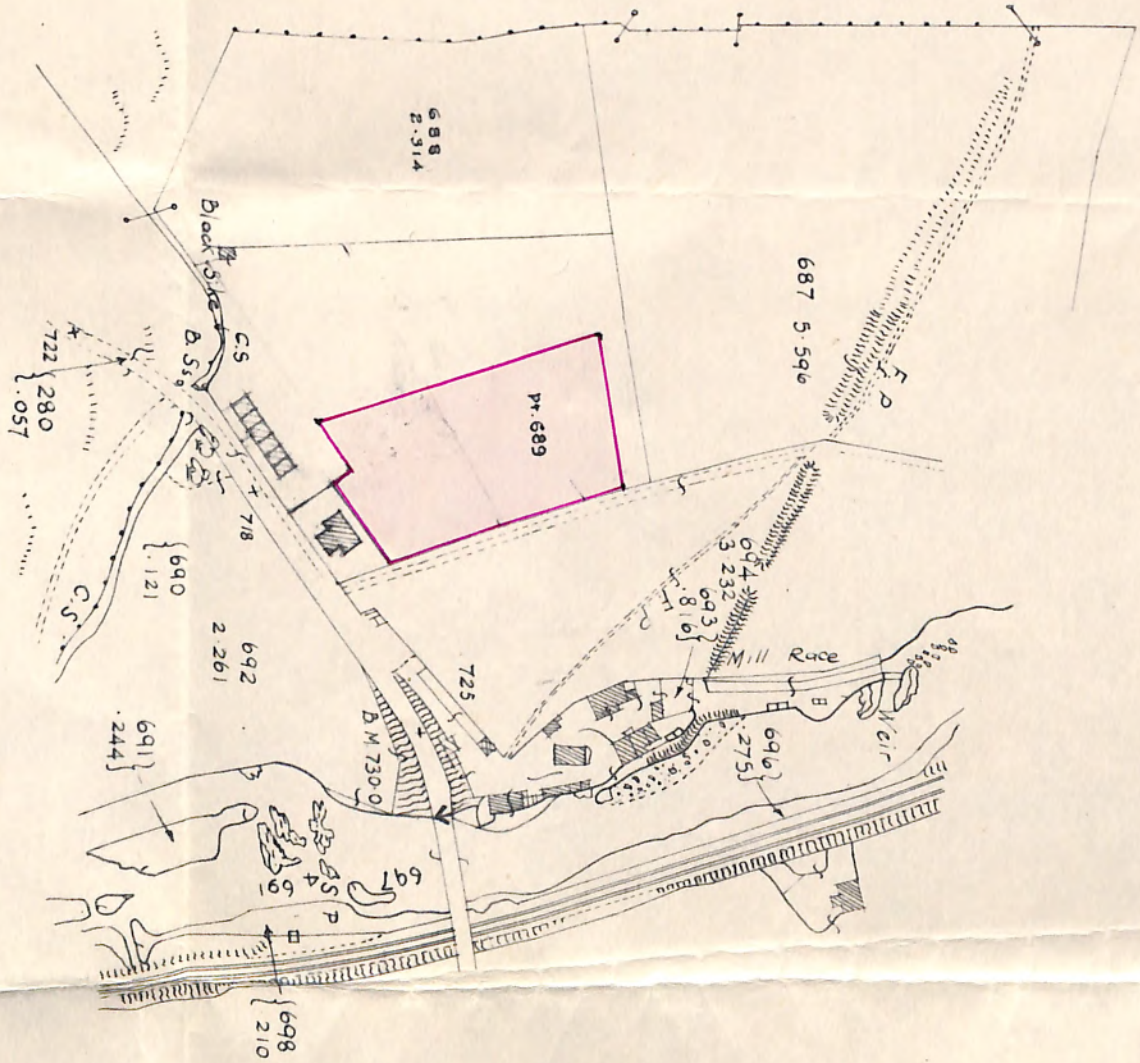

Scale 1/2500

Area Edged Red 1.116 Acres

COPYRIGHT RESERVED
 13 APR 1985
 COUNTY ARCHIVES & RECORDS
 COUNTY HALL, WAKEFIELD

Grand Open (or Reproduced from) the Ordnance Survey Map
 with the sanction of the Controller of H.M. Stationery Office.

O.S. 114 / 9/10/1909

27th. October, 1955.

Helwith Bridge County Primary School.
Report by H.M. Inspectors.

Dear Miss Swainson,

The Report by H.M. Inspectors following a visit of inspection to your School on the 7th. September, 1955, was considered by the Settle District Education Sub-Committee at their Meeting held on Tuesday last. The Report was received with every satisfaction.

It was the Committee's unanimous decision that I convey to you their congratulations on the excellent nature of the Report.

Yours sincerely,

Acting Divisional Education Officer.

Miss M.P. Swainson,
County Primary School,
Helwith Bridge,
Horton-in-Ribblesdale.

COUNTY COUNCIL OF THE WEST RIDING OF YORKSHIRE
EDUCATION DEPARTMENT

COUNCIL
14 OCT 1955
EDUCATION DEPARTMENT.
DIVISION 31.

R.

M. 73.

HORTON-IN-ABBESDALE HEALWITH BRIDGE CTY School
Report by H.M. Inspectors.

Acting S.E.O.

Mr

DN 31

With reference to Circular D.O. 54/283 of the
10th November, 1954, I attach hereto 30 copies of a report
by H.M. Inspectors following their visit of inspection to the
above-named school on the 4th September 1955.

13 OCT 1955

Congratulations, etc A.B. Clegg
15

MINISTRY OF EDUCATION

MAYfair 9400

CURZON STREET, LONDON, W.1

Please quote in reply
(addressing to THE SECRETARY) : P50/432A/13

26/9/ 1955

4 OCT 1955

L.E.A.

Yorkshire W.R.

School Horton-in-Ribblesdale, Helwithh Bridge C.

Sir,

I am directed by the Minister of Education to enclose, for the information of the ~~Governors~~/Managers, copies of a Report of H.M. Inspector(s) on the above-named school.

The Report is confidential and may not be published save by express direction of the competent authority of the School. If published, it must be published in full.

A copy of the Report has been sent to the Head ~~Master~~/Mistress. Copies of the Report have also been sent to the Local Education Authority, and to the ~~Council of the Excepted District/Divisional Executive~~.

All communications regarding the Report and the Ministry's remarks should be addressed, in the first instance, to the Local Education Authority. They should be addressed through the Council of the Excepted District or the Divisional Executive if the question at issue is within the scope of powers delegated to those bodies by the Authority.

Entries in the Log Book or other school record book should record the receipt of any report on the school sent by the Ministry to the ~~Governors~~/Managers and any remarks made thereon by the Ministry.

I am, Sir,

Your obedient Servant,

To the Correspondent to the ~~Governors~~/Managers.

Form 22(a) Schools

MINISTRY OF EDUCATION

Report by H.M. Inspectors

on

HELWITH BRIDGE COUNTY SCHOOL,
HORTON-IN-RIBBLESDALE, YORKSHIRE, (WEST RIDING).

Inspected on

7th September, 1955.

NOTES

- 1. This Report is confidential and may not be published save by the express direction of the competent authority of the School. If published it must be published in its entirety.*
- 2. The Copyright of the Report is vested in the Controller of H.M. Stationery Office. The Controller has no objection to the reproduction of the Report provided that it is clearly understood by all concerned in the reproduction that the Copyright is vested in him.*

MINISTRY OF EDUCATION, CURZON STREET, LONDON, W.1.

This small village school is fortunate in its comparatively modern building, which is well furnished and equipped. Numbers have recently fallen so that the strength of the teaching staff has been reduced from two to one, but the five infants and five juniors who are in the school at present are being given a thoroughly sound education. They are offered an abundance of interests and experiences and are both industrious and responsive. The older children read with enthusiasm, write freely upon a wide variety of subjects, and take a delight in illustrating their work.

The school is a vigorous little community which owes a great deal to the energy, resourcefulness and teaching capacity of the Head Mistress, who is to be congratulated upon the quality and range of the work which she has accomplished.

County Supply Staff.
Horton-in-Ribblesdale Helwith Bridge School.
Miss M.P.Swainson.

Mr. Clegg.

Thank you for your Minute of the 10th. instant regarding the above.

The difficulties in allocating a member of the County Supply Staff to the above-named school either in January or after Easter next year are appreciated.

The Settle District Education Sub-Committee have decided that Miss Swainson be not permitted to terminate her engagement at the above-named school before the end of the Spring Term 1956 unless a temporary teacher can be found to take charge of the school, but that in this event, her early release be approved.

If I am able to secure the services of a temporary teacher for next term, I will let you know immediately.

25th. November, 1955.

EDUCATION DEPARTMENT

My reference S. 78/93/Le.

County Supply Staff.
Horton in Ribblesdale Helwith Bridge School.
Miss M.P. Swainson.

The Acting
Divisional Education
Officer: Settle:

In reply to your minute of the 4th November, I will
arrange for the headship of the above-named school to be advertised.

With regard to Miss Swainson's request for an early release,
it is extremely difficult at present for me to say whether or not
it would be possible to replace Miss Swainson by a member of the
County Supply Staff as from the beginning of the Easter Term.

As you know there are no County Supply Teachers in the area
and it is likely that a Supply Teacher so allocated would have to
travel from the Skipton or Ilkley areas. Such an appointment would
entail journeys of over 30 miles in each direction (if the teacher
has a car).

In view of this problem and the difficulty of staffing
other schools (particularly the Secondary Modern Schools, some of
which have 2,3,4,5, and even 6 vacancies) I cannot guarantee that
a County Supply Teacher could be sent to Helwith Bridge School in
January.

10th November, 1955.

A. B. Clegg

No.
To terminate
at Easter
unless a
Temporary Head
can be found.

Mr. Clegg.

Horton-in-Ribblesdale Helwith Bridge
County Primary School.
Miss M.P.Swainson.

Thank you for your minute of the 31st. October, 1955, and enclosure.

I have acknowledged Miss Swainson's resignation as Head Teacher of the above-named school, to take effect at the end of the Spring Term, 1956.

With regard to Miss Swainson's request for an early release so as to permit of her taking up duty at Windermere as from the commencement of next term, in the absence of an early meeting of the Settle District Education Sub-Committee, I have consulted the Chairman.

We are of the opinion that unless a member of the County Supply Staff can be allocated to this school for January 1956, Miss Swainson's request for early release be not approved.

There is a shortage of teachers available for temporary duty in this district, and no convenient public transport exists between Settle and Helwith Bridge.

Form S.4 is enclosed.

4th. November, 1955.

~~XXXXXXXXXX~~
~~XXXXXXXXXXXX~~

4th. November, 1955.

Halwith Bridge County Primary School.
Headmistress.

Dear Miss Swainson,

Your resignation as Headmistress of the above-named school has been received.

On behalf of the Authority and the District Education Sub-Committee I accept your resignation, to take effect at the end of the Spring Term 1956, in accordance with the terms of the Memorandum of Agreement.

The question of early release to permit of your taking up duty at Windermere as from January 1956, is being considered, and I will write you as soon as I am in a position to do so.

May I take this opportunity of thanking you for your services to the school. We are sorry to lose you, but at the same time, wish you well in your new appointment.

With good wishes for the future.

Yours sincerely,

Acting Divisional Education Officer.

Miss M.P. Swainson,
4 Halsteads,
Settle.

COUNTY COUNCIL OF THE WEST RIDING OF YORKSHIRE

EDUCATION DEPARTMENT

Your Reference

Our Reference

S78.93. Ed.

S 1000.4622.5655k

1 NOV 1955

Division 31. Morton in Ribblesdale Melwith Bridge Ck School.
Miss M. P. Swainson.

The Acting Divisional
Education Officer,
Division 31.

I attach a letter received from the
above-named teacher in which Miss
Swainson tenders her resignation.

I shall be glad to receive form
P4 so that the vacancy may be advertised.

A. B. Clerk

31st October, 1955.

H. Halsteads,
Settle, Yorks.

29. 10. 55.

The Director of Education,
County Hall,
Wakefield.



Dear Sir,

Helwith Bridge County Primary School,
Horton-in-Ribblesdale, Nr. Settle.
Resignation of Headteacher.

I wish to tender my resignation from the post of Headmistress of Helwith Bridge County Primary School. This is necessary as I have been successful in being appointed Headmistress of Windermere St. Mary's Girls' and Infants' School.

The Westmorland Education Authorities would like me to commence duties at the beginning of next term, but I appreciate that this could only be subject to an early release by the West Riding of Yorkshire Education Authority.

I am aware that three months notice is required but I should be most grateful if it could be found possible to release me for the beginning of 1956.

Yours faithfully,

M P Swanson.

(Headmistress)

Mr. Clegg.

Horton-in-Ribblesdale Helwith Bridge School.

With reference to your minute of the 25th May, 1956, and copy letter of July 16th addressed to Mr. Barry, the Settle District Education Sub-Committee, at a recent meeting, gave further consideration to the future of the above named school, having regard to the wishes of the parents. The Committee unanimously recommended that every effort should be made to keep the school open, and the vacant headship should be re-advertised.

1st August 1956.

Copy to Miss. Inverie

Helwith Bridge bty.

Meeting. 2nd. July 1956. @ 7. pm.

Mr. W. W. Thornber & Acting D.F.O.

10 parents present

~~Endorse~~
Keep school
open

Unanimous wish of parents that the school
should remain OPEN.

If closure is forced upon them, their choice
of school - Horton-in-Ribblesdale Endowed.

Suggest. Vacancy be re-advertised
Good premises - Excellent condition

COUNTY COUNCIL OF THE WEST RIDING OF YORKSHIRE.

EDUCATION DEPARTMENT.

Education Office,
SETTLE,
Yorks.
28th June, 1956.

Dear Mr. and Mrs.

Helwith Bridge County School.

The Settle & District Education Sub-Committee recently considered the future of the above named school, having regard to the fall in the number of children on roll.

If closure of the school becomes necessary, your child/children will be transferred to a neighbouring Primary School and my Committee decided that their Chairman, Mr. W. W. Thornber, of Settle should discuss this matter with you.

I have to invite you to attend a meeting at the Helwith Bridge School on Monday next the 2nd July, 1956 at 7.30.p.m. and hope that you will find it convenient to be present.

Yours faithfully,

Acting Divisional Education Officer.

Sent to 8 parents.

*Copies sent to
Miss J. P. Dudgeon.
Mr. W. W. Thornber.
Miss S. Bickett.*

RIDING
COUNCIL
28 JUN 1956
STATIONERY DEPARTMENT
LEEDS

Helwith Budge, b. l. l. l.
Horton-in-Ribblesdale
Little.
York.

Dear Mr. Riley,

Herewith the
list as requested by you
to day.

- ✓ 1 Mr. H. Wildman,
4, New Houses,
Helwith Bridge.
- ✓ 2 Mr. T. Huddleston,
Studfold.
Horton-in-Ribblesdale.
- ✓ 3 Mr. L. J. Middleton,
Inn Yard,
Helwith Bridge.
- ✓ 4 Mr. W. Lynn
Inn Yard,
Helwith Bridge.

5 ✓ Mr. T. Metcalfe,
Sherwood House.

I'm rather hazy
as to whether this
is H-u-R. or
Stainforth.

6 ✓ Mr. L. Taylor,
13, Foredale Cottages,
Helwith Bridge.

7 ✓ Mr. T. E. Hewitt,
5, Foredale Cottages,
Helwith Bridge.

8 ✓ Mr. J. B. Skypsey,
3, New Houses,
Helwith Bridge.

Yours sincerely
Walter Burket

COUNTY COUNCIL OF THE WEST RIDING OF YORKSHIRE.

EDUCATION DEPARTMENT.

Education Office,
SETTLE,
Yorks.
28th June, 1956.

Dear Mr. and Mrs.

Helwith Bridge County School.

The Settle & District Education Sub-Committee recently considered the future of the above named school, having regard to the fall in the number of children on roll.

If closure of the school becomes necessary, your child/children will be transferred to a neighbouring Primary School and my Committee decided that their Chairman, Mr. W. W. Thornber, of Settle should discuss this matter with you.

I have to invite you to attend a meeting at the Helwith Bridge School on Monday next the 2nd July, 1956 at 7.30.p.m. and hope that you will find it convenient to be present.

Yours faithfully,

Acting Divisional Education Officer.

Helwith Bridge County Primary School.

Miss
Birkett.

I propose to call a meeting of parents of children in attendance at the above-named school early next week, and together with the Chairman of the Settle District Education Sub-Committee, Mr. W.W.Thornber, discuss the suggested closure of the Helwith Bridge County Primary School, and in particular the school, or schools, to which the children may be transferred.

I shall be glad if you will kindly let me have a list of the names and addresses of the parents of all children at present in attendance at your school.

A reply by return would be appreciated.

26th June, 1956.

EDUCATION DEPARTMENT

My reference G.78A/F.

B.

Mr. Riley,
Acting Divisional
Education Officer,
Settle.

Horton-in-Ribblesdale:
Helwith Bridge School.

MAY 1956

You will know that on Friday, the 18th May, Miss Worthington was offered the headship of Helwith Bridge J.M.I.School. She has since written to thank the Committee for their consideration but to ask them to accept her formal withdrawal.

At the interview, Mr.Thornber, one of the Representative Managers, drew attention to the fact that there were only eight children on roll and said that the Committee had already considered the advisability of closing the school. Now that Miss Worthington has withdrawn from the post of Head Teacher there is little chance of filling this headship satisfactorily; and in view of the fall in numbers and the fact that there is no settled community at Helwith Bridge, it might be advisable if the local Committee would consider closing this school.

It so happens that the Chairman of the Education Committee will be in the area with the Deputy Education Officer, Mr.Brown, on Monday, the 28th May, to discuss the scheme of divisional administration. Perhaps the local people would agree to take this opportunity of ~~settling~~ discussing this matter with the Chairman of the Education Committee on Monday afternoon.

25th May, 1956.

as. cases.
Settle D.S.C., 26/6/56.

closure / 4

to visit to meet

Parents

- Report L 66 j

WEST RIDING OF YORKSHIRE
COUNTY COUNCIL
EDUCATION DEPARTMENT

Your Reference

Our Reference

S.1000.4623.56651

24 MAR 1956

M.73/5.

EDUCATION DEPARTMENT
DIVISION 31.

The Acting Divisional
Education Officer
Settle

Horton-in-Ribblesdale Helwith Bridge School

At present consideration is being given to the appointment of a Headmistress at the above-named school.

It is noted that there were only 10 pupils on roll in January, 1956, and the Committee's Inspector is of the opinion that numbers will probably decrease.

I should be glad if you would let me have, as soon as possible, a forecast of numbers up to 1960.

A. B. Clegg

23rd March, 1956.

Mr. Clegg.

Horton-in-Ribblesdale Helwith Bridge School.

With reference to your minute of 23rd. March, 1956, regarding numbers on roll at the above-named school, the position has changed considerably during the past three weeks.

It is impossible to state whether present numbers will be maintained, increased or decreased, as the children are drawn mainly from a group of houses attached to the Helwith Bridge Quarry, and recent indications are, that families tend to move after a few months. Three houses are at present vacant and it is possible that more children will arrive.

The present forecast based on a census taken yesterday is as follows:-

<u>Number on roll.</u>	<u>At</u>
12	Today
13	Easter 1956
11	September 1956
12	January 1957
13	Easter 1957
9	September 1957
9	January 1958
10	Easter 1958
10	September 1958
11	January 1959
12	Easter 1959
14	September 1959
14	January 1960
15	Easter 1960
16	September 1960
16	January 1961
16	Easter 1961

27th March 1956

Copy sent to Miss Swainson.

Miss Durie

0-1 1-2 2-3 3-4 4-5 5-6 6-7 7-8 8-9 9-10 10-11

Jan	!!		!		!!!					
Easter	!	!	!	!		!!!		!!	!!!	!
Sept	!!!	!!	!!							

1956 March
1956 Easter

1956 Sept
1957 Jan
1957 Easter

Confidential

File

H Bridge

D. Matthew, B.Sc.

S/GMJ/JD
PWR/EC

15th February, 1957

Re Miss Jean Kay

Dear Sir,

In reply to your letter of the 5th instant, I have to say that Miss Kay is a permanent teacher in the West Riding and has taken charge at Helwith Bridge County Primary School since her school at Selside closed in July last. She has given very loyal and good service in two very isolated schools, and is capable of sustaining a high standard. Under this Authority she has had no experience of handling large classes or exercising supervision over assistant staff, but I would have no hesitation in recommending her as a conscientious, capable and hard working assistant.

Her Health record has been very satisfactory.

Yours faithfully,

G. Taylor, Esq., M.A.,
Chief Education Officer,
Calverley Street, Leeds. 1.

Divisional Education Officer

EDUCATION DEPARTMENT

S.1000.4622.5655k

Your Reference

Re reply accordingly

Our Reference

Mr. Matthews.

Miss Kay.

Miss Kay is a permanent teacher in the district and is
 has taking charge ~~temporarily~~ at Helmsley ^{W.F. School} since her School
 at Selkirk closed in July last. She has given very loyal
 and good service in two very isolated schools, and is
 capable of sustaining a high standard. Under this Authority
 she has had no experience of handling large classes or
 exercising supervision over assistant staff, but I would have
 no hesitation in recommending her as a conscientious,
 capable and hard working assistant.

J. Dennis
11/2/57.

COUNTY COUNCIL OF THE WEST RIDING OF YORKSHIRE

WITH THE COMPLIMENTS
OF THE
DIVISIONAL EDUCATION OFFICER

Miss. J. P. Jamrie, C.C.T.,
Would you kindly
comment and return Mr.
Taylor's letter to me.
D. Matthews

EDUCATION OFFICE

SECRET
SKIPTON.



GEORGE TAYLOR, M.A.
CHIEF EDUCATION OFFICER
TELEPHONE NO. 28091

EDUCATION DEPARTMENT
CALVERLEY STREET
LEEDS. 1



5th February, 1957.

Dear Sir,

Miss Jean Kay, who tells me that she is at present Temporary Headmistress at Helwith Bridge C.P. School, is an applicant for appointment to the Permanent Supply Staff in Leeds. These posts carry an allowance of £125. We are looking for experienced teachers who have done good work in their present posts and are now seeking a wider field. They should be able to deal with children of very different ages and ability.

I should be grateful if you could let me have a report on her work and let me know whether you can recommend her for appointment to the Permanent Supply Staff. It would also be helpful to know whether her health record has been satisfactory. *Yes.*

Yours faithfully,

George Taylor

Chief Education Officer.

The Divisional Education Officer,
Castle Hill,
SETTLE,
Yorks.

EDUCATION DEPARTMENT

Your reference

My reference S.78/A.

1 Mrs. Stott. Thank you.
2 Mrs. Riley.

Mr. D. Matthew.

Horton-in-Ribblesdale Helwith Bridge (J.M. & I) School.
Appointment of Head Teacher.

Country

Enc:

With reference to the appointment of a Head Teacher for the above-named school, five applications are enclosed.

You will remember that on the 18th May, 1956, three candidates were interviewed for the post of headship of this school and that Miss Mary Worthington was appointed, but subsequently withdrew. When the post was re-advertised Miss Worthington again applied for the job and I give below an extract from a letter dated the 12th March, 1957, received from Miss Worthington:-

"My family has moved within access of the district and I should be prepared now to accept the post with the intention of making no further change".

In order to avoid additional expense in having further interviews it is suggested that Miss Worthington be offered the post.

I shall be glad if you will kindly let me know whether the Managers and District Sub-Committee agree.

a. R. Olegg.

8th May, 1957.

*Mr. Matthews.
for information
then
Settle D.S.C. R.*

HS/BIM

29th May, 1957

Horton-in-Ribblesdale Holwith Bridge J.M. & I. School
Appointment of Head Teacher

Dear Madam,

I refer to your application for the above post and have pleasure in informing you that the Authority are prepared to offer you this post without further interview, as from the commencement of the Autumn Term, 1957.

I shall be glad to hear that you accept the post and that you will give notice to terminate your present engagement at the end of the current Summer term.

A further communication regarding salary and formal agreement of service will be addressed to you in the near future.

Yours faithfully,

Divisional Education Officer.

Miss M. Worthington,
2, Fulwood,
Preston,
Lancs.

S.78/A

HS/BIW

Horton-in-Ribblesdale Helwith Bridge J.M. & I School
Appointment of Head Teacher

The Chief
Education
Officer

I refer to your minute of the 8th instant and subsequent telephone conversation of today's date. The five applications received for the post of Head Teacher of the above-named School are returned herewith and I have to confirm that the Managers and District Sub-Committee agree that Miss Worthington may be appointed without further interview.

As suggested in the third paragraph of your letter, I have today written Miss Worthington offering her the post and attach hereto for your information a copy of my letter to her.

I shall be glad to have a salary assessment and confirmation of the appointment in due course.

29th May, 1957.

✓
✓
2. Queens Road,
Fulwood,
Preston,
Lancs.

WEST RIDING
EDUCATION COMMITTEE
31 MAY 1957
DIVISIONS 1 & 31

30. 5. 57

The Divisional Education Officers,

Dear Sir,

Thank you for the notice
of my appointment to the
Horton nr. Ribblesdale, Helwith Edge
School, which I gladly accept.

I have to-day tendered
my resignation to my
School managers, & shall be
able to take up duty at the
beginning of the Autumn Term.

Yours faithfully,
Mary Worthington

COUNTY SUPPLIES DEPARTMENT

4734
TELEPHONE 378T
Ext. 15

F. 15004
PLEASE QUOTE THIS No.

DEPARTMENTAL ESTIMATE

CLIFF LANE, WAKEFIELD

To Mr. D. Matthew
Personal Education Officer 17th April 1958

In response to your inquiry dated 30/12/57 Ref. PWR/PS
I submit the following estimate of cost:—

Description of Goods	Rate	Estimated Cost		
		£	s.	d.
<p><u>Helwith Bridge County Primary School</u> <u>Piano - Hillon No. 21210.</u> Thorough overhaul of action, Keys & Casework required including hammers facing & recentering, Keys recovering and bushing, regluing key bed, toe blocks, new tapes, springs, leathers, felt, backing, castors, pedal felt, repolishing, tuning & regulating.</p>		28	10	0

Requisition to
CO of Supplies
9/12/57
transferred when
moved to
Wakefield

Note. A separate report will be submitted re piano offered for sale by Mrs Graham. (Settle)

PLEASE NOTE—

- (1) This estimate is given subject to the County Supplies Committee being able, at the time of supply, to obtain the goods at the prices quoted.
- (2) If the goods which are the subject of this estimate are requisitioned the reference number of the Estimate should be quoted on the requisition. If the expenditure authorised is specifically limited to the amount of this estimate, the limiting figure should also be stated on the requisition.

A. R. Calver
R.E.L.

Chief Officer of Supplies

PWR/JS.

Helwith Bridge County Primary School.
Piano.

The Chief
Officer of
Supplies.

I should be obliged if you would let me have
an early reply to my minute of the 30th December,
1957.

17th April, 1958.

Divisional Education Officer.

PWR/JS.

Helwith Bridge County Primary School.
Piano.

The Chief
Officer of
Supplies.

I should be obliged if you would let me
have an early reply to my minute of the 30th
December, 1957.

*Reminder please
+ B/F. copy. 25*

10th February, 1958.

Divisional Education Officer.

PWR/JS.

Helwith Bridge County Primary School.
Piano.

The Chief
Officer of
Supplies.

The Head Teacher of the above-named School informs me that the piano is in poor condition and very unsatisfactory.

I am informed that there is a good piano for sale at 7, Prospect Terrace, Settle and that the owner, a Mrs. Graham, wishes this school to benefit.

Would you please arrange to

- (a) let me have a report on the condition of the existing school piano together with an estimate of the cost of overhaul and repairs necessary.
- (b) let me have a report on the condition of the piano offered for sale at Settle together with details of (1) price requested (2) your valuation of the piano.

It would be helpful if this matter could receive urgent attention.

*Reminder
please*

30th December, 1957. Divisional Education Officer.



COUNTY COUNCIL OF THE WEST RIDING OF YORKSHIRE
EDUCATION DEPARTMENT

Mr. Riley:
If we have
money for this school
we will use it to supply
the inspector!



Helwilt Bridge

10-12-57

Dear Sir

In answer to your
letter of the 10th, the
piano in this school is
very unsatisfactory.

Yours faithfully

M. Worthington

Mr. Matthew.

Please see correspondence.

Prof.



Faint, illegible text at the top of the page, possibly a header or title.

Main body of faint, illegible text, possibly a paragraph or list of items.

Faint, illegible text at the bottom of the page, possibly a footer or signature.